

# Lodestar electric chain hoist

INTRODUCING THE NEXT GENERATION OF  
LODESTAR WITH CAPACITIES OF UP TO 3 TONS.

## STANDARD FEATURES

**CAPACITIES: 1/8 TO 3 TONS**

**FABRIC CHAIN CONTAINER  
& RIGID HOOK SUSPENSION**  
Standard on every Lodestar

**LIFETIME WARRANTY**  
The industry's best warranty against  
manufacturing and material defects.

**METRIC RATED**

**CSA/US**  
National Recognized  
Testing Laboratory (NRTL)

**MADE IN THE USA**



## SPECIFICATIONS

	Capacity (tons)	Product Code		Model	Hoist Lifting Speed (FPM)	Motor HP	Reeving	Weight (lbs.)	
		**Rigid Hook Suspension & Chain Container						115-1-60	230/460 3-60
		115-1-60	230/460 3-60						
Single Speed 10' Lift	1/8	2702NH	2705NH	A	32.0	1/4	1	54	60
	1/8	2712NH	2715NH	AA	60.0	1/2	1	67	64
	1/4	2722NH	2725NH	B	16.0	1/4	1	53	61
	1/4	2732NH	2735NH	C	32.0	1/2	1	61	64
	1/2	2742NH	2745NH	E	8.0	1/4	2	71	69
	1/2	2752NH	2755NH	F	16.0	1/2	1	61	65
	1/2	3512NH	3515NH	J	32.0	1	1	110	110
	1/2	-	3545NH	JJ	64.0	2	1	—	117
	1	2762NH	2765NH	H	8.0	1/2	2	72	73
	1	3522NH	3525NH	L	16.0	1	1	113	110
	1	-	3555NH	LL	32.0	2	1	—	117
	2	3532NH	3535NH	R	8.0	1	2	131	130
	2	-	3565NH	RR	16.0	2	2	—	135
3	9501NH	9505NH	RT	5.5	1	3	158	158	
3	-	9508NH	RRT	11.0	2	3	—	162	
Single Speed 15' Lift	1/8	3101NH	3103NH	A	32.0	1/4	1	59	64
	1/8	3111NH	3113NH	AA	60.0	1/2	1	67	79
	1/4	3121NH	3123NH	B	16.0	1/4	1	61	64
	1/4	3131NH	3133NH	C	32.0	1/2	1	66	75
	1/2	3141NH	3143NH	E	8.0	1/4	2	70	80
	1/2	3151NH	3153NH	F	16.0	1/2	1	67	72
	1/2	4212NH	4214NH	J	32.0	1	1	118	115
	1/2	-	4244NH	JJ	64.0	2	1	—	123
	1	3161NH	3163NH	H	8.0	1/2	2	80	85
	1	4222NH	4224NH	L	16.0	1	1	120	114
	1	-	4254NH	LL	32.0	2	1	—	122
	2	4232NH	4234NH	R	8.0	1	2	140	138
	2	-	4264NH	RR	16.0	2	2	—	144
3	9502NH	9506NH	RT	5.5	1	3	174	171	
3	-	9509NH	RRT	11.0	2	3	—	176	
Single Speed 20' Lift	1/8	3102NH	3104NH	A	32.0	1/4	1	64	68
	1/8	3112NH	3114NH	AA	60.0	1/2	1	72	74
	1/4	3122NH	3124NH	B	16.0	1/4	1	64	72
	1/4	3132NH	3134NH	C	32.0	1/2	1	69	76
	1/2	3142NH	3144NH	E	8.0	1/4	2	80	88
	1/2	3152NH	3154NH	F	16.0	1/2	1	71	76
	1/2	4213NH	4215NH	J	32.0	1	1	124	124
	1/2	-	4245NH	JJ	64.0	2	1	—	128
	1	3162NH	3164NH	H	8.0	1/2	2	86	90
	1	4223NH	4225NH	L	16.0	1	1	124	119
	1	-	4255NH	LL	32.0	2	1	—	127
	2	4233NH	4235NH	R	8.0	1	2	148	148
	2	-	4265NH	RR	16.0	2	2	—	156
3	9503NH	9507NH	RT	5.5	1	3	187	184	
3	-	9510NH	RRT	11.0	2	3	—	194	

Fabric Chain Containers included on all models for up to 20 ft. Lift

\*Hoist only without suspension & chain container must be ordered through the configurator.

\*\*Rigid hook suspension & fabric chain container are standard with hoist codes listed above.

When ordering, specify code number(s), model, capacity, beam size, power supply, suspension, lift, extra control cord or power cord, (if required) and type of electrification (if required).

**CSA APPROVED†**

† Hook Suspension models only.

## OPTIONAL FEATURES

### DOUBLE DC BRAKE

Two independent acting DC Brakes for redundant braking. Field Installation Kit available.

### AC ELECTRIC BRAKE

### VARIABLE SPEED DRIVE (VFD) OR TRADITIONAL 2 SPEEDS AVAILABLE

### PRIMARY & SECONDARY TRANSFORMER FUSING

### ROTATABLE LIMIT SWITCH

Designed for quick reset of limit position

### BLACK PHOSPHATE OR STAINLESS STEEL LOAD CHAIN

### METAL & STAINLESS STEEL CHAIN CONTAINERS

# Lodestar electric chain hoist - Specifications

## SPECIFICATIONS

	Capacity (tons)	Product Code		Model	Hoist Lifting Speed (FPM)	Motor HP	Reeving	Weight (lbs.)	
		**Rigid Hook Suspension & Chain Container						230-3-60	460-3-60
		230-3-60	460-3-60						
Two Speed 10' Lift	1/8	2707NH	2708NH	A2	10/32	1/4	1	67	73
	1/8	2717NH	2718NH	AA2	20/60	1/2	1	74	75
	1/4	2727NH	2728NH	B2	5/16	1/4	1	67	73
	1/4	2737NH	2738NH	C2	10/32	1/2	1	73	74
	1/2	2747NH	2748NH	E2	2.5/8	1/4	2	76	82
	1/2	2757NH	2758NH	F2	5/16	1/2	1	74	74
	1/2	3502NH	3503NH	J2	10/32	1	1	116	117
	1/2	3549NH	3550NH	JJ2	21/64	2	1	130	130
	1	2767NH	2768NH	H2	2.5/8	1/2	2	83	84
	1	3504NH	3505NH	L2	5/16	1	1	116	117
	1	3553NH	3554NH	LL2	10/32	2	1	130	131
	2	3506NH	3507NH	R2	2.5/8	1	2	134	135
	2	3561NH	3562NH	RR2	5/16	2	2	149	149
	3	9511NH	9513NH	RT2	1.75/5.5	1	3	161	176
	3	9512NH	9514NH	RRT2	3.5/11	2	3	176	174
Variable Frequency Drive	1/8***	2709NH	2710NH	A	32.0	1/4	1	65	65
	1/4***	2726NH	2729NH	B	16.0	1/4	1	65	65
	1/4***	2734NH	2736NH	C	32.0	1/2	1	65	65
3 - Step Infinitely Variable Control	1/2***	2730NH	2731NH	F	16.0	1/2	1	65	65
	1/2***	3635NH	3636NH	J	32.0	1	1	110	110
	1/2***	3642NH	3643NH	JJ	64.0	2	1	110	110
	1***	3625NH	3626NH	L	16.0	1	1	110	110
	1***	3644NH	3645NH	LL	32.0	2	1	110	110
6 to 1 Speed Ratio	2***	3632NH	3633NH	R	8.0	1	2	110	110
	2***	3646NH	3647NH	RR	16.0	2	2	110	110
10' Lift	3***	9531NH	9534NH	RT	5.5	1	2	110	110
	3***	9539NH	9540NH	RRT	11.0	2	2	110	110

Fabric Chain Containers included on all models for up to 20 ft. Lift

\*\* Rigid hook suspension & fabric chain container are standard with hoist codes listed above.

\*\*\* Not CSA Approved.

Control Cord drop is 4 ft. less than Lift.

VFD units are factory set for 3-Step Infinitely Variable Control and include 3-Step Control Station and 115V interface card as standard.

**CSA APPROVED†**

† Hook Suspension models only.

### Less maintenance & easier inspection

- Heavy Duty DC Brake is designed for a long service life. Brake location allows for quick access and easy inspection.
- Lifetime grease-lubricated Gear Box means no oil change out is required. Precision gears provide better wear and longer life.
- Clutch located outside the Gear Box allows for easy access which eliminates the need for complete disassembly and reduces downtime.

### Improved serviceability

- Easy access to the Clutch, Motor, Electrical Control Panel and Brake Assembly.

### Longer service life

Lifetime grease-lubricated Gear Box and helical gearing ensures efficient operation. Heavy duty rated motors. Hoist workmanship backed by a lifetime warranty.

### Quieter operation

80% reduction in sound pressure as compared to the classic Lodestar.

## HOIST SUSPENSIONS

	Product Code	Models	Weight (lbs.)
Rigid Hook**	2788NH	A-AA-B-C-F	2
	2789NH	E-H	4
	3651NH	J-L-JJ-LL	4
	3658NH	R-RR	8
	9559NH	RT-RRT	7
Rigid Latchlok Hook	2790NH	A-AA-B-C-F	3
	3652NH	J-L-JJ-LL	5
Swivel Hook	2792NH	A-AA-B-C-F	2
	2793NH	E-H	4
	3661NH	J-L-JJ-LL	4
	3660NH	R-RR	8
	9557NH	RT-RRT	7
Swivel Latchlok Hook	2796NH	A-AA-B-C-F	3
	3662NH	J-L-JJ-LL	5
	3663NH	R-RR	9
Rigid Lug for Low Headroom Trolley	2778NH	A-AA-B-C-F	2
	2779NH	E-H	3
	3677NH	J-L-JJ-LL	4
	3668NH	R-RR	6
	9561NH	RT-RRT	5
Rigid Lug for Motor Driven Trolley	2992NH	A-AA-B-C-F	2
	2993NH	E-H	3
	3679NH	J-L-JJ-LL	4
	3668NH	R-RR	6
	9561NH	RT-RRT	5



### Improved load safety

Clutch is located outside the load path which prevents slipping of the load in an overload condition when brake is not powered.

### Improved chain life

5 Pocket Lift Wheel provides better chain and lift wheel engagement for smoother lifting and reduced vibration — which equates to less wear and a longer chain life. Zinc plating to protect chain from environmental conditions.

### Easy access control panel

With finger-safe wiring and plug and play connectors, the Control Panel allows for quick voltage change, access to terminal strips and simple fuse installation.

### Exceeds H4 requirements

Lodestar exceeds H4 requirements, engineered for high duty cycles and the toughest applications.

### Eco-friendly

Lifetime grease-lubricated Gear Box means no changing and disposing of hazardous oil. Documented RoHS compliance. Shipped in boxes made of recycled material.

# Lodestar electric chain hoist (2-ton, single-reeved)

THE CM® LODESTAR® IS NOW AVAILABLE AS AN ECONOMICAL 2-TON, SINGLE-REEVED UNIT THAT'S IDEAL FOR A VARIETY OF INDUSTRIAL LIFTING APPLICATIONS. AND, BECAUSE IT'S A SINGLE REEVED UNIT, THE DESIGN PREVENTS THE LOWER HOOK BLOCK FROM CAPSIZING AND DAMAGING THE HOIST.

## STANDARD FEATURES

### LESS MAINTENANCE & EASIER INSPECTION

- Brake location allows for quick access and easy inspection.
- Lifetime grease-lubricated Gear Box means no oil change is required.
- Clutch located outside the Gear Box allows for easy access which eliminates the need for complete disassembly and reduces downtime.

### IMPROVED SERVICEABILITY

Easy access to the Clutch, Motor, Electrical Control Panel and Brake Assembly.

### LONGER SERVICE LIFE

- Heavy-duty DC brake is designed for a long service life.
- Lifetime grease-lubricated Gear Box and helical gearing ensures better wear and smooth operation.
- Heavy-duty rated motors.

### IMPROVED LOAD SAFETY

Clutch is located outside the load path preventing slipping of the load in an overload condition when the brake is not powered.

### IMPROVED CHAIN LIFE

5-Pocket Lift Wheel provides better chain and lift wheel engagement for smoother lifting and reduced vibration equating to less wear and a longer chain life. Zinc plating protects chain from environmental conditions.

## OPTIONAL FEATURES

### DOUBLE DC BRAKE

Two independent acting DC Brakes for redundant braking. Field installation kit available.

### VARIABLE SPEED DRIVE (VFD)

### PRIMARY & SECONDARY TRANSFORMER FUSING

### ROTATABLE LIMIT SWITCH

Designed for quick reset of limit position.

### METAL CHAIN CONTAINERS

### EASY ACCESS CONTROL PANEL

Finger-safe wiring and plug-and-play connectors on the Control Panel allow for quick voltage change, easy access to terminal strips and simple fuse installation.

### ZINC PLATED LOAD CHAIN

Designed and manufactured in the USA by Columbus McKinnon. 10 millimeter, zinc plated Star Grade load chain protects against corrosion.

### ADJUSTABLE LIMIT SWITCH

Easy-to-adjust screw limit switch automatically stops the hook at any predetermined point when either lifting or lowering, preventing overtravel.

### OVERLOAD PROTECTOR

Helps prevent lifting of dangerous overloads.

### METRIC RATED

### LIFETIME WARRANTY

The industry's best warranty against manufacturing and material defects.

### FABRIC CHAIN CONTAINER

Standard up to 20 ft lift.

### RIGID HOOK SUSPENSION



# Lodestar electric chain hoist (2-ton, single-reeved) - Specifications

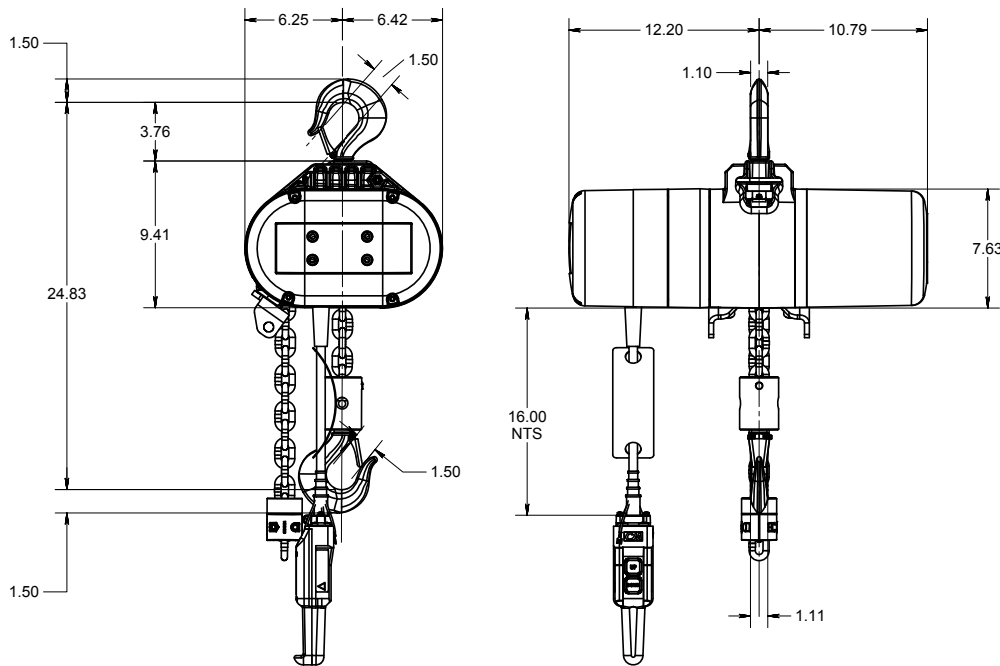

Dimensions (in inches) are RRS model CM Lodestar 2 Ton Single Reeved with Swivel Latch Type Hook Suspension.

For a complete list of dimensions for a specific model type/configuration, visit [www.cmworks.com/Library/](http://www.cmworks.com/Library/)

## SPECIFICATIONS

	Capacity (tons)	Voltage	Product Code**	Model	Hoist Lifting Speed (FPM)	Motor HP	Reeving	Weight (lbs.)
			**Rigid Hook Suspension & Chain Container					
Single Speed Less Chain	2 Ton	230/460-3-60	3565S1LC	RRS	16	2	1	141
Single Speed 10' Lift	2 Ton	230/460-3-60	3565S1	RRS	16	2	1	156
	2 Ton	575-3-60	9280S1	RRS	16	2	1	156
Single Speed 15' Lift	2 Ton	230/460-3-60	4264S1	RRS	16	2	1	164
Single Speed 20' Lift	2 Ton	230/460-3-60	4265S1	RRS	16	2	1	172
Variable Frequency Drive 10' Lift	2 Ton	230-3-60	3646S1	RRS	16	2	1	161
	2 Ton	460-3-60	3647S1	RRS	16	2	1	162

Fabric Chain Containers included on all models for up to 20 ft. Lift

\*Hoist only without suspension & chain container must be ordered through the configurator.

\*\*Rigid hook suspension & fabric chain container are standard with hoist codes listed above.

When ordering, specify code number(s), model, capacity, beam size, power supply, suspension, lift, extra control cord or power cord, (if required) and type of electrification (if required).

## STAR GRADE LOAD CHAIN, BULK CHAIN

Product Code	Size	Finish	Feet per Drum
85960EN250	10 mm	Zinc Plated	250
85960EN500			500
85960EN1000			1000

## CHAIN CONTAINERS

Fabric Chain Containers included on all New Lodestar models up to 20 ft. Lift

Product Code	+ Bucket Length (in.)	Weight (lbs.)	Maximum Length of Lift (ft.)
<b>CANVAS</b>			
10001562	10	4.0	20
10001568	13	4.1	30
10001569	16	4.2	40
10001570	18	4.3	50
10001571	20	4.4	60
<b>METAL</b>			
10001563	10	12.4	30
10001564	15	15.7	55
10001565	20	19.0	80
10001566	25	22.4	105
10001567	30	25.7	130

## HOIST SUSPENSIONS

Type	Product Code	Use for Models	Weight (lbs.)
Swivel Hook	10001574	RRS	5.4
	10001573	RRS	5.6
Rigid Hook**	10001573X (cross mount)	RRS	5.6
	10001577	RRS	3.6
Rigid Lug	10001577X (cross mount)	RRS	3.6
	10001575	RRS	5.2
Rigid Latchlok Hook	10001575X (cross mount)	RRS	5.2
	10001576	RRS	5.0
Swivel Latchlok Hook	10001578	RRS	-
Universal Trolley Lug	10001578X (cross mount)	RRS	-

## CSA APPROVED

Single speed hook suspended models are CSA Approved as standard. For trolley-mounted models, please contact your CMCO representative.



# Classic Lodestar electric chain hoist

The balanced, integrated, proven design of the Lodestar has made it the most popular electric chain hoist in the industry. Lodestar gives you more value for your money including:

- Quick change voltage board-change from low voltage to high voltage by simply re-positioning receptacle
- Up to 3 ton capacities for heavy-duty industrial applications
- Gear train lifetime lubricated with non-oxidizing grease
- Precision machined and hardened lift-wheel with hardened chain guides for precise chain liftwheel fit
- Gearing designed for exceptionally long life and quiet operation
- H4 duty standard
- Rugged control station (NEMA 4X)
- Hoist duty motor, standard Protector overload device and standard adjustable screw type limit switches
- Hardened, forged steel, latch type hooks and Hoistaloy load chain for long, dependable service
- Zinc plated load chain standard
- Easy to install and maintain
- No special tools required to disassemble
- Lifetime warranty
- Each hoist thoroughly inspected and tested to over 125% of rated load prior to shipment
- Meets ASME B30.16
- Metric rated
- Made in U.S.A.



## Special applications

- Harsh environment hoists available for severe duty of plating, galvanizing and washdown applications
- Hoists with climbing capability available for temporary rigging or lifting applications — must be used in inverted position only
- Hoists with creep control allow precise positioning through field adjustment within the time delay range of .05 sec. to 3 sec.
- Articulating suspension 3 ton only



SEE PAGE 88 FOR MORE INFO

## Specifications — two speed

Rated capacity* (tons)	Standard lift (ft.)	Lift speed (F.P.M.)	Motor H.P.	Model	Reeving	Product code† less suspension		Approximate shipping weight (lbs.)
						230-3-60	460-3-60	
1/8	10	10/32	1/4	A2	1	2707	2708	70
	10	20/60	1/2	AA2	1	2717	2718	74
1/4	10	5/16	1/4	B2	1	2727	2728	70
	10	10/32	1/2	C2	1	2737	2738	74
1/2	10	2.5/8	1/4	E2	2	2747	2748	79
	10	5/16	1/2	F2	1	2757	2758	74
	10	10/32	1	J2	1	3502	3503	116
	10	21/64	2	JJ2	1	3549	3550	130
1	10	2.5/8	1/2	H2	2	2767	2768	83
	10	5/16	1	L2	1	3504	3505	116
	10	10/32	2	LL2	1	3553	3554	130
2	10	2.5/8	1	R2	2	3506	3507	136
	10	5/16	2	RR2	2	3561	3562	150
3	10	1.75/5.5	1	RT2	3	9511	9513	161
	10	3.5/11	2	RRT2	3	9512	9514	175

†Specify voltage 230 or 460

## Classic Lodestar electric chain hoist - Specifications

### Specifications — single speed

Rated capacity* (tons)	Standard lift (ft.)	Lift speed (F.P.M.)	Motor H.P.	Model	Reeving	Product code† less suspension		Approximate shipping weight (lbs.)
						115-1-60	230/460-3-60	
1/8	10	32	1/4	A	1	2702	2705	60
	10	60	1/2	AA	1	2712	2715	66
	15	32	1/4	A	1	3101	3103	64
	15	60	1/2	AA	1	3111	3113	70
	20	32	1/4	A	1	3102	3104	68
	20	60	1/2	AA	1	3112	3114	74
1/4	10	16	1/4	B	1	2722	2725	60
	10	32	1/2	C	1	2732	2735	66
	15	16	1/4	B	1	3121	3123	64
	15	32	1/2	C	1	3131	3133	70
	20	16	1/4	B	1	3122	3124	68
	20	32	1/2	C	1	3132	3134	74
1/2	10	8	1/4	E	2	2742	2745	69
	10	16	1/2	F	1	2752	2755	66
	10	32	1	J	1	3512	3515	110
	10	64	2	JJ	1	—	3545	117
	15	8	1/4	E	2	3141	3143	76
	15	16	1/2	F	1	3151	3153	70
	15	32	1	J	1	4212	4214	116
	15	64	2	JJ	1	—	4244	123
	20	8	1/4	E	2	3142	3144	83
	20	16	1/2	F	1	3152	3154	74
	20	32	1	J	1	4213	4215	121
	20	64	2	JJ	1	—	4245	128
1	10	8	1/2	H	2	2762	2765	75
	10	16	1	L	1	3522	3525	110
	10	32	2	LL	1	—	3555	117
	15	8	1/2	H	2	3161	3163	82
	15	16	1	L	1	4222	4224	116
	15	32	2	LL	1	—	4254	123
	20	8	1/2	H	2	3162	3164	89
	20	16	1	L	1	4223	4225	121
	20	32	2	LL	1	—	4255	128
2	10	8	1	R	2	3532	3535	130
	10	16	2	RR	2	—	3565	137
	15	8	1	R	2	4232	4234	140
	15	16	2	RR	2	—	4264	147
	20	8	1	R	2	4233	4235	150
	20	16	2	RR	2	—	4265	157
3	10	5.5	1	RT	3	9501	9505	155
	10	11	2	RRT	3	—	9508	162
	15	5.5	1	RT	3	9502	9506	169
	15	11	2	RRT	3	—	9509	176
	20	5.5	1	RT	3	9503	9507	183
	20	11	2	RRT	3	—	9510	190

†Single speed hoist factory wired 460V, convertible to 230V.

# Classic Lodestar with hook suspension

## Clearance dimensions (in.)

Dimension	Lodestar models					
	A,B,C,F and AA	E and H	J, L, JJ and LL	R	RR	RT and RRT
A	16 <sup>1</sup> / <sub>4</sub>	19 <sup>5</sup> / <sub>8</sub>	18 <sup>9</sup> / <sub>16</sub>	24 <sup>1</sup> / <sub>8</sub>	24 <sup>1</sup> / <sub>8</sub>	29 <sup>9</sup> / <sub>16</sub>
B	6 <sup>1</sup> / <sub>8</sub>	6 <sup>1</sup> / <sub>8</sub>	7 <sup>5</sup> / <sub>8</sub>	7 <sup>5</sup> / <sub>8</sub>	7 <sup>5</sup> / <sub>8</sub>	7 <sup>5</sup> / <sub>8</sub>
C	1 <sup>1</sup> / <sub>16</sub>	7 <sup>7</sup> / <sub>8</sub>	7 <sup>7</sup> / <sub>8</sub>	1 <sup>1</sup> / <sub>8</sub>	1 <sup>1</sup> / <sub>8</sub>	1 <sup>1</sup> / <sub>8</sub>
D	11	11	9 <sup>1</sup> / <sub>2</sub>	9 <sup>1</sup> / <sub>2</sub>	9 <sup>1</sup> / <sub>2</sub>	9 <sup>1</sup> / <sub>2</sub>
F	7 <sup>3</sup> / <sub>4</sub>	7 <sup>3</sup> / <sub>4</sub>	10 <sup>11</sup> / <sub>16</sub>	10 <sup>11</sup> / <sub>16</sub>	10 <sup>11</sup> / <sub>16</sub>	10 <sup>11</sup> / <sub>16</sub>
H	1	1 <sup>3</sup> / <sub>16</sub>	1 <sup>3</sup> / <sub>16</sub>	1 <sup>1</sup> / <sub>2</sub>	1 <sup>1</sup> / <sub>2</sub>	1 <sup>1</sup> / <sub>2</sub>
I	4 <sup>13</sup> / <sub>16</sub>	3 <sup>7</sup> / <sub>8</sub>	7 <sup>1</sup> / <sub>4</sub>	6 <sup>3</sup> / <sub>16</sub>	6 <sup>3</sup> / <sub>16</sub>	6 <sup>3</sup> / <sub>16</sub>
J	3 <sup>15</sup> / <sub>16</sub>	4 <sup>7</sup> / <sub>8</sub>	5 <sup>7</sup> / <sub>16</sub>	6 <sup>1</sup> / <sub>2</sub>	6 <sup>1</sup> / <sub>2</sub>	6 <sup>1</sup> / <sub>2</sub>
L	1 <sup>11</sup> / <sub>16</sub>	1 <sup>11</sup> / <sub>16</sub>	7 <sup>7</sup> / <sub>16</sub>	7 <sup>7</sup> / <sub>16</sub>	7 <sup>7</sup> / <sub>16</sub>	7 <sup>7</sup> / <sub>16</sub>
M	1	1 <sup>1</sup> / <sub>8</sub>	1 <sup>1</sup> / <sub>8</sub>	1 <sup>5</sup> / <sub>16</sub>	1 <sup>5</sup> / <sub>16</sub>	1 <sup>5</sup> / <sub>16</sub>
P	6 <sup>5</sup> / <sub>8</sub>	6 <sup>9</sup> / <sub>16</sub>	7 <sup>13</sup> / <sub>16</sub>	7 <sup>13</sup> / <sub>16</sub>	7 <sup>13</sup> / <sub>16</sub>	7 <sup>13</sup> / <sub>16</sub>
R*	9 <sup>7</sup> / <sub>8</sub>	12 <sup>7</sup> / <sub>8</sub>	12 <sup>7</sup> / <sub>8</sub>	18 <sup>7</sup> / <sub>8</sub>	18 <sup>7</sup> / <sub>8</sub>	24 <sup>7</sup> / <sub>8</sub>
AP	9 <sup>1</sup> / <sub>4</sub>	9 <sup>9</sup> / <sub>16</sub>	10 <sup>11</sup> / <sub>16</sub>	11 <sup>3</sup> / <sub>16</sub>	11 <sup>3</sup> / <sub>16</sub>	12 <sup>9</sup> / <sub>16</sub>

\* Based on 10 ft. lift and increases proportionately with longer lifts



## Suspension specifications

Type	Product code	Models
Swivel hook	2792	A-AA-B-C-F
Swivel hook	2793	E-H
Swivel hook	3661	J-L-JJ-LL
Swivel hook	3660	R-RR
Swivel hook	9557	RT-RRT
Swivel latchlok hook	2796	A-AA-B-C-F
Swivel latchlok hook	3662	J-L-JJ-LL
Swivel latchlok hook	3663	R-RR
Rigid lug for low head trolley	2778	A-AA-B-C-F
Rigid lug for low head trolley	2779	E-H
Rigid lug for low head trolley	3677	J-L-JJ-LL
Rigid lug for low head trolley	3668	R-RR
Rigid lug for low head trolley	9561	RT-RRT
Rigid hook	2788	A-AA-B-C-F
Rigid hook	2789	E-H
Rigid hook	3651	J-L-JJ-LL
Rigid hook	3658	R-RR
Rigid hook	9559	RT-RRT
Rigid latchlok hook	2790	A-AA-B-C-F
Rigid latchlok hook	3652	J-L-JJ-LL

Note: 3 ton lug suspension prevents hoist from rotating but allows hoist to articulate below trolley

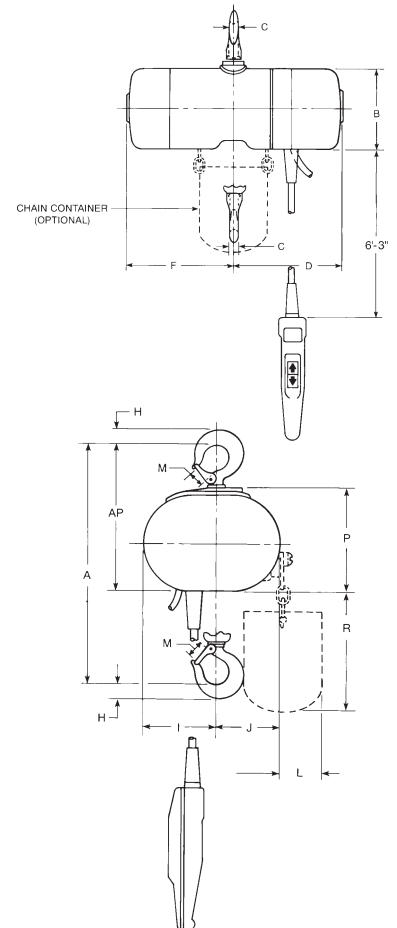

### \* **WARNING**

**Overloading and improper use can result in injury.**

#### To avoid injury:

- Do not exceed working load limit, load rating capacity
- Do not use to lift people or loads over people.
- use only alloy chain for overhead lifting.
- Read and follow all instructions.

# Lodestar XL electric chain hoist

Columbus McKinnon offers the Lodestar XL electric chain hoists for lifting applications from 2 to 7½ tons. The heavy-duty hoist features faster speeds, less reeving, and higher capacities than traditional chain hoists. Workers in automotive plants, heavy equipment manufacturing, paper mills, and related rugged work environments will experience the same dependability and versatility that they have relied on for many years.

## The NEW features of the Lodestar XL Electric Chain Hoist include:

- Lifting capacities up to 7½ tons
- Increased lifting speeds throughout the line
- Double reeved units with 3-5 ton lifting capacities
- Maximum lifting speed of 30 feet per minute



## A glimpse of the many features of the Lodestar XL that have honed its reputation for durability and long life:

- Heavy-duty, multiple disc braking system
- Forged ten-pocket oblique-lay liftwheel for smooth chain operation, constant chain speed, and reduced chain wear
- Gearing operated in oil bath for increased lifting life and quiet operation
- Rated H-4, heavy-duty
- Standard overload protector
- Adjustable screw-type limit switches
- Thermally protected motor
- Factory tested at 125% of rated capacity
- Made in U.S.A.
- Lifetime warranty



Capacity (tons)	Reeving	Speed (fpm)	230/460-3-60				575-3-60			
			Hook	Plain Trolley	Geared Trolley	Motor Driven Trolley	Hook	Plain Trolley	Geared Trolley	Motor Driven Trolley
2	1	18	5201H	5201P	5201G	5201M	5231H	5231P	5231G	5231M
2	1	24	5204H	5204P	5204G	5204M	5232H	5232P	5232G	5232M
2	1	30	5265H	5265P	5265G	5265M	5266H	5266P	5266G	5266M
3	2	9	5209H	5209P	5209G	5209M	5233H	5233P	5233G	5233M
3	2	12	5212H	5212P	5212G	5212M	5234H	5234P	5234G	5234M
3	2	15	5267H	5267P	5267G	5267M	5268H	5268P	5268G	5268M
4	2	9	5215H	5215P	5215G	5215M	5235H	5235P	5235G	5235M
4	2	12	5218H	5218P	5218G	5218M	5236H	5236P	5236G	5236M
4	2	15	5269H	5269P	5269G	5269M	5278H	5278P	5278G	5278M
5	3	6	5221H	5221P	5221G	5221M	5237H	5237P	5237G	5237M
5	3	8	5224H	5224P	5224G	5224M	5238H	5238P	5238G	5238M
5	2	9	5279H	5279P	5279G	5279M	5280H	5280P	5280G	5280M
5	2	12	5283H	5283P	5283G	5283M	5284H	5284P	5284G	5284M
5	2	15	5285H	5285P	5285G	5285M	5286H	5286P	5286G	5286M
6	3	6	5227H	5227P	5227G	5227M	5239H	5239P	5239G	5239M
6	3	8	5230H	5230P	5230G	5230M	5240H	5240P	5240G	5240M
6	3	10	5287H	5287P	5287G	5287M	5288H	5288P	5288G	5288M
7½	3	6	—	5289P	5289G	5289M	—	5290P	5290G	5290M
7½	3	10	—	5291P	5291G	5291M	—	5292P	5292G	5292M

3.5 H.P. XL Models (unshaded) – Available in single speed, 3:1; two speed, variable speed

5.5 H.P. XL Models (shaded) – Available in single speed, variable speed



# Man Guard electric chain hoist

## INTRODUCING THE CM MAN GUARD WITH CAPACITIES OF UP TO 3 TONS.

Columbus McKinnon Corporation, an industry leader in quality lifting and positioning equipment for hoist operators around the globe, presents CM Man Guard.

CM Man Guard electric chain hoist stays true to its name by providing operator safety through superior overload protection. The Man Guard hoist's overload clutch prevents lifting loads beyond capacity which may result in serious injury to the operator, or catastrophic damage to the hoist, load and supporting structure.

Made in the USA, Man Guard is designed for a long and dependable service life for heavy duty applications. Additionally, with its environmentally friendly design, easy access to key components, less maintenance, and enhanced safety feature, the Man Guard is the right choice for your lifting needs.

CM Man Guard is available as an individual unit or as an integral component of a complete lifting system.



**Capacities:** 1/4 to 3 Tons

**Standard Lift:** 10 feet  
Additional lifts available

**Lifting Speed:** 5 to 32 FPM

**Hook Suspension**

**AC Power Supply**

115/230 1-60 HZ; 230/460 3-60  
reconnectable voltage

**Built-In Compliance**

with ASME/ANSI B30.16, ASME  
HST-1 and NEC electrical codes

**Made in the U.S.A.**

## OVERLOAD PROTECTION

The CM Man Guard overload clutch prevents lifting beyond load capacity, which may damage the hoist or supporting structure or cause injury to the operator.

## READY FOR HEAVY DUTY APPLICATIONS

H4 duty motor classification rated for heavy duty use.

## LONGER SERVICE LIFE

- Class F insulation and thermal switch in motor winding reduces motor overheating and increase life.
- Helical Gears are oil bath lubricated which provides better wear and extends gear life while reducing noise.
- Powder coat painted housing and corrosion resistance zinc plated chain provides superior protection against the elements.
- Hard-wired power and pendant cords reduces risk of corrosion and loose connections.

## IMPROVED SERVICEABILITY

- Open design allows quick access to AC Brake's one step adjustment.
- Easy access to Control Panel and simple wiring change to switch voltages from 115 to 230V for single phase applications.

## SUPERIOR LOAD CONTROL

Optional Variable Frequency Drive (VFD) with 3 Step infinitely variable pendant allows operator to adjust lifting speeds without interruption. Many competitors only offer a 2 Step pendant requiring service interruption to change lift speeds.

## ECO-FRIENDLY ENERGY SAVER

Efficiently designed gear train allows a smaller horsepower motor to operate at the same speeds and duty as our competition and reduces energy consumption. Shipped in boxes made of recycled material.

## LIFETIME WARRANTY

## HOISTS SHIP IN 3 DAYS OR LESS – GUARANTEED

Select models are eligible for our In-Stock Guarantee.



# Man Guard electric chain hoist - Specifications

## VFD OPTION

- Variable speed control with single speed motor. VFD located completely under the cover.
- 10:1 speed ratio permits precise positioning for load spotting.
- 3-step infinitely variable push-button control offers acceleration and deceleration for full load control.
- Minimizes high-starting current on motor which helps keep it cool extending life of motor, and increases motor run-time and starts/stops over standard contactor control.
- Electronic reversing, multispeed operation (up to 3 steps) eliminates conventional magnetic contactors which are wearable components.
- Fault recorder helps troubleshoot various problems such as power related issues.
- 3 programmable outputs.
- Available Voltages: 380-460/3/60 and 208-230/3/60.

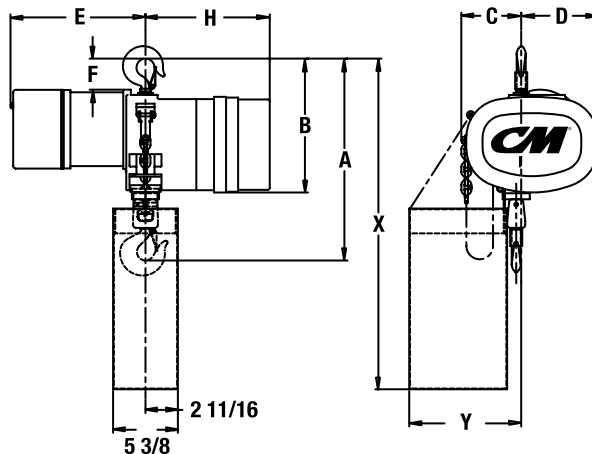

	Capacity	Model Number	Lift Speed	Motor	Parts of Chain	Net Weight	A	B	C	D	E* Max.	F	G	H	X**	Y
SINGLE SPEED HOOK MOUNTED HOISTS	1/4	MG2516	16	1/4	1	77	16-3/4	11-1/8	5	6-5/16	14-1/4	2-9/16	15/16	10-5/16	21-5/8	9-1/2
		MG2532	32	1/2		80								10-5/16		
	1/2	MG5016	16	1/2	1	80	16-3/4	11-1/8	5	6-5/16	14-1/4	2-9/16	15/16	10-5/16	21-5/8	9-1/2
		MG5032	32	1		81								10-5/16		
	1	MG0116	16	1	1	89	17-1/2	11-7/16	5-1/8	6-5/16	14-1/4	2-15/16	1-1/8	10-5/16	21-5/8	9-1/2
		MG0132	32	2-1/2		95								11-5/16		
	2	MG0208	8	1	2	111	23	13-1/8	6-3/8	5-1/16	14-1/4	4-9/16	1-1/16	10-5/16	24-3/4	10-3/4
		MG0216	16	2-1/2		112								11-5/16		
3	MG0305	5	1	3	136	25-7/8	14-3/8	7-7/8	7-1/8	14-1/4	5-7/8	2	10-5/16	30	12-1/4	
	MG0310	10	2-1/2		146								11-5/16			
VFD HOOK MOUNTED HOISTS	1/4	MG2516V	16	1/4	1	77	16-3/4	11-1/8	5	6-5/16	14-1/4	2-9/16	15/16	13-7/16	21-5/8	9-1/2
		MG2532V	32	1/2		80								13-7/16		
	1/2	MG5016V	16	1/2	1	80	16-3/4	11-1/8	5	6-5/16	14-1/4	2-9/16	15/16	13-7/16	21-5/8	9-1/2
		MG5032V	32	1		81								13-7/16		
	1	MG0116V	16	1	1	89	17-1/2	11-7/16	5-1/8	6-5/16	14-1/4	2-15/16	1-1/8	13-7/16	21-5/8	9-1/2
		MG0132V	32	2-1/2		95								13-7/16		
	2	MG0216V	16	2-1/2	2	112	23	13-1/8	6-3/8	5-1/16	14-1/4	4-9/16	1-1/16	13-7/16	24-3/4	10-3/4
		MG0310V	10	2-1/2		146								13-7/16		

\* Maximum length for 3 phase model hoists. Consult factory for exact dimensions.

\*\* Dimensions based on lifts through 10 ft. (all capacities) and increases proportionally with longer lifts.



# ShopStar electric chain hoist

The ShopStar electric chain hoist features rugged construction and high H4 duty cycle. It keeps lifting and lifting, up to 1,000 pounds and 300 motor starts per hour. Additional features and benefits include:

- H4 duty cycle (300 motor starts/hour)
- Easy installation and maintenance
- Standard protector overload device
- 10 pocket oblique lay liftwheel provides longer chain wear
- Epoxy powder coat finish
- 6½ ft. power cord with molded 3 prong plug on 115 volt units
- NEMA 4 industrial rated control station
- Optional impact-resistant chain container available
- Gear train lifetime lubricated with non-oxidizing grease
- CM Hoist Alloy Load Chain (zinc plated optional)
- Thermally protected hoist duty motor
- Dual braking system — D.C. plus regenerative
- Rugged cast aluminum alloy hoist frame
- Meets ASME B30.16
- Small, compact design for commercial & industrial applications
- Rigid hook suspension prevents tangling of power cord
- Hardened forged steel latch style lower hook rotates 360°
- Totally enclosed non-ventilated hoist frame protects motor from environmental contamination
- True vertical lift
- Precision bearings used throughout hoist
- Lifetime warranty
- Made in U.S.A.



## \***WARNING**

**Overloading and improper use can result in injury.**

**To avoid injury:**

- Do not exceed working load limit, load rating capacity
- Do not use to lift people or loads over people.
- use only alloy chain for overhead lifting.
- Read and follow all instructions.



## ShopStar-Specifications

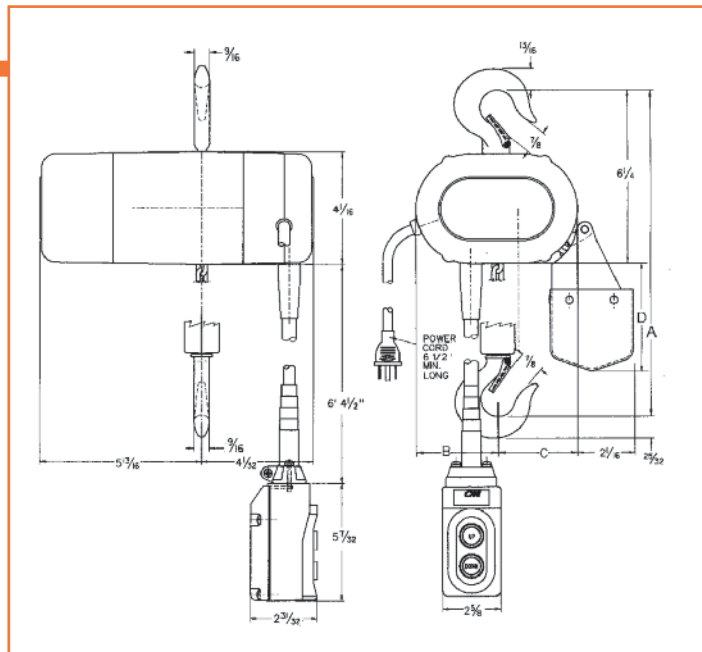

### Clearance dimensions (in.)

Reeving	A	B	C	D
Single	11 <sup>1</sup> / <sub>16</sub>	3	2 <sup>15</sup> / <sub>16</sub>	3 <sup>7</sup> / <sub>8</sub>
Double	11 <sup>15</sup> / <sub>16</sub>	3 <sup>9</sup> / <sub>16</sub>	2 <sup>3</sup> / <sub>8</sub>	5 <sup>3</sup> / <sub>4</sub>

### Chain Containers

Product code	Single reeved	Double reeved	Approx. Shipping wt., lbs.
2063	10	5	1
2064	20	10	1.4
2065	40	20	1.4
2066	80	40	1.4
2067	120	60	2.2

### Specifications

	Product Code			Max. capacity lbs.	Lifting speed F.P.M.	Reeving	Lift ft.	Approx. shipping wt., (lbs.)	Motor H.P.
	115-1-60	230-3-60	460-3-60						
*115-1-60	115-1-60	230-3-60	460-3-60	250	16	single	10	26	1/6
—	2069	2071	2072	250	16	single	10	28	1/6
—	—	2076	2077	250	24	single	10	28	1/6
—	—	2081	2082	250	40	single	10	28	1/6
2000	—	—	—	300	16	single	10	26	1/6
—	2047	2026	2029	300	16	single	10	28	1/6
—	—	2086	2087	300	24	single	10	28	1/6
—	—	2074	2075	300	40	single	10	28	1/6
2095	—	—	—	500	8	double	10	32	1/6
—	2094	2096	2097	500	8	double	10	34	1/6
2090	—	—	—	500	12	single	10	26	1/6
—	2089	2091	2092	500	12	single	10	28	1/6
—	—	2080	2084	500	16	single	10	28	1/6
—	—	2101	2102	500	20	double	10	34	1/6
—	—	2099	2100	500	24	single	10	28	1/6
2001	—	—	—	600	8	double	10	32	1/6
—	2048	2035	2038	600	8	double	10	34	1/6
—	—	2106	2107	600	12	double	10	34	1/6
—	—	2105	2114	600	20	double	10	34	1/6
2110	—	—	—	1000	6	double	10	32	1/6
—	2109	2111	2112	1000	6	double	10	34	1/6
—	—	2116	2117	1000	8	double	10	32	1/6
—	—	2119	2121	1000	12	double	10	32	1/6

\*Codes in this column denote units with contactor in push button control station.

# ShopStar VS Variable Speed Electric Chain Hoist

The CM® ShopStar VS™ variable speed electric chain hoist is built for rugged industrial and commercial applications where precision load control is critical. This durable hoist features a high H4-plus duty cycle and a compact design ideal for use at workstations and production lines. The ShopStar VS is a superior alternative to air hoists.

## STANDARD FEATURES

### RUGGED & DURABLE IMPROVED SERVICEABILITY

Thermally protected hoist motor. Rugged, cast aluminum alloy hoist frame and body feature durable epoxy powder-coat finish to protect against corrosion.

### LOW MAINTENANCE

Gear train lifetime lubricated with non-oxidizing grease. Totally enclosed hoist frame protects motor from environmental contamination.

### COMPACT DESIGN

Small, compact design makes hoist ideal for use in tight spaces and allows for easy installation and maintenance.

### OVERLOAD PROTECTION

Standard overload device protects the hoist, operator and surrounding structure from damaging overloads.

### LONG CHAIN LIFE

Durable CM Hoistaloy® Load Chain. 10-pocket, oblique-lay lift wheel for longer chain life.

### SINGLE- & 3-PHASE VOLTAGE OPTIONS

100 to 240 volt single phase, 50 to 60 Hz. 208 to 240 volt 3 phase. 460 volt and 575 volt 3 phase with optional transformer. 6-1/2 ft. power cord with removable molded, 3-prong 115-volt plug.

### H4 PLUS DUTY CYCLE

With 300+ motor starts per hour and Class F motor insulation, the ShopStar VS outperforms the H3 rating of its major competitors.

### 5:1 DESIGN FACTOR

### NEMA 4 INDUSTRIAL-RATED CONTROL SYSTEM

### STANDARD RIGID-HOOK SUSPENSION

## OPTIONAL FEATURES

### VARIABLE CONTROLS

3-speed and 3-step infinitely variable controls for single and 3-phase applications.

### DURABLE CHAIN CONTAINERS

Impact-resistant plastic/mesh or metal chain containers.

### SWIVEL HOOK SUSPENSION

Swivel hook suspension rotates 360° for easy installation and positioning. Swivel hooks are available with latch and Latchlok® latch. Lug mount suspension is also available.

### CM® ROCKET™ PENDANT

Engineered for maximum operator comfort, the CM Rocket delivers precision load control. Pendant features a unique rocker switch and comfort-fit design that increases safety and efficiency. Not available for 3-step infinitely variable hoist models. Pendant with emergency stop not available on ShopStar VS.



The CM ShopStar VS is ideal for applications in the Automotive, Heavy OEM, Utility and Energy industries. Choose this reliable hoist for light assembly workstations that require high speed and precision control lifting with light rail or trolley systems.

In addition, the ShopStar VS is perfect for maintenance and repair applications demanding accurate load control or long lifts.



# ShopStar VS Specifications

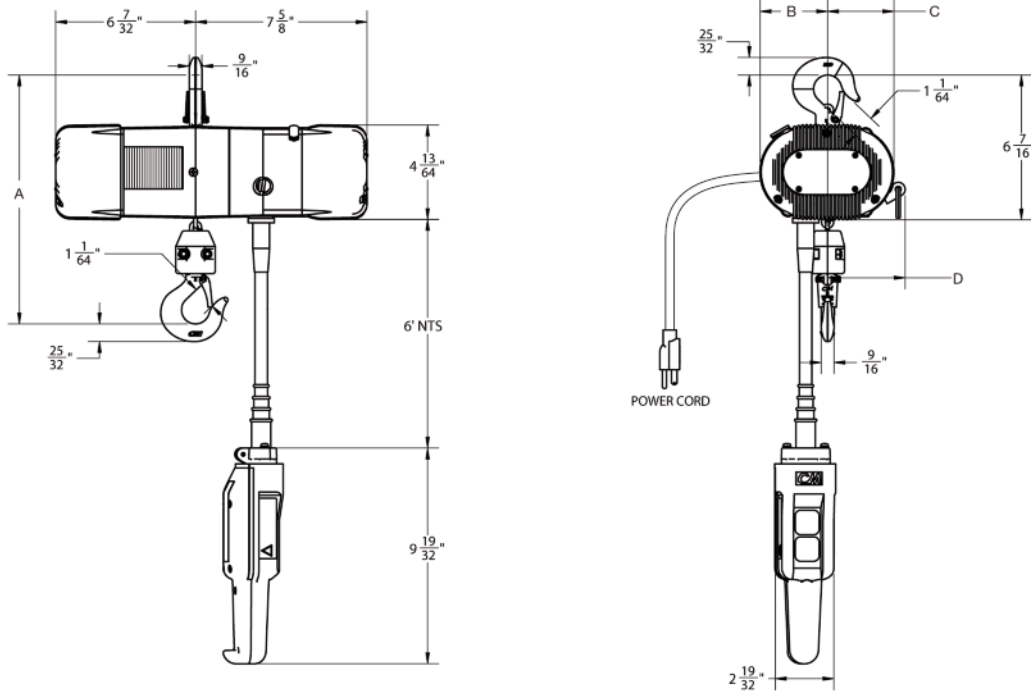

Capacity (Metric Tons)	Product Code				Dimensions in. (mm)				Maximum Lift Speed (ft./min.)	Standard Lift (ft.)	Reeving	Weight (lb.)
	2-Speed	2-Step Infinity Variable Speed	3-Speed	3-Step Infinity Variable Speed	A	B	C	D				
250	VS0250A1	VS0250A2	VS0250A3	VS0250A4	11.06	3	2.95	3.45	63	10	1	26
300	VS0300A1	VS0300A2	VS0300A3	VS0300A4	11.06	3	2.95	3.45	63	10	1	26
500	VS0500A1	VS0500A2	VS0500A3	VS0500A4	11.06	3	2.95	3.45	39	10	1	26
550	VS0550A1	VS0550A2	VS0550A3	VS0550A4	11.06	3	2.95	3.45	26	10	1	26
600	VS0600A1	VS0600A2	VS0600A3	VS0600A4	11.94	3.58	2.36	2.87	31	10	2	28
1000	VS1000A1	VS1000A2	VS1000A3	VS1000A4	11.94	3.58	2.36	2.87	19	10	2	28
1100	VS1100A1	VS1100A2	VS1100A3	VS1100A4	11.94	3.58	2.36	2.87	13	10	2	28

NOTE: Configurable codes and options available in addition to standard products shown above. Optional transformer required for 460-volt applications.

<p><b>* ⚠ WARNING</b></p>
<p><b>Overloading and improper use can result in injury.</b></p>
<p><b>To avoid injury:</b></p> <ul style="list-style-type: none"> <li>• Do not exceed working load limit, load rating capacity</li> <li>• Do not use to lift people or loads over people.</li> <li>• use only alloy chain for overhead lifting.</li> <li>• Read and follow all instructions.</li> </ul>

# Valustar electric chain hoist

Designed specifically for general commercial applications. This compact, lightweight hoist features:

- Fully machined and heat treated liftwheel with hardened chain guides for smooth chain operation and reduced chain wear
- Standard lift 10, 15 & 20 ft.
- 5 ft. power cord length
- Heavy-duty caliper type AC brake
- Rugged NEMA 4 control station, 115 volt control circuit
- Easy to install and maintain
- Hoist alloy load chain for smooth operation and maximum chain life
- Efficient regenerative braking system to avoid heat generation in power train
- Enclosed hoist duty motor
- Gear train lifetime lubricated with non-oxidizing grease
- Latch type hooks
- Hook suspension standard
- Fully machined and heat treated gear train
- Standard overload Protector device
- H3 duty-1 phase; H-4 duty-3 phase
- Lifetime warranty
- Metric rated
- Made in U.S.A.



## Specifications

	Product code		Model	Max. capacity tons	Hoist lifting speed FPM	Reeving	Approximate shipping wt. (lbs.)	
	115-1-60	230/460 3-60					115-1-60	230/460 3-60
<b>Single speed 10' lift</b>	2401	2402	WB	1/4	16	single	54	58
	2403	2404	WF	1/2	16	single	60	58
	2405	2406	WH	1	8	double	70	68
	2407	2408	WL	1	16	single	105	106
	2409	2410	WR	2	8	double	130	122
<b>Single speed 15' lift</b>	2401B	2402B	WB	1/4	16	single	64	62
	2403B	2404B	WF	1/2	16	single	64	62
	2405B	2406B	WH	1	8	double	77	75
	2407B	2408B	WL	1	16	single	111	112
	2409B	2410B	WR	2	8	double	136	128
<b>Single speed 20' lift</b>	2401C	2402C	WB	1/4	16	single	68	66
	2403C	2404C	WF	1/2	16	single	68	66
	2405C	2406C	WH	1	8	double	84	82
	2407C	2408C	WL	1	16	single	116	117
	2409C	2410C	WR	2	8	double	150	142

Longer lifts and modifications available. Apply for details.

# Valustar -Specifications

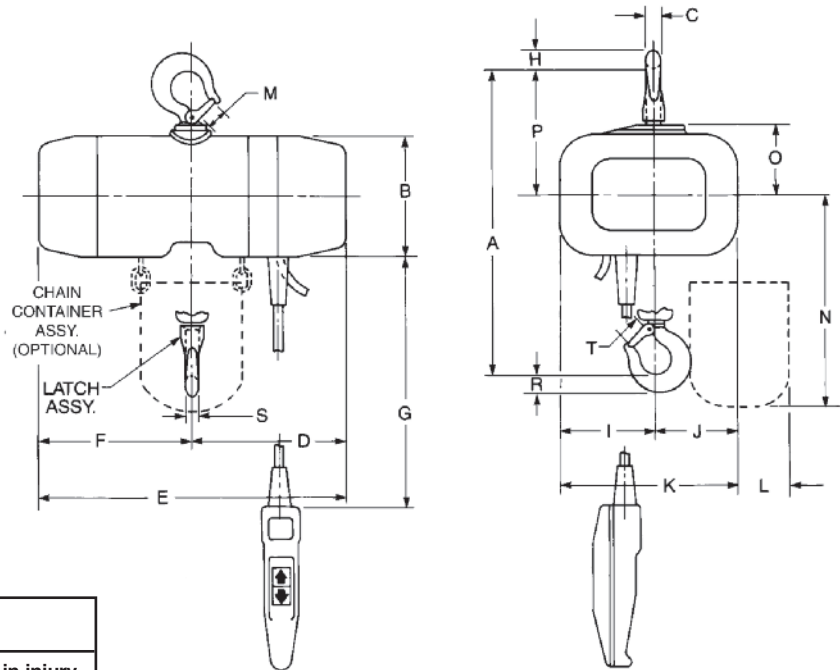

**\*WARNING**

**Overloading and improper use can result in injury.**

**To avoid injury:**

- Do not exceed working load limit, load rating capacity
- Do not use to lift people or loads over people.
- use only alloy chain for overhead lifting.
- Read and follow all instructions.

## Clearance dimensions (in.)

Rated capacity\* (tons)

Dimension	1/4	1/2	1/2	1	1/2	1	2
	Model WB	Model WF	Model WE	Model WH	Model WJ	Model WL	Model WR
A	14 1/4	14 1/4	17 7/8	17 7/8	15 9/16	15 9/16	22 1/2
B	6 1/8	6 1/8	6 1/8	6 1/8	7 5/8	7 5/8	7 5/8
C	1 1/16	1 1/16	7/8	7/8	7/8	7/8	1 1/8
D	8	8	8	8	9	9	9
E	16 1/16	16 1/16	16 1/16	16 1/16	20 3/16	20 3/16	20 3/16
F	8 1/16	8 1/16	8 1/16	8 1/16	11 3/16	11 3/16	11 3/16
G**	6'-3"	6'-3"	6'-3"	6'-3"	6'-3"	6'-3"	6'-3"
H	1	1	1 3/16	1 3/16	1 3/16	1 3/16	1 1/2
I	4 13/16	4 13/16	3 7/8	3 7/8	7 1/4	7 1/4	6 3/16
J	3 15/16	3 15/16	4 7/8	4 7/8	5 7/16	5 7/16	6 1/2
K	8 3/4	8 3/4	8 3/4	8 3/4	12 11/16	12 11/16	12 11/16
L	1 11/16	1 11/16	1 11/16	1 11/16	7/16	7/16	7/16
M	1	1	1 1/8	1 1/8	1 1/8	1 1/8	1 5/16
N**	12 15/16	12 15/16	15 15/16	15 15/16	16 11/16	16 11/16	22 11/16
O	3 9/16	3 9/16	3 9/16	3 9/16	4	4	4
P	6 9/16	6 3/16	6 1/2	6 1/2	6 7/8	6 7/8	7 3/8
R	1	1	1 3/16	1 3/16	1 3/16	1 3/16	1 1/2
S	1 1/16	1 1/16	7/8	7/8	7/8	7/8	1 1/8
T	1	1	1 1/8	1 1/8	1 1/8	1 1/8	1 5/16

\*\* Based on 10 foot lift units

# Powerstar electric chain hoist

Designed specifically as an alternative to wire rope hoists for high speed lifting of loads from 2 to 20 tons in a space saving chain hoist.

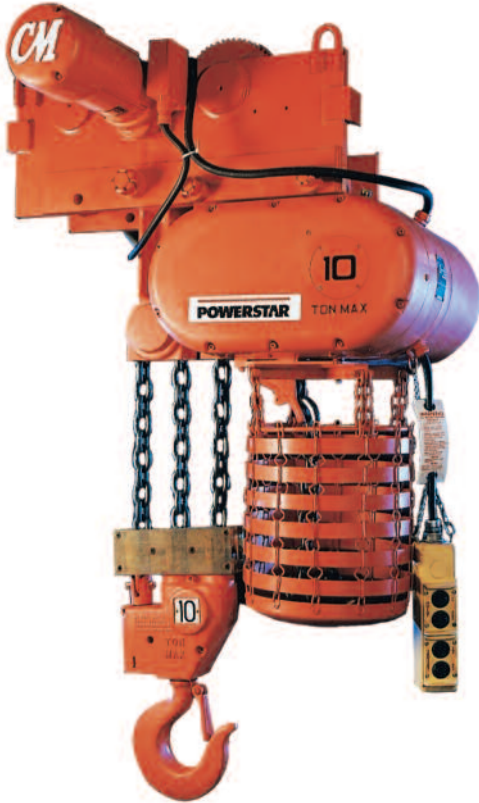

- H-4 or better rated duty cycle
- Designed for heavy-duty industrial applications from 2 to 20 ton capacities
- Liftwheel has machined chain pockets and is heat treated alloy steel for maximum strength and wear resistance
- Efficient regenerative braking system avoids heat generation in power train
- Motors up to 7 1/2 h.p. provide a wide range of lifting speeds
- Single or two speed controls. Two speed models operate on 3:1 speed ratio
- Standard adjustable upper and lower screw limit switches
- Standard overload Protector device
- Hoist alloy load chain can be easily inspected for wear and abuse
- True vertical lift
- Factory tested to 125% of rated capacity prior to shipment
- Metric rated except for 10 & 20 ton capacities
- Rugged aluminum alloy hoist frame
- Chain guide surrounds liftwheel
- Machined and hardened steel Helical gears used throughout hoist for optimum performance and mechanical efficiency.
- Extensive use of life-lubricated bearings plus sealed oil bath power train reservoir for minimum maintenance.
- Dual braking system
- Heavy duty, industrial single speed controls include magnetic reversing contactor which operates on 115 volts provided by a control transformer.
- Totally enclosed, ball bearing, 30 minute rated, thermally protected, hoist duty motor is standard.
- Push button control is weatherproof (NEMA 4 rated).
- Drop of push button control is 4 ft. above hook at lowest position, unless otherwise specified.
- External push button chain strain relief is standard.
- Power cord length is 2 1/2 ft. unless otherwise specified.
- Trolley design permits easy adjustment for installation on a broad range of beam flange widths.
- Trolley wheels have double row, tapered roller bearings plus machined and hardened universal treads to permit operation on American Standard or flat flanged sections interchangeably.
- Spur gearing used in all motorized trolleys for improved efficiency and durability.
- Drop of hand chain on geared trolleys is 2 ft. above hook at lowest position, unless otherwise specified.
- Designed to be maintained "on the beam."
- Up to 600 lineal feet of chain
- Weatherproof (NEMA3R)
- Lifetime warranty
- Made in U.S.A.

## **\*WARNING**

**Overloading and improper use can result in injury.**

### **To avoid injury:**

- Do not exceed working load limit, load rating capacity
- Do not use to lift people or loads over people.
- use only alloy chain for overhead lifting.
- Read and follow all instructions.

# Powerstar-Specifications

## Specifications – standard unit

Rated capacity* (tons)	Single speed			Two speed			Reeving (single)	Std. lift** (ft.)	HP	Headroom w/lug suspension (in.)	Headroom w/trolley suspension (in.)	Hoist only approx. shipping weight	
	Lifting speed (F.P.M.)	Product code 230-3-60	Product code 460-3-60	Lifting speed (F.P.M.)	Product code 230-3-60	Product code 460-3-60						Single speed hoist (lbs.)	Two speed hoist (lbs.)
2	20	7300	7301	20/7	7302	7303	1	20	5	28 <sup>15</sup> / <sub>16</sub>	30 <sup>15</sup> / <sub>16</sub>	392	402
	24	7001	7002	24/8	7003	7004	1	20	5	28 <sup>15</sup> / <sub>16</sub>	30 <sup>15</sup> / <sub>16</sub>	392	402
	32	7304	7305	32/11	7306	7037	1	20	5	28 <sup>15</sup> / <sub>16</sub>	30 <sup>15</sup> / <sub>16</sub>	404	414
	40	7005	7006	40/13	7007	7008	1	20	5	28 <sup>15</sup> / <sub>16</sub>	30 <sup>15</sup> / <sub>16</sub>	404	414
	48	7308	7309	48/16	7310	7311	1	20	7.5	28 <sup>15</sup> / <sub>16</sub>	30 <sup>15</sup> / <sub>16</sub>	408	418
3	20	7312	7313	20/7	7314	7315	1	20	5	28 <sup>15</sup> / <sub>16</sub>	31 <sup>1</sup> / <sub>2</sub>	404	414
	24	7009	7010	24/8	7011	7012	1	20	5	28 <sup>15</sup> / <sub>16</sub>	31 <sup>1</sup> / <sub>2</sub>	404	414
	32	7316	7317	32/11	7318	7319	1	20	7.5	28 <sup>15</sup> / <sub>16</sub>	31 <sup>1</sup> / <sub>2</sub>	408	418
	40	7013	7014	40/13	7015	7016	1	20	7.5	28 <sup>15</sup> / <sub>16</sub>	31 <sup>1</sup> / <sub>2</sub>	408	418
4	10	7320	7321	10/3	7322	7323	2	20	5	34	36 <sup>9</sup> / <sub>16</sub>	478	488
	12	7324	7325	12/4	7326	7327	2	20	5	34	36 <sup>9</sup> / <sub>16</sub>	490	500
	16	7328	7329	16/5	7330	7331	2	20	5	34	36 <sup>9</sup> / <sub>16</sub>	490	500
	20	7332	7333	20/7	7334	7335	2	20	7.5	34	36 <sup>9</sup> / <sub>16</sub>	490	500
	24	7336	7337	24/8	7338	7339	2	20	7.5	34	36 <sup>9</sup> / <sub>16</sub>	494	504
5	10	7340	7341	10/3	7342	7343	2	20	5	34	36 <sup>9</sup> / <sub>16</sub>	478	488
	12	7344	7345	12/4	7346	7347	2	20	5	34	36 <sup>9</sup> / <sub>16</sub>	478	488
	16	7029	7030	16/5	7031	7032	2	20	5	34	36 <sup>9</sup> / <sub>16</sub>	490	500
	20	7348	7349	20/7	7350	7351	2	20	7.5	34	36 <sup>9</sup> / <sub>16</sub>	494	500
	24	7017	7018	24/8	7019	7020	2	20	7.5	34	36 <sup>9</sup> / <sub>16</sub>	494	504
6	10	7352	7353	10/3	7354	7355	2	20	5	34	36 <sup>9</sup> / <sub>16</sub>	548	558
	12	7052	7053	12/4	7054	7055	2	20	5	34	36 <sup>9</sup> / <sub>16</sub>	548	558
	16	7356	7357	16/5	7358	7359	2	20	7.5	34	36 <sup>9</sup> / <sub>16</sub>	552	562
	20	7056	7057	20/7	7058	7059	2	20	7.5	34	36 <sup>9</sup> / <sub>16</sub>	552	562
7 <sup>1</sup> / <sub>2</sub>	7	7360	7361	7/2	7362	7363	3	20	5	Apply	39 <sup>3</sup> / <sub>8</sub>	594	604
	8	7364	7365	8/3	7366	7367	3	20	5	Apply	39 <sup>3</sup> / <sub>8</sub>	606	616
	11	7368	7369	11/4	7370	7371	3	20	5	Apply	39 <sup>3</sup> / <sub>8</sub>	606	616
	14	7372	7373	14/5	7374	7375	3	20	7.5	Apply	39 <sup>3</sup> / <sub>8</sub>	622	632
	16	7376	7377	16/5	7378	7379	3	20	7.5	Apply	39 <sup>3</sup> / <sub>8</sub>	622	632
9	7	7380	7381	7/2	7382	7383	3	20	5	Apply	41 <sup>3</sup> / <sub>16</sub>	610	620
	8	7384	7385	8/3	7386	7387	3	20	5	Apply	41 <sup>3</sup> / <sub>16</sub>	610	620
	11	7388	7389	11/4	7390	7391	3	20	7.5	Apply	41 <sup>3</sup> / <sub>16</sub>	626	636
	13	7392	7393	13/4	7394	7395	3	20	7.5	Apply	41 <sup>3</sup> / <sub>16</sub>	626	636
10	7	7396	7397	7/2	7398	7399	3	20	5	Apply	41 <sup>3</sup> / <sub>16</sub>	610	620
	8	7400	7401	8/3	7402	7403	3	20	5	Apply	41 <sup>3</sup> / <sub>16</sub>	610	620
	11	7404	7405	11/4	7406	7407	3	20	7.5	Apply	41 <sup>3</sup> / <sub>16</sub>	626	636
	13	7408	7409	13/4	7410	7411	3	20	7.5	Apply	41 <sup>3</sup> / <sub>16</sub>	626	636
12	5	7412	7413	5/2	7414	7415	4	20	5	Apply	41 <sup>3</sup> / <sub>16</sub>	710	720
	6	7416	7417	6/2	7418	7419	4	20	5	Apply	41 <sup>3</sup> / <sub>16</sub>	710	720
	8	7420	7421	8/3	7422	7423	4	20	7.5	Apply	41 <sup>3</sup> / <sub>16</sub>	726	736
	10	7424	7425	10/3	7426	7427	4	20	7.5	Apply	41 <sup>3</sup> / <sub>16</sub>	726	736
15	4	7428	7429	4/1.3	7430	7431	5	20	5	Apply	47 <sup>5</sup> / <sub>16</sub>	805	815
	5	7432	7433	5/1.5	7434	7435	5	20	5	Apply	47 <sup>5</sup> / <sub>16</sub>	805	815
	6	7436	7437	6/2	7438	7439	5	20	7.5	Apply	47 <sup>5</sup> / <sub>16</sub>	817	827
	8	7440	7441	8/2.5	7442	7443	5	20	7.5	Apply	47 <sup>5</sup> / <sub>16</sub>	817	827

\*\* 20 ft. lift is standard — for other lifts, apply.