



Model L

Locking Type

The **Model L** is an ergonomic vertical lifting clamp capable of turning a single plate or member from horizontal to vertical and back to horizontal through the same 90 degree arc. The “Lock Open – Lock Closed” feature facilitates attaching and removing the clamp from the plate.

MODEL L EXPLODED VIEW

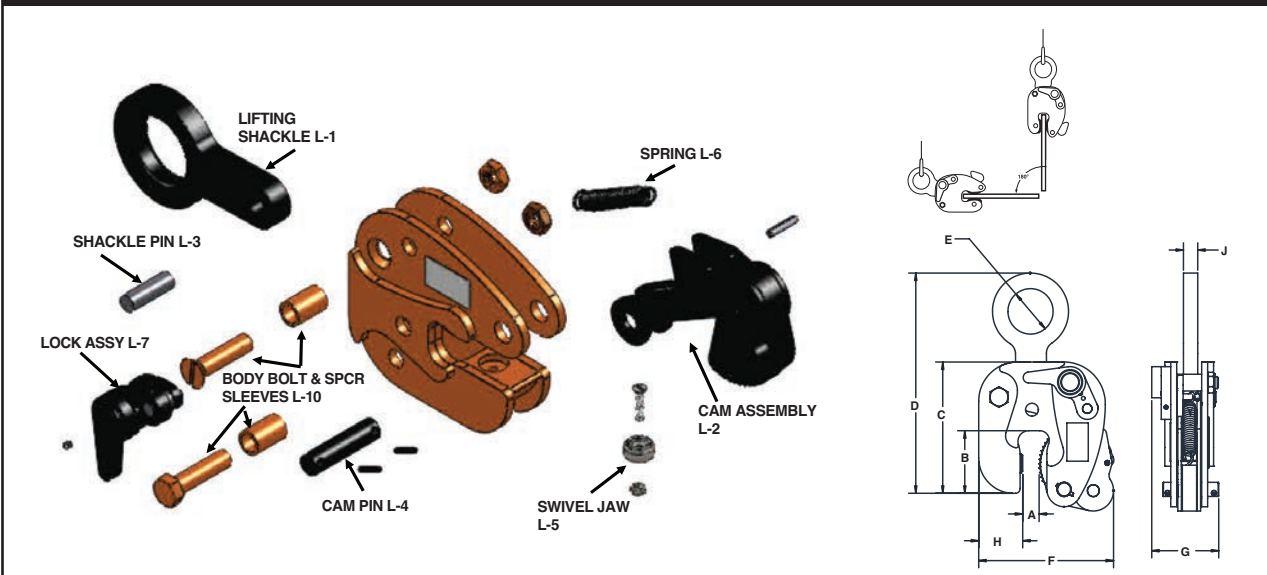

SPECIFICATIONS (in inches)

Rated Capacity Tons	Plate Thickness A	B	C	MAX. D	E	MAX. F	G	H	J	Weight (in pounds)
1/2	0-5/8	2	4 7/8	8	1 1/8	4 1/4	2 7/16	1 3/8	3/8	4 1/8
1	0-3/4	2	4 7/8	8	1 1/8	4 3/8	2 7/16	1 3/8	1/2	5 1/8
2	0-1	3 5/16	6 7/8	12 1/2	2 3/8	7 1/16	3 5/8	2 3/8	3/4	16 7/8
3	0-1	3 7/16	10	17	3 3/8	8 1/2	3 13/16	2 3/4	3/4	32

Consult factory for possible larger capacities. SPECIFICATIONS ARE SUBJECT TO CHANGE WITHOUT NOTICE

Model LP

Locking Type



The **Model LP** is an ergonomic vertical lifting clamp capable of turning a single plate or member from horizontal to vertical and back to horizontal through the same 90 degree arc. Permits side loading of lifting shackle to 90 degrees by de-rating of clamp's capacity. Refer to FIGURE 1 for de-rated capacities. The "Lock Open – Lock Closed" feature facilitates attaching and removing the clamp from the plate.

Model LP incorporates a pivoting shackle that permits side loading of the lifting shackle at 100 percent of rated capacity from vertical to 30 degrees, 75 percent of rated capacity between 30 and 45 degrees, and 50 percent of rated capacity between 45 and 90 degrees.

MODEL LP EXPLODED VIEW

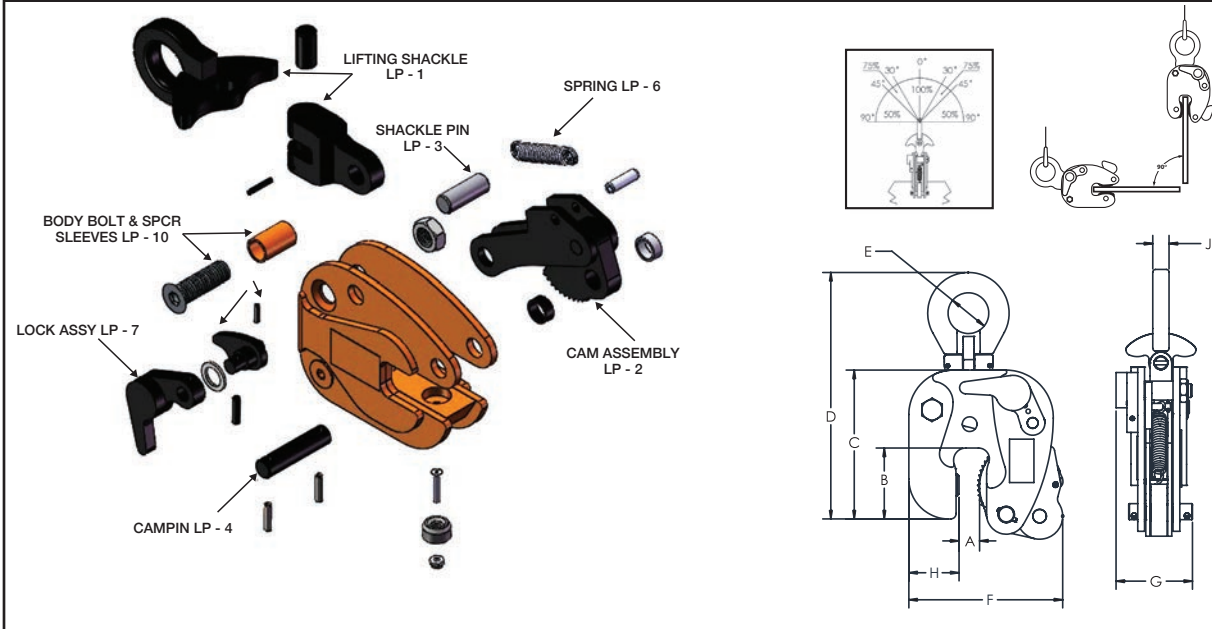

SPECIFICATIONS (in inches)

Rated Capacity Tons	Plate Thickness A	B	C	MAX. D	E	MAX. F	G	H	J	Weight (in pounds)
1/2	0-5/8	2	5 1/16	8 11/16	1 1/8	4 1/4	2 7/16	1 3/8	3/8	4 1/8
1	0-3/4	2	5 1/8	8 11/16	1 1/8	4 3/8	2 7/16	1 3/8	1/2	5 1/8
2	0-1	3 5/16	6 7/8	12 1/2	1 7/8	7 1/16	3 5/8	2 3/8	3/4	16 7/8
3	0-1	3 7/16	10	17	3 3/8	8 1/2	3 13/16	2 3/4	3/4	32

Consult factory for possible larger capacities. SPECIFICATIONS ARE SUBJECT TO CHANGE WITHOUT NOTICE

VERTICAL + 90 + SIDE PULL



Model LA

Locking Type

Model LA is an ergonomic vertical lifting clamp capable of turning a single plate or member from horizontal to vertical to horizontal through a 180 degree arc. It incorporates a push button auxiliary lock. The “Lock Open – Lock Closed” feature facilitates attaching and removing the clamp from the plate.

MODEL LA EXPLODED VIEW

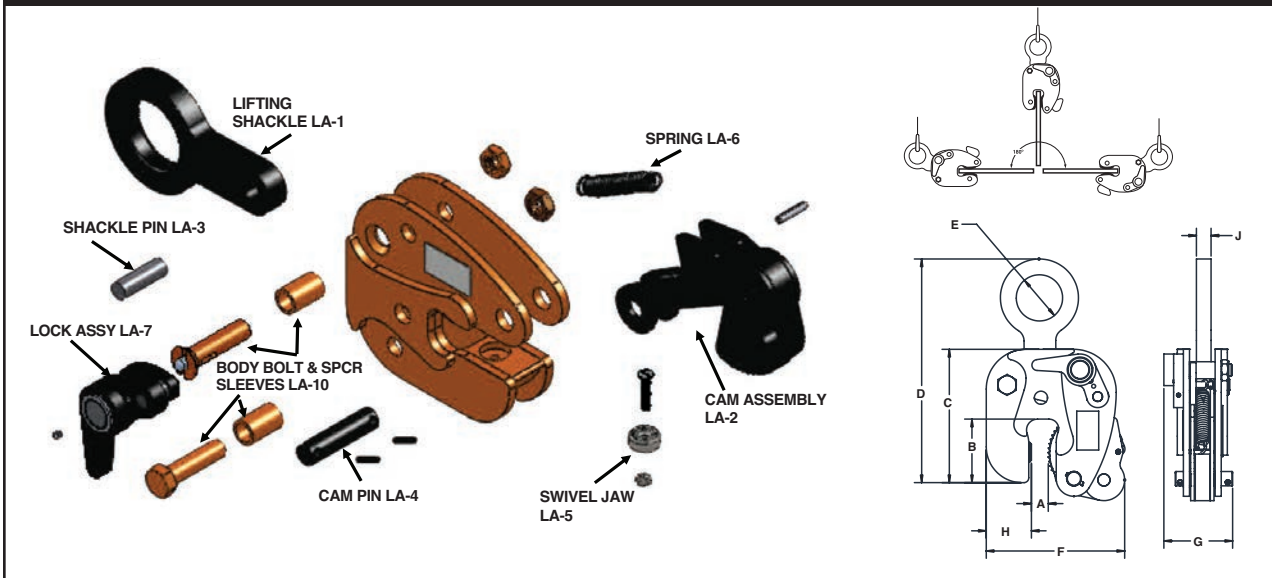

SPECIFICATIONS (in inches)

Rated Capacity Tons	Plate Thickness A	B	C	MAX. D	E	MAX. F	G	H	J	Weight (in pounds)
1/2	0-5/8	2	4 7/8	8	1 1/8	4 1/4	2 7/16	1 3/8	3/8	4 1/8
1	0-3/4	2	4 7/8	8	1 1/8	4 3/8	2 7/16	1 3/8	1/2	5 1/8
2	0-1	3 5/16	6 7/8	12 1/2	2 3/8	7 1/16	3 5/8	2 3/8	3/4	16 7/8
3	0-1	3 7/16	10	17	3 3/8	8 1/2	3 13/16	2 3/4	3/4	32

Consult factory for possible larger capacities. SPECIFICATIONS ARE SUBJECT TO CHANGE WITHOUT NOTICE



Model LPA

Locking Type



Model LPA is an ergonomic vertical lifting clamp capable of turning a single plate or member from horizontal to vertical to horizontal through a 180 degree arc. It incorporates an auxiliary push button lock. Permits side loading of lifting shackle to 90 degrees by de-rating of clamp's capacity. Refer to FIGURE 1 for de-rated capacities. The "Lock Open – Lock Closed" feature facilitates attaching and removing the clamp from the plate.

The Model LPA incorporates a pivoting shackle that permits side loading of the lifting shackle at 100 percent of rated capacity from vertical to 30 degrees, 75 percent of rated capacity between 30 and 45 degrees, and 50 percent of rated capacity between 45 and 90 degrees.

MODEL LPA EXPLODED VIEW

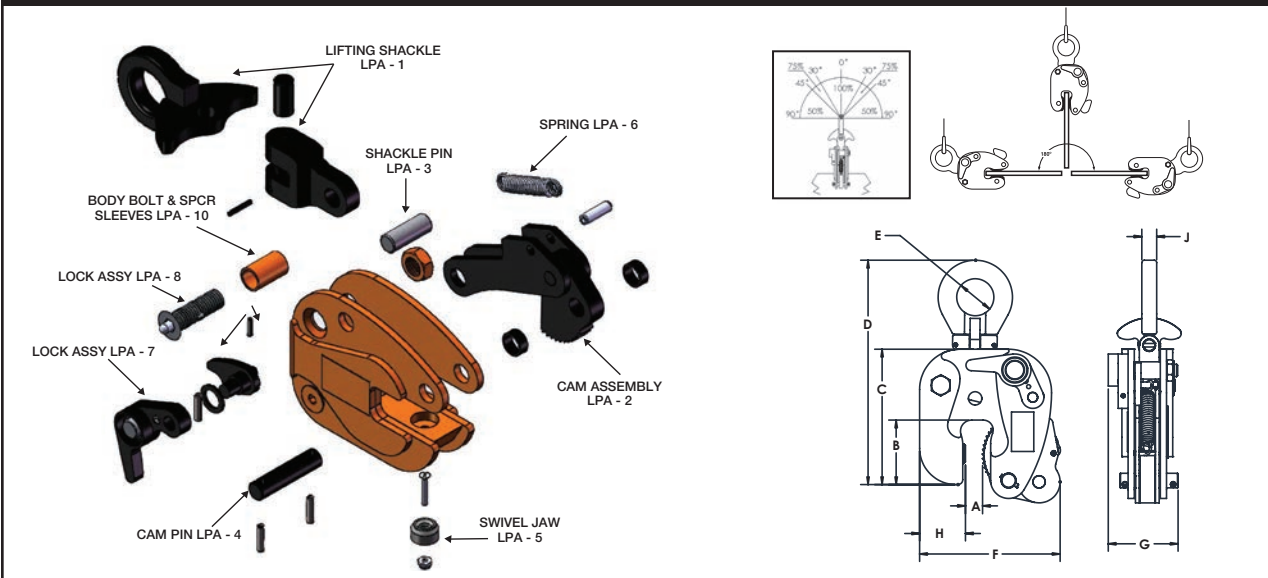

SPECIFICATIONS (in inches)

Rated Capacity Tons	Plate Thickness A	B	C	MAX. D	E	MAX. F	G	H	J	Weight (in pounds)
1/2	0-5/8	2	5 1/16	8 11/16	1 1/8	4 1/4	2 7/16	1 3/8	3/8	4 1/8
1	0-3/4	2	5 1/8	8 11/16	1 1/8	4 3/8	2 7/16	1 3/8	1/2	5 1/8
2	0-1	3 5/16	6 7/8	12 1/2	1 7/8	7 1/16	3 5/8	2 3/8	3/4	16 7/8
3	0-1	3 7/16	10	17	3 5/8	8 1/2	3 13/16	2 3/4	3/4	32

Consult factory for possible larger capacities. SPECIFICATIONS ARE SUBJECT TO CHANGE WITHOUT NOTICE





Model LHC

Non-Locking Type

The **LHC Model** is a horizontal lifting clamp intended to be used in pairs, sets of pairs or in a tripod arrangement for transporting steel plates horizontally. The clamp is designed to lift individual sheets horizontally. Cam operations ensure a tight grip on the load. Serrated gripping cam bites into load for positive grip. Clamps rest in position on edge of plate until tension is applied to the load sling. Clamps must be used in single pairs (2), double pairs (4), or tripod (3) configuration with a lifting sling.

MODEL LHC EXPLODED VIEW

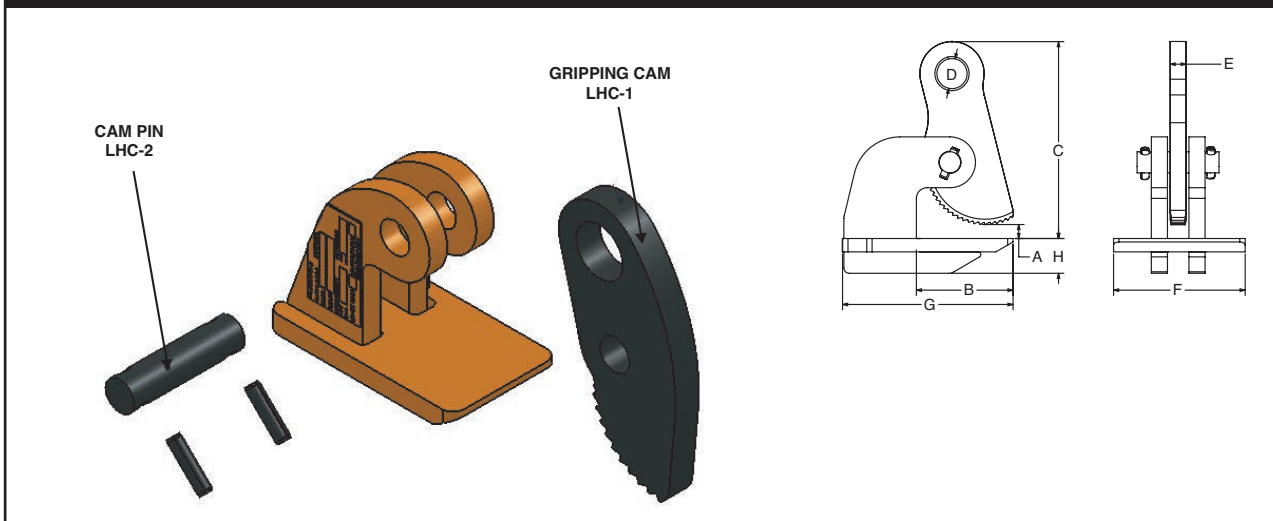

SPECIFICATIONS (in inches)

Rated Capacity Tons per Clamp	Plate Thickness A	B	C	D	E	F	G	H	Weight Each (in pounds)
1/4	0-1	2 3/8	5	1	1/2	2 1/4	4	3/8	3
1/2	0-2	4 3/8	9 1/4	1 3/8	1/2	4 7/8	7 3/4	5/8	14
3/4	0-2	4 3/8	9 1/4	1 13/32	3/4	5 3/8	7 3/4	3/4	19
1 1/2	0-2	4 9/16	9 1/4	1 13/32	3/4	6 1/8	7 15/16	1	26
3	0-2	4 1/2	9 1/4	1 13/32	3/4	6 1/8	7 15/16	1 5/8	24
4	0-3	7	12 5/16	1 13/32	1	6 1/2	10 3/8	2 3/16	48

Consult factory for possible larger capacities. SPECIFICATIONS ARE SUBJECT TO CHANGE WITHOUT NOTICE



PLATE AND FABRICATED – VERTICAL ONLY





Model BD

Non-Locking Type

The **Model BD** is a vertical lifting, non-locking clamp used primarily for steel warehousing and bench work where a locking type clamp is not essential. The clamp is a low-cost, low maintenance tool that features lightweight and compact size. It is recommended for use and application where constant tension is applied to the lifting shackle throughout the entire operation.

MODEL BD EXPLODED VIEW

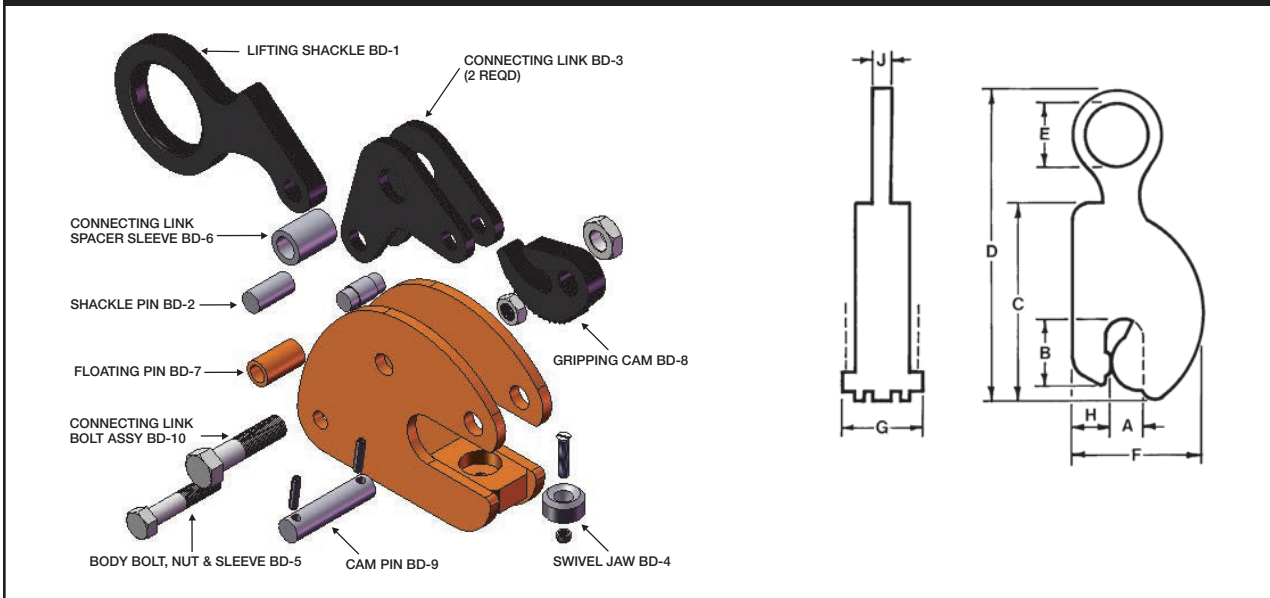

SPECIFICATIONS (in inches)

Rated Capacity Tons	Plate Thickness A	MAX. B	C	D	E	F	G	H	J	Weight (in pounds)
1/2	0-1	2 ⁹ / ₁₆	6 ⁵ / ₁₆	10 ³ / ₈	1 ³ / ₄	4 ¹ / ₂	2 ¹ / ₄	1 ³ / ₈	1/2	6
1	0-1 ¹ / ₈	3 ¹ / ₁₆	7 ⁵ / ₁₆	12 ³ / ₄	2 ¹ / ₂	5 ⁹ / ₁₆	2 ⁷ / ₈	1 ⁵ / ₈	5/8	11
2	0-1 ³ / ₈	3 ⁹ / ₁₆	8 ¹ / ₁₆	14 ¹ / ₂	3 ¹ / ₈	6 ⁹ / ₁₆	3	2 ¹ / ₄	5/8	16
4	0-1 ³ / ₄	3 ⁷ / ₈	10 ³ / ₄	17 ³ / ₄	3 ¹ / ₈	7 ⁷ / ₁₆	3 ⁷ / ₈	2 ¹ / ₄	3/4	27
7	1/4-2 ¹ / ₂	5	12 ³ / ₄	22 ¹ / ₂	3 ⁷ / ₈	9 ⁵ / ₈	5	3	1	65

SPECIFICATIONS ARE SUBJECT TO CHANGE WITHOUT NOTICE.

Model FR

Locking Type



The **Model FR** is a vertical lifting tool for relatively light work. It is small and easy to handle in capacities through three tons. It incorporates a “Lock Closed” feature which facilitates attaching the clamp to the plate.

MODEL FR EXPLODED VIEW

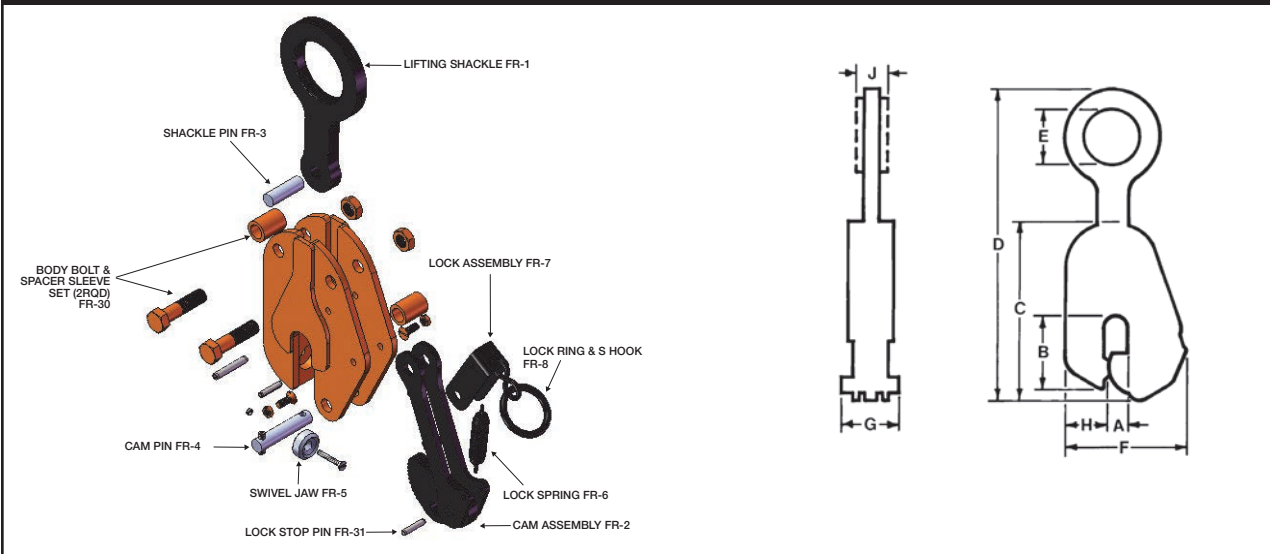

SPECIFICATIONS (in inches)

Rated Capacity Tons	Plate Thickness A	B	C	MAX. D	E	F	G	H	J	Weight (in pounds)
1/2	0-3/4	2 13/16	7	11 1/4	2 3/8	4 7/8	2 1/2	1 1/2	1/2	8
	1/2-1	2 13/16	7	11 1/4	2 3/8	4 7/8	2 1/2	1 1/2	1/2	8
	3/4-1 1/4	2 13/16	7	11 1/4	2 3/8	5 1/8	2 1/2	1 1/2	1/2	9
	1-1 1/2	2 13/16	7	11 1/4	2 3/8	5 3/8	2 1/2	1 1/2	1/2	10
	1 1/4-1 3/4	2 13/16	7	11 1/4	2 3/8	5 3/8	2 1/2	1 1/2	1/2	11
1	0-3/4	3 3/16	9	13 3/4	2 7/16	5 7/8	3 3/16	1 5/8	5/8	14
	1/2-1	3 3/16	9	13 3/4	2 7/16	6 1/8	3 3/16	1 5/8	5/8	15
	3/4-1 1/4	3 3/16	9	13 3/4	2 7/16	6 3/8	3 3/16	1 5/8	5/8	15
	1-1 1/2	3 3/16	9	13 3/4	2 7/16	6 3/8	3 3/16	1 5/8	5/8	16
	1 1/4-1 3/4	3 3/16	9	13 3/4	2 7/16	6 3/8	3 3/16	1 5/8	5/8	17
2	1 1/2-2	3 3/16	9	13 3/4	2 7/16	7 1/8	3 3/16	1 5/8	5/8	18
	0-1	3 1/2	9	16 3/8	3 3/8	6 3/4	3 3/8	2 1/8	3/4	23
	3/4-1 1/2	3 1/2	9	16 3/8	3 3/8	7 1/4	3 3/8	2 1/8	3/4	23
	1 1/4-2	3 1/2	9	16 3/8	3 3/8	7 3/4	3 3/8	2 1/8	3/4	23
3	1 3/4-2 1/2	3 1/2	9	16 3/8	3 3/8	8 1/4	3 3/8	2 1/8	3/4	24
	0-1 1/4	4 3/16	10 3/4	18 3/8	3 5/8	7 5/8	3 9/16	2 7/16	3/4	30
	3/4-1 1/2	4 3/16	10 3/4	18 3/8	3 5/8	7 5/8	3 9/16	2 7/16	3/4	31
3	1 1/4-2	4 3/16	10 3/4	18 3/8	3 5/8	8 3/8	3 9/16	2 7/16	3/4	32
	1 3/4-2 1/2	4 3/16	10 3/4	18 3/8	3 5/8	8 3/8	3 9/16	2 7/16	3/4	33

SPECIFICATIONS ARE SUBJECT TO CHANGE WITHOUT NOTICE.

PLATE AND FABRICATED – VERTICAL ONLY



Model FRD

Locking Type

The **Model FRD** is a vertical lifting clamp that incorporates two Model FR clamps into one and is used for heavy duty work where it is desirable to spread the gripping surfaces with two points of contact. The clamp contains two “Lock Closed” mechanisms which are activated by a single chain and a manually operated “Lock Open” mechanism.

MODEL FRD EXPLODED VIEW

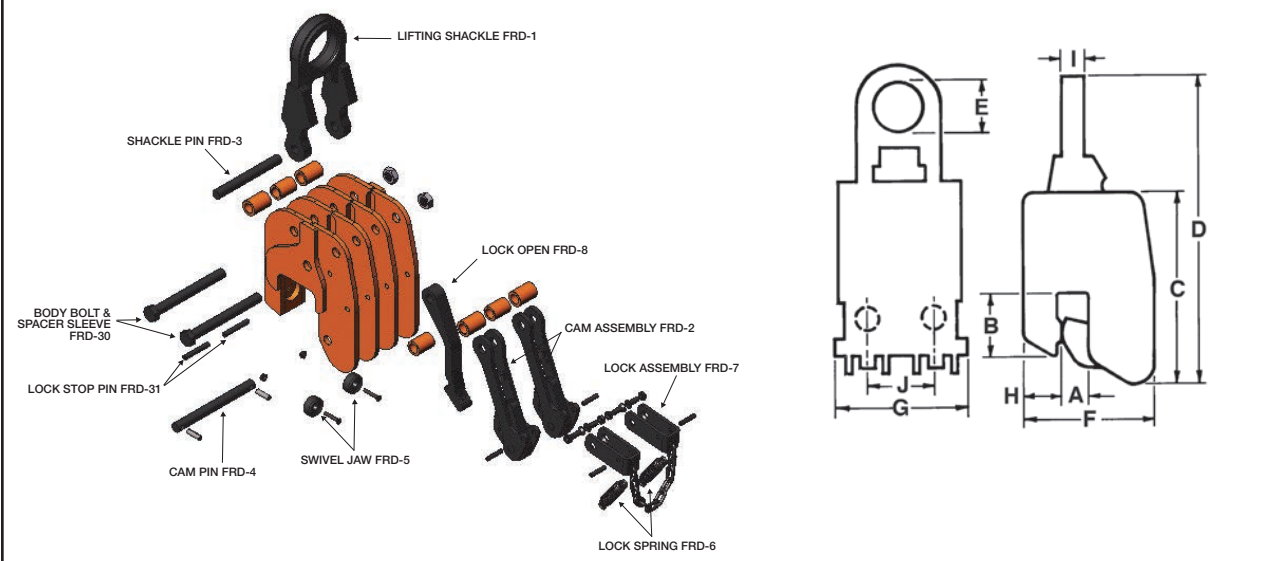

SPECIFICATIONS (in inches)

Rated Capacity Tons	Plate Thickness A	B	C	MAX. D	E	F	G	H	I	J	Weight (in pounds)
1	0- $\frac{3}{8}$	$2\frac{5}{8}$	$7\frac{3}{4}$	14	$2\frac{3}{8}$	$4\frac{3}{4}$	$5\frac{1}{2}$	$1\frac{1}{2}$	$\frac{5}{8}$	3	16
	0- $\frac{3}{4}$	$2\frac{5}{8}$	$7\frac{3}{4}$	14	$2\frac{5}{8}$	$5\frac{1}{8}$	$5\frac{1}{2}$	$1\frac{1}{2}$	$\frac{5}{8}$	3	18
	$\frac{3}{4}$ - $1\frac{1}{4}$	$2\frac{5}{8}$	$7\frac{3}{4}$	14	$2\frac{3}{8}$	$5\frac{5}{8}$	$5\frac{1}{2}$	$1\frac{1}{2}$	$\frac{5}{8}$	3	20
	$1\frac{1}{4}$ - $1\frac{3}{4}$	$2\frac{5}{8}$	$7\frac{3}{4}$	14	$2\frac{3}{8}$	$5\frac{5}{8}$	$5\frac{1}{2}$	$1\frac{1}{2}$	$\frac{5}{8}$	3	24
2	0- $\frac{3}{4}$	$3\frac{1}{16}$	9	$15\frac{3}{8}$	$2\frac{1}{2}$	6	$6\frac{1}{2}$	$1\frac{5}{8}$	$\frac{3}{4}$	$3\frac{1}{8}$	26
	$\frac{3}{4}$ - $1\frac{1}{4}$	$3\frac{1}{16}$	9	$15\frac{3}{8}$	$2\frac{1}{2}$	$6\frac{1}{2}$	$6\frac{1}{2}$	$1\frac{5}{8}$	$\frac{3}{4}$	$3\frac{1}{8}$	30
	$1\frac{1}{4}$ - $1\frac{3}{4}$	$3\frac{1}{16}$	9	$15\frac{3}{8}$	$2\frac{1}{2}$	7	$6\frac{1}{2}$	$1\frac{5}{8}$	$\frac{3}{4}$	$3\frac{1}{8}$	34
4	0-1	$3\frac{1}{2}$	$9\frac{7}{16}$	$17\frac{3}{4}$	$2\frac{7}{8}$	$6\frac{5}{16}$	$6\frac{3}{4}$	$2\frac{1}{8}$	$\frac{3}{4}$	$3\frac{5}{8}$	40
	1- $1\frac{3}{4}$	$3\frac{1}{2}$	$9\frac{7}{16}$	$17\frac{3}{4}$	$2\frac{7}{8}$	$7\frac{1}{16}$	$6\frac{3}{4}$	$2\frac{1}{8}$	$\frac{3}{4}$	$3\frac{5}{8}$	44
	$1\frac{3}{4}$ - $2\frac{1}{2}$	$3\frac{1}{2}$	$9\frac{7}{16}$	$17\frac{3}{4}$	$2\frac{7}{8}$	$7\frac{13}{16}$	$6\frac{3}{4}$	$2\frac{1}{8}$	$\frac{3}{4}$	$3\frac{5}{8}$	48
6	0- $1\frac{3}{8}$	$4\frac{1}{8}$	$11\frac{1}{2}$	$20\frac{5}{8}$	$3\frac{3}{16}$	7	$7\frac{7}{8}$	2	$1\frac{3}{8}$	$4\frac{1}{8}$	58
	$1\frac{3}{8}$ - $2\frac{1}{2}$	$4\frac{1}{8}$	$11\frac{1}{2}$	$20\frac{5}{8}$	$3\frac{3}{16}$	$8\frac{1}{8}$	$7\frac{7}{8}$	2	$1\frac{3}{8}$	$4\frac{1}{8}$	67
	$2\frac{1}{2}$ - $3\frac{5}{8}$	$4\frac{1}{8}$	$11\frac{1}{2}$	$20\frac{5}{8}$	$3\frac{3}{16}$	$9\frac{1}{4}$	$7\frac{7}{8}$	2	$1\frac{3}{8}$	$4\frac{1}{8}$	66

SPECIFICATIONS ARE SUBJECT TO CHANGE WITHOUT NOTICE.

Model R

Non-Locking Type



The **Model R** is a vertical lifting clamp primarily used in the handling of heavy steel plate in a wide range of plate thicknesses. Specific models are available for handling “hot” plate (refer to factory for maximum temperatures and recommended application).

The **Model R** incorporates a “Lock Open,” “Lock Closed” feature which facilitates attaching and removing the clamp from the plate.

MODEL R EXPLODED VIEW

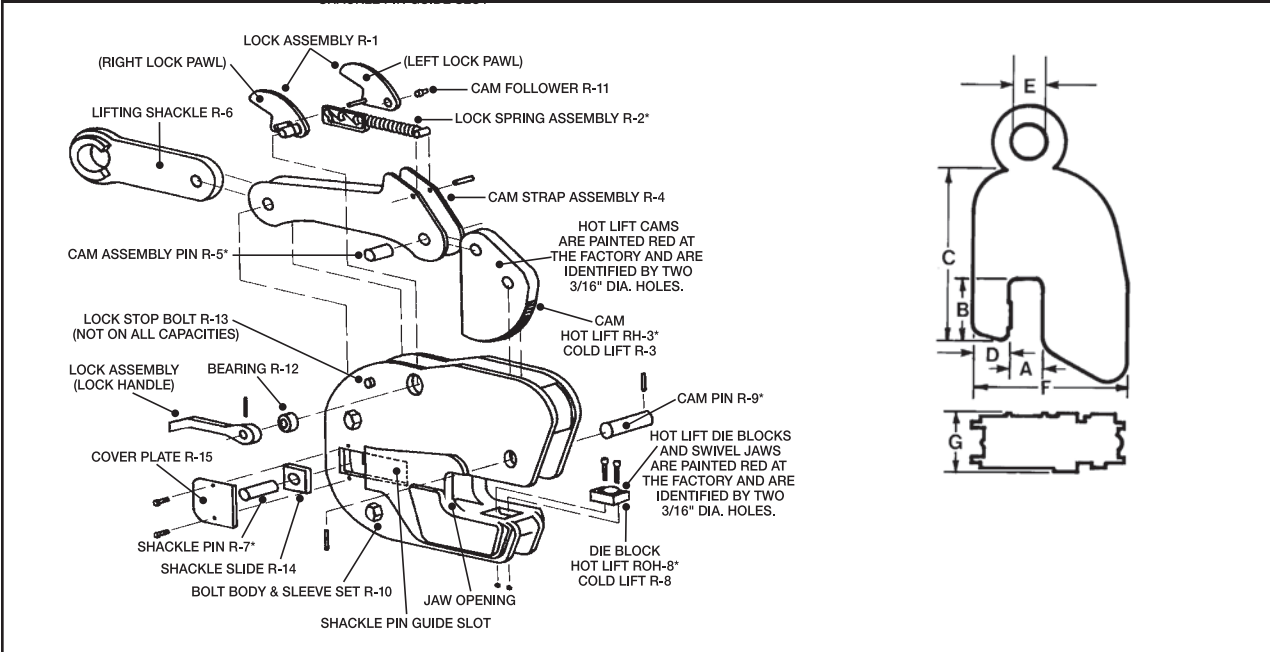

PLATE AND FABRICATED – VERTICAL ONLY

SPECIFICATIONS (in inches)

Rated Capacity Tons	Plate Thickness A	B	C	D	E	F	G	Weight (in pounds)
35	¼-4¼	8¾	23¾	5⅞	5	21¾	8	470
	4-8	8¾	23¾	5⅞	5	25⅞	8	515
50	½-6½	13	44¾	9	5	36	13½	1370
	6-12	13	44¾	9	5	41½	13½	1500
75	½-6½	16½	46¾	14¼	11	42½	12½	2700
	3-9	16½	46¾	14¼	11	45	12½	2775
	6-12	16½	46¾	14¼	11	48	12½	2850
	8-14	16½	46¾	14¼	11	50	12½	2900

SPECIFICATIONS ARE SUBJECT TO CHANGE WITHOUT NOTICE.



Model RO

Locking Type

The **Model RO** incorporates a “Lock Open Only” feature allowing the clamp to be “Locked Open,” lifted onto a “hot” plate and the lock released without the operator coming in close contact with the “hot” plate.

MODEL RO EXPLODED VIEW

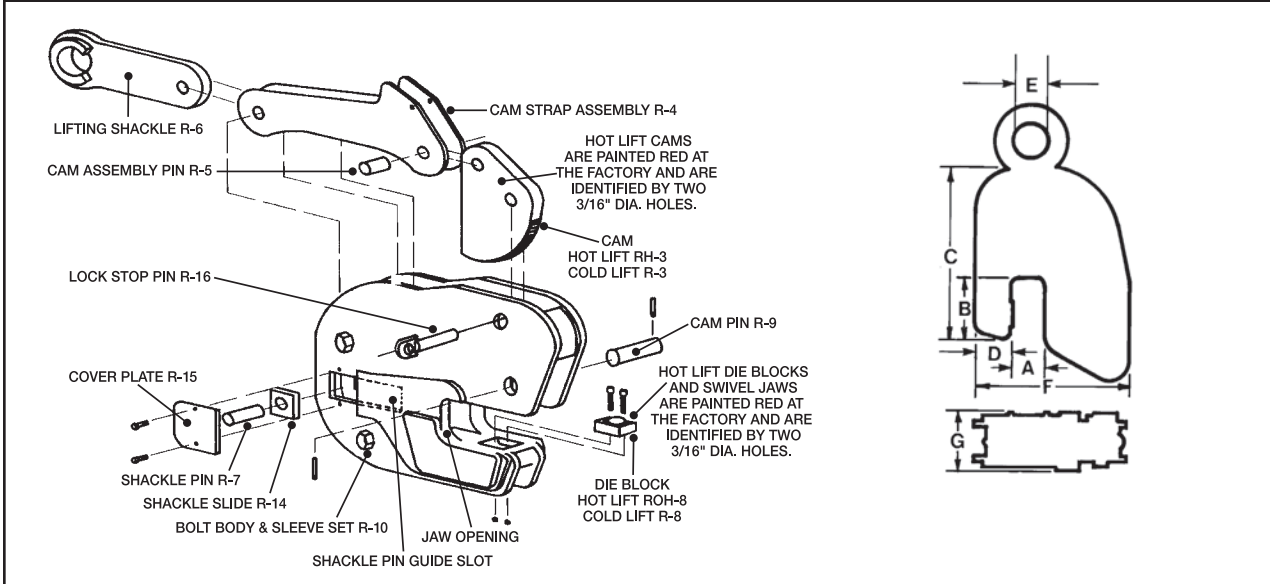

PLATE AND FABRICATED – VERTICAL ONLY

SPECIFICATIONS (in inches)

Rated Capacity Tons	Plate Thickness A	B	C	D	E	F	G	Weight (in pounds)
35	¼-4¼	8¾	23⅝	5⅙	5	21⅝	8	470
	4-8	8¾	23⅝	5⅙	5	25⅝	8	515
50	½-6½	13	44¾	9	5	36	13½	1370
	6-12	13	44¾	9	5	41½	13½	1500
75	½-6½	16½	46¾	14¼	11	42½	12½	2700
	3-9	16½	46¾	14¼	11	45	12½	2775
	6-12	16½	46¾	14¼	11	48	12½	2850
	8-14	16½	46¾	14¼	11	50	12½	2900

SPECIFICATIONS ARE SUBJECT TO CHANGE WITHOUT NOTICE.



Model S

Locking Type

The **Model S** is a vertical lifting clamp and is an effective tool for construction and erection. It incorporates a “Lock Open,” “Lock Closed” feature which facilitates attaching and removing the clamp from the plate.

MODEL S EXPLODED VIEW

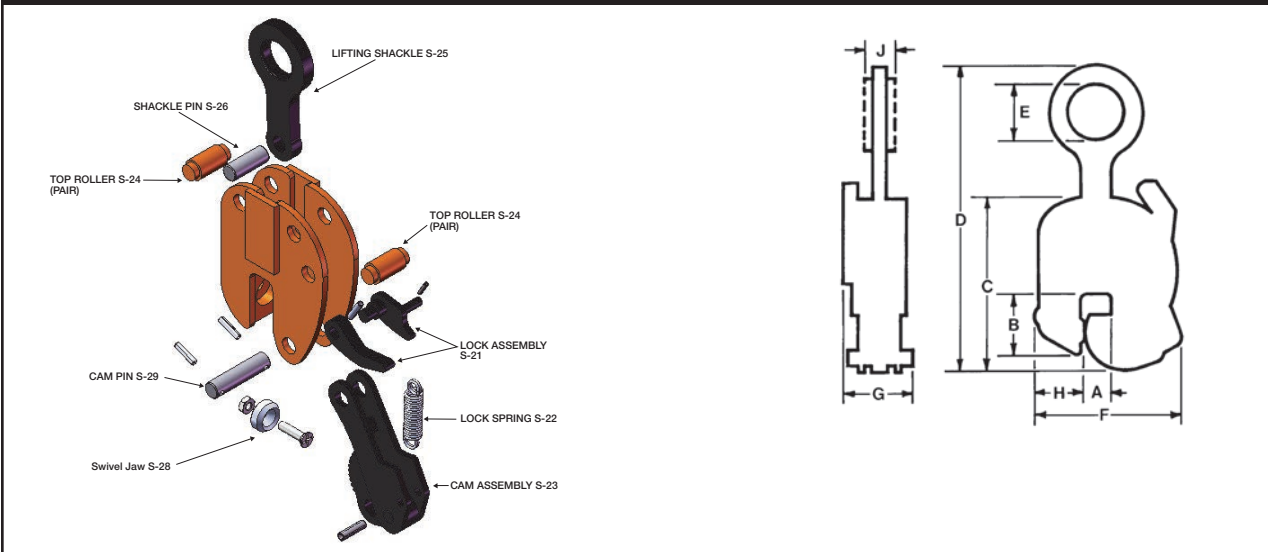

SPECIFICATIONS (in inches)

Rated Capacity Tons	Plate Thickness A	B	C	MAX. D	E	F	G	H	J	Weight (in pounds)
2	0-1	3/16	10	17	3 3/8	8 1/2	3 13/16	2 3/4	3/4	32
	1-1 1/2	3/16	10	17	3 3/8	9	3 13/16	2 3/4	3/4	33
	1 1/4-2	3/16	10	17	3 3/8	9 1/2	3 13/16	2 3/4	3/4	33
	1 3/4-2 1/2	3/16	10	17	3 3/8	10	3 13/16	2 3/4	3/4	36
4	0-1 1/4	4 1/8	11 1/2	19 3/8	3 3/8	10	4 7/8	3 7/16	3/4	41
	1-2	4 1/8	11 1/2	19 3/8	3 3/8	10 3/4	4 7/8	3 7/16	3/4	43
	1 3/4-2 3/4	4 1/8	11 1/2	19 3/8	3 3/8	11 1/2	4 7/8	3 7/16	3/4	43
	2 1/2-3 1/2	4 1/8	11 1/2	19 3/8	3 3/8	12 1/4	4 7/8	3 7/16	3/4	52
	3 1/4-4 1/4	4 1/8	11 1/2	19 3/8	3 3/8	13	4 7/8	3 7/16	3/4	60
8	0-1 1/2	4 1/2	13 15/16	22 1/2	3 3/4	10 1/2	5 1/8	3 3/8	1	70
	1-2	4 1/2	13 15/16	22 1/2	3 3/4	11	5 1/8	3 3/8	1	73
	2-3	4 1/2	13 15/16	22 1/2	3 3/4	12	5 1/8	3 3/8	1	77
	2 3/4-4	4 1/2	13 15/16	22 1/2	3 3/4	13	5 1/8	3 3/8	1	81
	3 3/4-5	4 1/2	13 15/16	22 1/2	3 3/4	14	5 1/8	3 3/8	1	85
12	0-2 1/2	6 1/2	18	28	3 7/8	13 1/2	6 1/4	3 7/8	1 1/4	140
	1/2-3	6 1/2	18	28	3 7/8	14	6 1/4	3 7/8	1 1/4	140
	2-4	6 1/2	18	28	3 7/8	15	6 1/4	3 7/8	1 1/4	143
	4-6	6 1/2	18	28	3 7/8	17	6 1/4	3 7/8	1 1/4	150
	5 1/2-7 1/2	6 1/2	18	28	3 7/8	18 1/2	6 1/4	3 7/8	1 1/4	160
20	1/2-3	7 1/2	22 3/4	35	4 15/16	17	7 3/8	5	2 1/2	265
	3-5	7 1/2	22 3/4	35	4 15/16	19	7 3/8	5	2 1/2	294
	5-7	7 1/2	22 3/4	35	4 15/16	21	7 3/8	5	2 1/2	324
	7-9	7 1/2	22 3/4	35	4 15/16	23	7 3/8	5	2 1/2	350
50*	1/2-3	8 3/8	27 3/8	41	4 3/4	22	9 3/4	6 3/8	3	470
100*	1/2-3	13 1/2	34	44	4 15/16	26	12 1/2	10 1/2	4	1350

SPECIFICATIONS ARE SUBJECT TO CHANGE WITHOUT NOTICE. OTHER CAPACITIES AVAILABLE UPON REQUEST.

*For handling heavy plate or hot material, see Model R.



Model SD

Locking Type

The **SD** is a vertical lifting clamp that incorporates two Model S clamps into one and is used for heavy duty work where it is desirable to spread the gripping surfaces with two points of contact. It incorporates a “Lock Open,” “Lock Closed” feature which facilitates attaching and removing the clamp from the plate.

MODEL SD EXPLODED VIEW

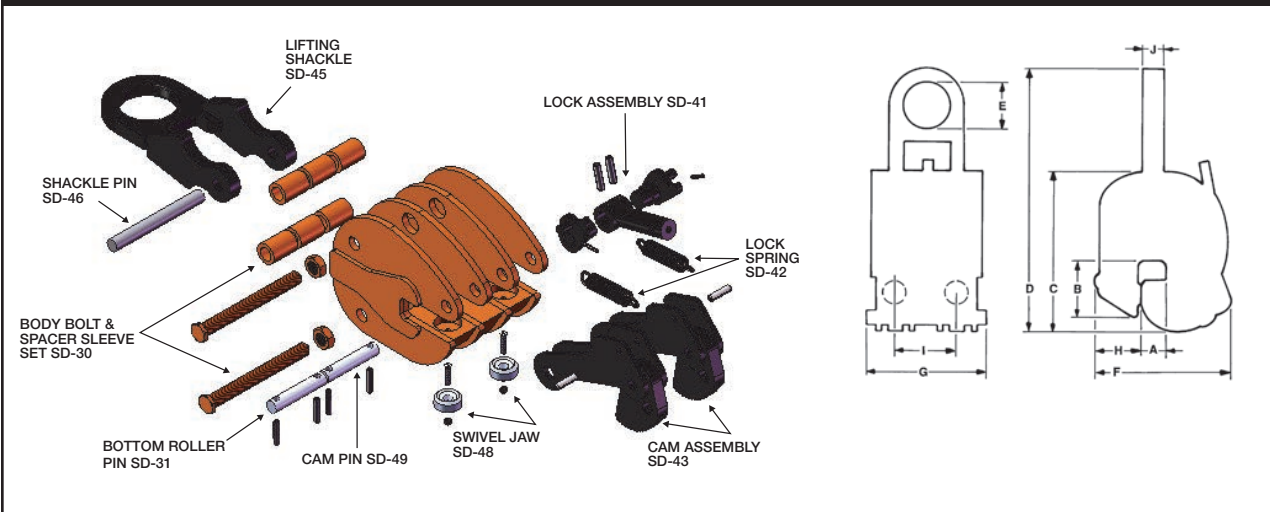

SPECIFICATIONS (in inches)

Rated Capacity Tons	Plate Thickness A	B	C	MAX. D	E	F	G	H	I	J	Weight (in pounds)
6	0-1	3¼	9½	15½	3	7½	6½	2⅞	4⅞	¾	60
	¾-1½	3¼	9½	15½	3	8	6½	2⅞	4⅞	¾	62
8	0-1¼	4½	11½	17	3	8¾	6¾	3	4¼	1	77
	1-2	4½	11½	17	3	9½	6¾	3	4¼	1	81

SPECIFICATIONS ARE SUBJECT TO CHANGE WITHOUT NOTICE. OTHER CAPACITIES AVAILABLE UPON REQUEST.



VERTICAL + 90





Model J Locking Type

The **Model J** is a vertical lifting clamp capable of turning a single plate or member from horizontal to vertical and back to horizontal through the same 90 degree arc.

MODEL J EXPLODED VIEW

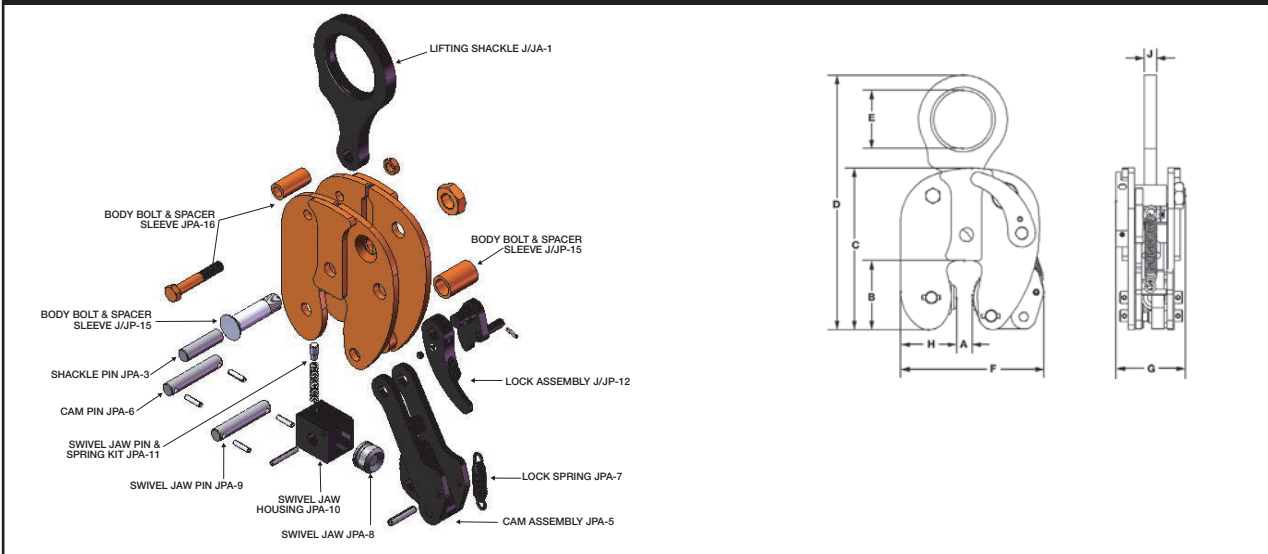

SPECIFICATIONS (in inches)

Rated Capacity Tons	Plate Thickness A	B	C	MAX. D	E	F	G	H	J	Weight (in pounds)
1/2	0-5/8	2 3/4	6 1/2	12	2 3/8	5 5/8	3 1/4	2 1/4	1/2	10
	1/2-1	2 3/4	6 1/2	12	2 3/8	6	3 1/4	2 1/4	1/2	
	3/4-1 1/4	2 3/4	6 1/2	12	2 3/8	6 1/4	3 1/4	2 1/4	1/2	
	1 1/4-1 3/4	2 3/4	6 1/2	12	2 3/8	6 3/4	3 1/4	2 1/4	1/2	
1	0-3/4	3 3/8	7 3/4	13 3/4	2 7/16	7	3 1/2	2 5/8	5/8	15
	1/2-1	3 3/8	7 3/4	13 3/4	2 7/16	7 1/4	3 1/2	2 5/8	5/8	
	3/4-1 1/4	3 3/8	7 3/4	13 3/4	2 7/16	8	3 1/2	2 5/8	5/8	
	1-1 1/2	3 3/8	7 3/4	13 3/4	2 7/16	8 1/4	3 1/2	2 5/8	5/8	
	1 1/2-2	3 3/8	7 3/4	13 3/4	2 7/16	8 3/4	3 1/2	2 5/8	5/8	
2	0-1	3 5/8	9 1/2	17 3/8	3 1/2	8 3/4	4 1/2	3	3/4	36
	3/4-1 1/2	3 5/8	9 1/2	17 3/8	3 1/2	9 1/4	4 1/2	3	3/4	
	1 1/4-2	3 5/8	9 1/2	17 3/8	3 1/2	9 3/4	4 1/2	3	3/4	
	2-2 3/4	3 5/8	9 1/2	17 3/8	3 1/2	10 1/2	4 1/2	3	3/4	
4	3/8-1 1/4	4 3/8	11 1/2	20 1/8	3 3/8	9 3/4	4 1/2	3 3/4	1 1/2	42
	1-2	4 3/8	11 1/2	20 1/8	3 3/8	10	4 1/2	3 3/4	1 1/2	
	2-3	4 3/8	11 1/2	20 1/8	3 3/8	11	4 1/2	3 3/4	1 1/2	
	3-4	4 3/8	11 1/2	20 1/8	3 3/8	12	4 1/2	3 3/4	1 1/2	
6	1/4-1 3/8	4 7/8	12 3/8	20 7/8	3 3/8	10 3/4	4 3/4	3 3/4	1 1/2	64
	1-2 1/8	4 7/8	12 3/8	20 7/8	3 3/8	11 1/2	4 3/4	3 3/4	1 1/2	
	2-3 1/8	4 7/8	12 3/8	20 7/8	3 3/8	12 1/2	4 3/4	3 3/4	1 1/2	
	3-4 1/8	4 7/8	12 3/8	20 7/8	3 3/8	13 1/2	4 3/4	3 3/4	1 1/2	
8	3/8-1 1/2	5 3/8	12 3/4	22 5/8	3 3/4	12 3/8	5 1/4	4 1/4	2	83
	1-2 1/8	5 3/8	12 3/4	22 5/8	3 3/4	13	5 1/4	4 1/4	2	
	2-3 1/8	5 3/8	12 3/4	22 5/8	3 3/4	14 3/8	5 1/4	4 1/4	2	
	3-4 1/8	5 3/8	12 3/4	22 5/8	3 3/4	15 3/8	5 1/4	4 1/4	2	
12	1/2-2 1/2	7 1/4	17 3/8	28 1/8	3 7/8	15 15/16	7 1/16	5 5/8	2	203
	2-4	7 1/4	17 3/8	28 1/8	3 7/8	17 1/16	7 1/16	5 5/8	2	212
	4-6	7 1/4	17 3/8	28 1/8	3 7/8	19 1/16	7 1/16	5 5/8	2	222
16	1 1/2-2 1/2	8	19 13/16	32 5/16	4 1/2	19 13/16	8 11/16	6 1/4	2 1/4	350
20	1 1/2-3	8 5/8	21 13/16	35 7/8	5	21	11 1/2	6 3/8	2 3/4	456
25	1 1/2-2 1/2	8 5/8	23 5/8	35 7/8	5	19 1/16	9 5/8	6 3/4	3	483
	3-5	8 5/8	23 5/8	35 7/8	5	21 9/16	9 5/8	6 3/4	3	495
	4-6	8 5/8	23 5/8	35 7/8	5	22 9/16	9 5/8	6 3/4	3	502
30	1 1/2-3	9 1/16	24 1/4	39 7/8	5	22 13/16	14 9/16	7 5/8	3	625
50	3-5	10 7/8	30 7/8	46 7/16	5	29 3/16	11 1/8	9 1/4	3 1/2	1306

Consult factory for possible larger capacities. SPECIFICATIONS ARE SUBJECT TO CHANGE WITHOUT NOTICE

Model L

Locking Type

The **Model L** is an ergonomic vertical lifting clamp capable of turning a single plate or member from horizontal to vertical and back to horizontal through the same 90 degree arc. The “Lock Open – Lock Closed” feature facilitates attaching and removing the clamp from the plate.



MODEL L EXPLODED VIEW

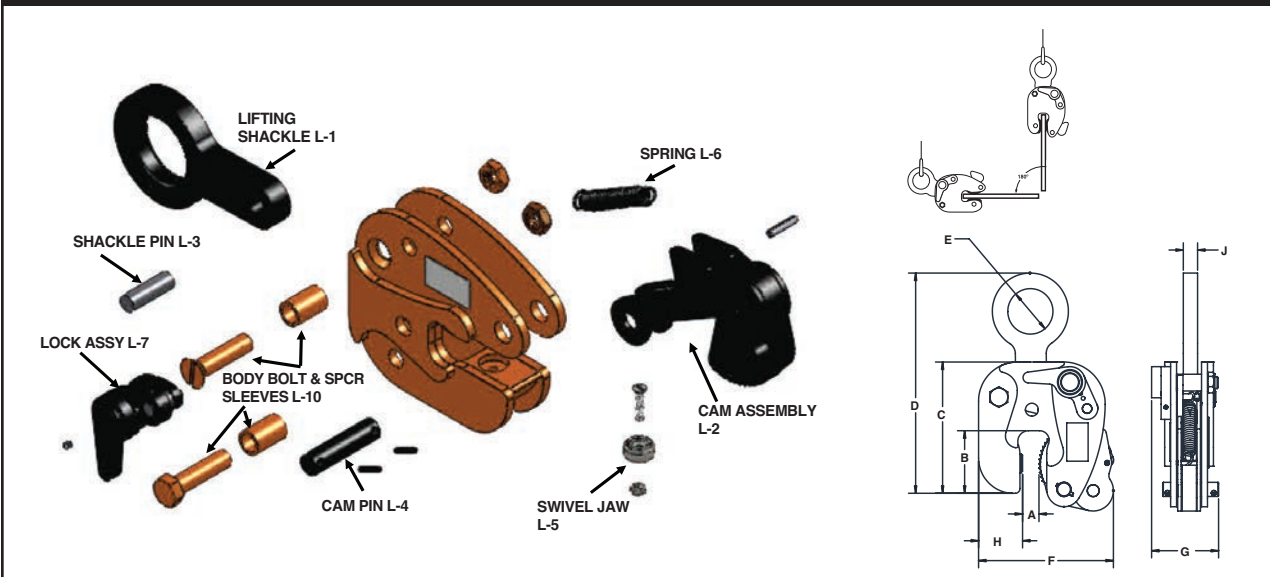

SPECIFICATIONS (in inches)

Rated Capacity Tons	Plate Thickness A	B	C	MAX. D	E	MAX. F	G	H	J	Weight (in pounds)
1/2	0-5/8	2	4 7/8	8	1 1/8	4 1/4	2 7/16	1 3/8	3/8	4 1/8
1	0-3/4	2	4 7/8	8	1 1/8	4 3/8	2 7/16	1 3/8	1/2	5 1/8
2	0-1	3 5/16	6 7/8	12 1/2	2 3/8	7 1/16	3 5/8	2 3/8	3/4	16 7/8
3	0-1	3 7/16	10	17	3 3/8	8 1/2	3 13/16	2 3/4	3/4	32

Consult factory for possible larger capacities. SPECIFICATIONS ARE SUBJECT TO CHANGE WITHOUT NOTICE



Model LJ

Locking Type

The **MODEL LJ** is a vertical lifting clamp capable of turning a plate from horizontal to vertical and back through the same ninety-degree arc. It is small and easy to handle in capacities through three tons. The Model LJ incorporates a “Lock Closed” feature, which facilitates attaching the clamp to the plate.

MODEL LJ EXPLODED VIEW

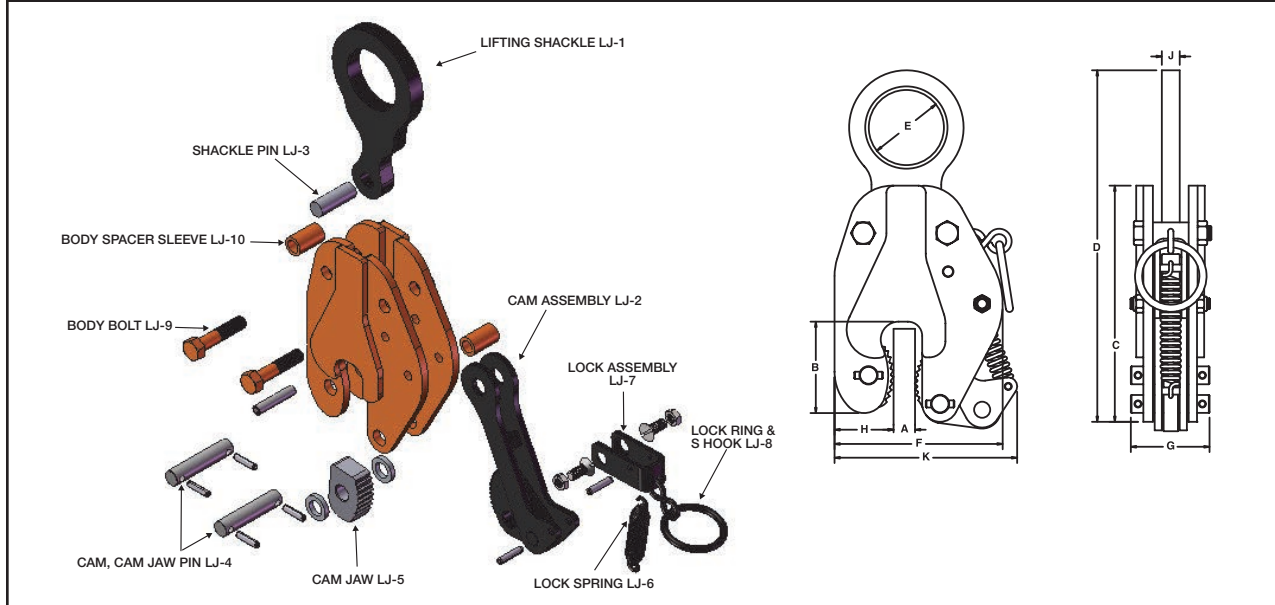

SPECIFICATIONS (in inches)

Rated Capacity Tons	Plate Thickness A	B	C	MAX. D	E	F	G	H	J	K	Weight (in pounds)
1/2	0-3/4	2 5/8	6 5/8	10 1/4	2 1/4	5	2 3/8	1 7/8	1/2	5	9
1	0-3/4	3 3/16	8 1/4	13 7/16	2 7/16	5 7/8	2 7/8	2 1/16	5/8	6 7/16	15
2	0-1	3 5/8	9	15 13/16	3 5/8	7 1/4	3 1/4	2 7/8	3/4	7 5/8	26
3	0-1 1/4	4 1/4	10 3/4	18	3 5/8	8 3/16	3 5/8	3	3/4	8 3/8	34

SPECIFICATIONS ARE SUBJECT TO CHANGE WITHOUT NOTICE.



Model TL

Locking Type

The **Model TL** is a vertical lifting clamp capable of turning a single plate or member from horizontal to vertical and back to horizontal through the same 90 degree arc.

MODEL TL EXPLODED VIEW

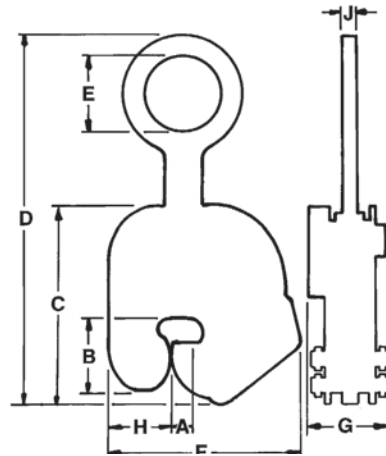
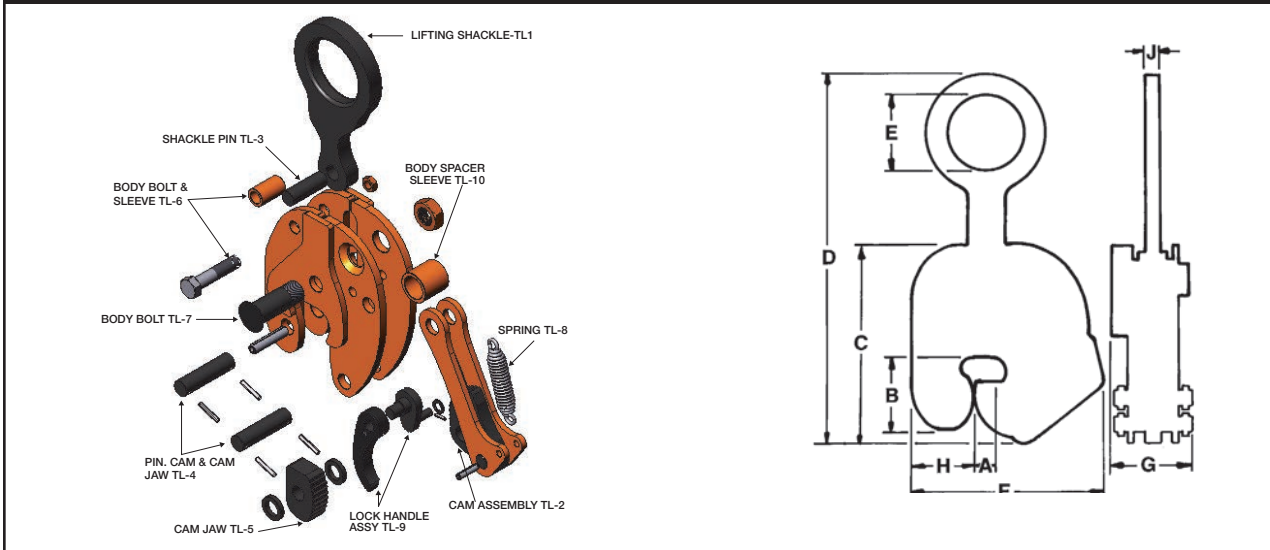

SPECIFICATIONS (in inches)

Rated Capacity Tons	Plate Thickness A	B	C	MAX. D	E	MAX. F	G	H	J	Weight (in pounds)
1/2	0-5/8	2 1/2	6 1/4	11 1/2	2 3/8	4 3/4	2 3/4	1 19/16	1/2	9
	1/2-1	2 3/8	6 1/4	11 1/2	2 3/8	5 1/2	2 3/4	1 19/16	1/2	10
	3/4-1 1/4	2 3/8	6 1/4	11 1/2	2 3/8	5 5/8	2 3/4	1 19/16	1/2	11
	1 1/4-1 3/4	2 3/8	6 1/4	11 1/2	2 3/8	5 5/8	2 3/4	1 19/16	1/2	13
1	0-3/4	3	7 1/2	13 1/2	2 7/16	6	2 13/16	2	5/8	14
	1/2-1	3	7 1/2	13 1/2	2 7/16	6 1/4	2 13/16	2	5/8	15
	3/4-1 1/4	3	7 1/2	13 1/2	2 7/16	6 1/2	2 13/16	2	5/8	16
	1-1 1/2	3	7 1/2	13 1/2	2 7/16	6 3/4	2 13/16	2	5/8	17
1 1/2-2	3	7 1/2	13 1/2	2 7/16	7 1/4	2 13/16	2	5/8	18	
2	0-1	3 1/2	9 3/8	16 1/4	3 3/8	8 3/8	3 3/8	2 7/8	3/4	32
	3/4-1 1/2	3 1/2	9 3/8	16 1/4	3 3/8	9 3/8	3 3/8	2 7/8	3/4	33
	1 1/4-2	3 1/2	9 3/8	16 1/4	3 3/8	9 3/8	3 3/8	2 7/8	3/4	35
	2-2 3/4	3 1/2	9 3/8	16 1/4	3 3/8	10 3/8	3 3/8	2 7/8	3/4	37
4	3/4-1 1/4	4	9 7/8	17 3/8	3 5/8	9	3 13/16	3	3/4	36
	1-2	4	9 7/8	17 3/8	3 5/8	9 3/4	3 13/16	3	3/4	37
	2-3	4	9 7/8	17 3/8	3 5/8	10 3/4	3 13/16	3	3/4	40
	3-4	4	9 7/8	17 3/8	3 5/8	11 3/4	3 13/16	3	3/4	43
6	1/2-1 3/4	4 3/8	11 1/2	20 1/2	3 1/2	10 1/4	3 7/8	3 3/8	3/4	49
	1-2 1/4	4 3/8	11 1/2	20 1/2	3 1/2	11	3 7/8	3 3/8	3/4	51
	2-3 1/4	4 3/8	11 1/2	20 1/2	3 1/2	12	3 7/8	3 3/8	3/4	54
	3-4 1/4	4 3/8	11 1/2	20 1/2	3 1/2	13	3 7/8	3 3/8	3/4	57
8	3/4-1 1/2	4 13/16	12 5/8	21 5/8	3 3/4	11 1/2	4 3/4	3 7/8	1	72
	1-2 1/4	4 13/16	12 5/8	21 5/8	3 3/4	12 1/2	4 3/4	3 7/8	1	74
	2-3 1/4	4 13/16	12 5/8	21 5/8	3 3/4	13 1/2	4 3/4	3 7/8	1	77
	3-4 1/4	4 13/16	12 5/8	21 5/8	3 3/4	14 1/2	4 3/4	3 7/8	1	80
12	1/2-2 1/2	6 1/4	15 1/2	26 3/8	3 7/8	14 1/2	6 3/4	4 3/8	1 3/4	142
	2-4	6 1/4	15 1/2	26 3/8	3 7/8	16	6 3/4	4 3/8	1 3/4	150
	3-5	6 1/4	15 1/2	26 3/8	3 7/8	17	6 3/4	4 3/8	1 3/4	154
	4-6	6 1/4	15 1/2	26 3/8	3 7/8	18	6 3/4	4 3/8	1 3/4	158
20	1/2-3	8 1/4	21 3/4	36 11/16	5	20 11/16	8 1/8	6 3/16	2 3/4	415
	2 1/2-4 1/2	8 1/4	21 3/4	36 11/16	5	22 3/16	8 1/8	6 3/16	2 3/4	426
	3-5	8 1/4	21 3/4	36 11/16	5	22 11/16	8 1/8	6 3/16	2 3/4	430
	5-7	8 1/4	21 3/4	36 11/16	5	24 11/16	8 1/8	6 3/16	2 3/4	445

Consult factory for possible larger capacities. SPECIFICATIONS ARE SUBJECT TO CHANGE WITHOUT NOTICE

VERTICAL + 90 + SIDE PULL





Model JP

Locking Type

The **Model JP** is a vertical lifting clamp capable of turning a single plate or member from horizontal to vertical and back to horizontal through the same 90 degree arc. Permits side loading of lifting shackle up to 90 degrees by derating of clamp's rated capacity. Refer to FIGURE 1 for derated capacities.

MODEL JP EXPLODED VIEW

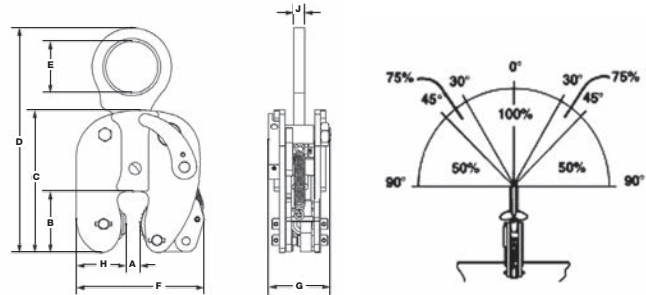
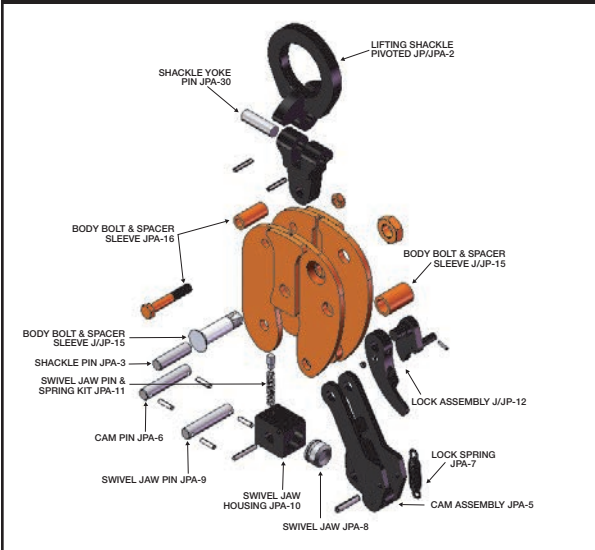

FIGURE 1

SPECIFICATIONS (in inches)

Rated Capacity Tons	Plate Thickness A	B	C	MAX. D	E	MAX. F	G	H	J	Weight (in pounds)
1/2	0-5/8	2 3/4	6 1/2	12	2 3/8	5 5/8	3 1/4	2 1/4	1 1/2	12
	1/2-1	2 3/4	6 1/2	12	2 3/8	6	3 3/4	2 1/4	1 1/2	
	3/4-1 1/4	2 3/4	6 1/2	12	2 3/8	6 1/4	3 3/4	2 1/4	1 1/2	
	1 1/4-1 1/2	2 3/4	6 1/2	12	2 3/8	6 3/4	3 3/4	2 1/4	1 1/2	
1	0-3/4	3 3/4	7 3/4	13 3/4	2 3/8	7	3 1/2	2 5/8	5/8	20
	1/2-1	3 3/4	7 3/4	13 3/4	2 3/8	7 1/4	3 1/2	2 5/8	5/8	
	3/4-1 1/4	3 3/4	7 3/4	13 3/4	2 3/8	8	3 1/2	2 5/8	5/8	
	1-1 1/2	3 3/4	7 3/4	13 3/4	2 3/8	8 1/4	3 1/2	2 5/8	5/8	
2	0-1	3 3/4	9 1/2	17 3/8	3 1/2	8 3/4	4 1/2	3	3/4	40
	3/4-1 1/2	3 3/4	9 1/2	17 3/8	3 1/2	9 1/4	4 1/2	3	3/4	
	1 1/4-2	3 3/4	9 1/2	17 3/8	3 1/2	9 3/4	4 1/2	3	3/4	
	2-2 1/4	3 3/4	9 1/2	17 3/8	3 1/2	10 1/2	4 1/2	3	3/4	
4	3/4-1 1/4	4 3/4	11 1/2	20 3/8	3 1/2	9 1/4	4 1/2	3 3/4	1 1/2	50
	1-2	4 3/4	11 1/2	20 3/8	3 1/2	10	4 1/2	3 3/4	1 1/2	
	2-3	4 3/4	11 1/2	20 3/8	3 1/2	11	4 1/2	3 3/4	1 1/2	
	3-4	4 3/4	11 1/2	20 3/8	3 1/2	12	4 1/2	3 3/4	1 1/2	
6	1/4-1 3/8	4 7/8	12 3/4	20 7/8	3 1/2	10 3/4	4 3/4	3 3/4	1 3/4	72
	1-2 1/8	4 7/8	12 3/4	20 7/8	3 1/2	11 1/2	4 3/4	3 3/4	1 3/4	
	2-3 1/8	4 7/8	12 3/4	20 7/8	3 1/2	12 1/2	4 3/4	3 3/4	1 3/4	
	3-4 1/8	4 7/8	12 3/4	20 7/8	3 1/2	13 1/2	4 3/4	3 3/4	1 3/4	
8	3/4-1 1/2	5 3/4	12 3/4	22 3/8	3 3/4	12 3/8	5 1/4	4 1/4	2	93
	1-2 1/8	5 3/4	12 3/4	22 3/8	3 3/4	13	5 1/4	4 1/4	2	
	2-3 1/8	5 3/4	12 3/4	22 3/8	3 3/4	14 3/8	5 1/4	4 1/4	2	
	3-4 1/8	5 3/4	12 3/4	22 3/8	3 3/4	15 3/8	5 1/4	4 1/4	2	
12	1/2-2 1/2	7 1/4	17 3/8	28 1/8	3 7/8	15 15/16	7 1/8	5 3/8	2	203
	2-4	7 1/4	17 3/8	28 1/8	3 7/8	17 7/16	7 1/8	5 3/8	2	212
	4-6	7 1/4	17 3/8	28 1/8	3 7/8	19 7/16	7 1/8	5 3/8	2	222
16	1/2-2 1/2	8	19 13/16	32 5/16	4 1/2	19 13/16	8 11/16	6 1/4	2 1/4	350
20	1/2-3	8 5/8	21 13/16	35 7/8	5	21	11 1/2	6 7/8	2 3/4	456
25	1/2-2 1/2	8 5/8	23 5/8	35 7/8	5	19 1/16	9 5/8	6 3/4	3	483
	3-5	8 5/8	23 5/8	35 7/8	5	21 1/16	9 5/8	6 3/4	3	495
	4-6	8 5/8	23 5/8	35 7/8	5	22 9/16	9 5/8	6 3/4	3	502
30	1/2-3	9 9/16	24 1/4	39 7/8	5	22 13/16	14 9/16	7 5/8	3	625
50	3-5	10 7/8	30 7/8	46 7/16	5	29 3/16	11 1/8	9 1/4	3 1/2	1306

Consult factory for possible larger capacities. SPECIFICATIONS ARE SUBJECT TO CHANGE WITHOUT NOTICE

VERTICAL + 90 + SIDE PULL



Model LP

Locking Type

The **Model LP** is an ergonomic vertical lifting clamp capable of turning a single plate or member from horizontal to vertical and back to horizontal through the same 90 degree arc. Permits side loading of lifting shackle to 90 degrees by de-rating of clamp's capacity. Refer to FIGURE 1 for de-rated capacities. The "Lock Open – Lock Closed" feature facilitates attaching and removing the clamp from the plate.

Model LP incorporates a pivoting shackle that permits side loading of the lifting shackle at 100 percent of rated capacity from vertical to 30 degrees, 75 percent of rated capacity between 30 and 45 degrees, and 50 percent of rated capacity between 45 and 90 degrees.

MODEL LP EXPLODED VIEW

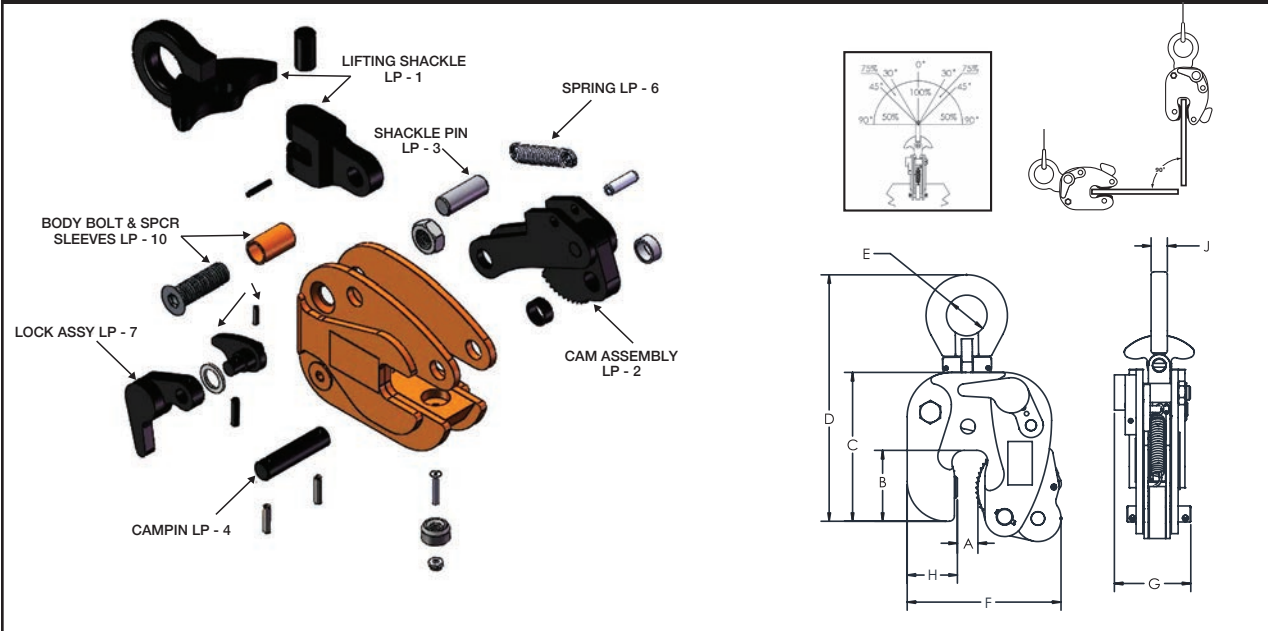

VERTICAL + 90 + SIDE PULL

SPECIFICATIONS (in inches)

Rated Capacity Tons	Plate Thickness A	B	C	MAX. D	E	MAX. F	G	H	J	Weight (in pounds)
1/2	0-5/8	2	5 1/16	8 11/16	1 1/8	4 1/4	2 7/16	1 3/8	3/8	4 1/8
1	0-3/4	2	5 1/8	8 11/16	1 1/8	4 3/8	2 7/16	1 3/8	1/2	5 1/8
2	0-1	3 5/16	6 7/8	12 1/2	1 7/8	7 1/16	3 5/8	2 3/8	3/4	16 7/8
3	0-1	3 7/16	10	17	3 3/8	8 1/2	3 13/16	2 3/4	3/4	32

Consult factory for possible larger capacities. SPECIFICATIONS ARE SUBJECT TO CHANGE WITHOUT NOTICE



VERTICAL + 180





Model JA

Locking Type

The **Model JA** is a vertical lifting clamp capable of turning a single plate or member from horizontal to vertical through a 180 degree arc. It incorporates a push button auxiliary lock.

MODEL JA EXPLODED VIEW

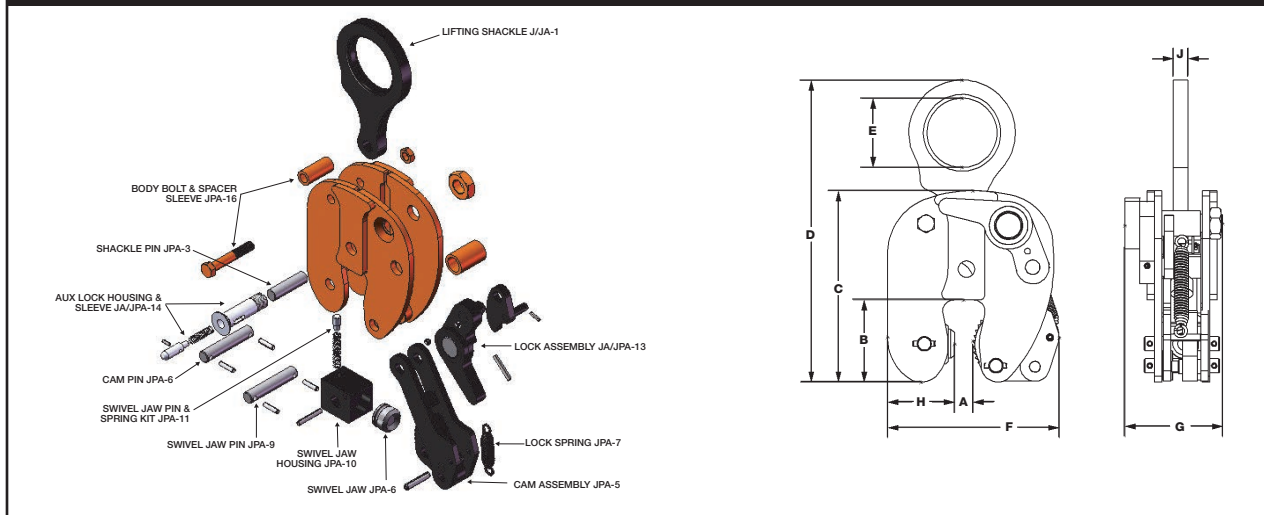

SPECIFICATIONS (in inches)

Rated Capacity Tons	Plate Thickness A	B	C	MAX. D	E	MAX. F	G	H	J	Weight (in pounds)
1/2	0-5/8	2 3/4	6 1/2	12	2 3/8	5 5/8	3 1/4	2 1/4	1/2	10
	1/2-1	2 3/4	6 1/2	12	2 3/8	6	3 1/4	2 1/4	1/2	
	3/4-1 1/4	2 3/4	6 1/2	12	2 3/8	6 1/4	3 1/4	2 1/4	1/2	
	1 1/4-1 3/4	2 3/4	6 1/2	12	2 3/8	6 3/4	3 1/4	2 1/4	1/2	
1	0-3/4	3 3/8	7 3/4	13 3/4	2 7/16	7	3 1/2	2 5/8	5/8	15
	1/2-1	3 3/8	7 3/4	13 3/4	2 7/16	7 1/4	3 1/2	2 5/8	5/8	
	3/4-1 1/4	3 3/8	7 3/4	13 3/4	2 7/16	8	3 1/2	2 5/8	5/8	
	1-1 1/2	3 3/8	7 3/4	13 3/4	2 7/16	8 1/4	3 1/2	2 5/8	5/8	
	1 1/2-2	3 3/8	7 3/4	13 3/4	2 7/16	8 3/4	3 1/2	2 5/8	5/8	
2	0-1	3 5/8	9 1/2	17 3/8	3 1/2	8 3/4	4 1/2	3	3/4	36
	3/4-1 1/2	3 5/8	9 1/2	17 3/8	3 1/2	9 1/4	4 1/2	3	3/4	
	1 1/4-2	3 5/8	9 1/2	17 3/8	3 1/2	9 3/4	4 1/2	3	3/4	
	2-2 3/4	3 5/8	9 1/2	17 3/8	3 1/2	10 1/2	4 1/2	3	3/4	
4	3/4-1 1/4	4 3/8	11 1/2	20 1/8	3 1/2	9 1/4	4 1/2	3 1/4	1 1/2	42
	1-2	4 3/8	11 1/2	20 1/8	3 1/2	10	4 1/2	3 1/4	1 1/2	
	2-3	4 3/8	11 1/2	20 1/8	3 1/2	11	4 1/2	3 1/4	1 1/2	
	3-4	4 3/8	11 1/2	20 1/8	3 1/2	12	4 1/2	3 1/4	1 1/2	
6	1/4-1 3/8	4 7/8	12 3/4	20 7/8	3 1/2	10 3/4	4 3/4	3 3/4	1 1/2	64
	1-2 1/8	4 7/8	12 3/4	20 7/8	3 1/2	11 1/2	4 3/4	3 3/4	1 1/2	
	2-3 1/8	4 7/8	12 3/4	20 7/8	3 1/2	12 1/2	4 3/4	3 3/4	1 1/2	
	3-4 1/8	4 7/8	12 3/4	20 7/8	3 1/2	13 1/2	4 3/4	3 3/4	1 1/2	
8	3/8-1 1/2	5 3/8	12 3/4	22 5/8	3 3/4	12 3/8	5 1/4	4 1/4	2	83
	1-2 1/8	5 3/8	12 3/4	22 5/8	3 3/4	13	5 1/4	4 1/4	2	
	2-3 1/8	5 3/8	12 3/4	22 5/8	3 3/4	14 3/8	5 1/4	4 1/4	2	
	3-4 1/8	5 3/8	12 3/4	22 5/8	3 3/4	15 3/8	5 1/4	4 1/4	2	
12	1/2-2 1/2	7 1/4	17 3/8	28 1/8	3 7/8	15 15/16	7 1/16	5 3/8	2	203
	2-4	7 1/4	17 3/8	28 1/8	3 7/8	17 7/16	7 1/16	5 3/8	2	212
	4-6	7 1/4	17 3/8	28 1/8	3 7/8	19 1/16	7 1/16	5 3/8	2	222
16	1/2-2 1/2	8	19 13/16	32 5/16	4 1/2	19 13/16	8 11/16	6 1/4	2 1/4	350
20	1/2-3	8 5/8	21 13/16	35 7/8	5	21	11 1/2	6 7/8	2 3/4	456
25	1/2-2 1/2	8 5/8	23 5/8	35 7/8	5	19 1/16	9 5/8	6 3/4	3	483
	3-5	8 5/8	23 5/8	35 7/8	5	21 1/16	9 5/8	6 3/4	3	495
	4-6	8 5/8	23 5/8	35 7/8	5	22 3/16	9 5/8	6 3/4	3	502
30	1/2-3	9 3/16	24 1/4	39 7/8	5	22 13/16	14 3/16	7 5/8	3	625
50	3-5	10 7/8	30 3/8	46 7/8	5	29 3/16	11 1/8	9 1/4	3 1/2	1306

Consult factory for possible larger capacities. SPECIFICATIONS ARE SUBJECT TO CHANGE WITHOUT NOTICE

Model LA

Locking Type

Model LA is an ergonomic vertical lifting clamp capable of turning a single plate or member from horizontal to vertical to horizontal through a 180 degree arc. It incorporates a push button auxiliary lock. The “Lock Open – Lock Closed” feature facilitates attaching and removing the clamp from the plate.



MODEL LA EXPLODED VIEW

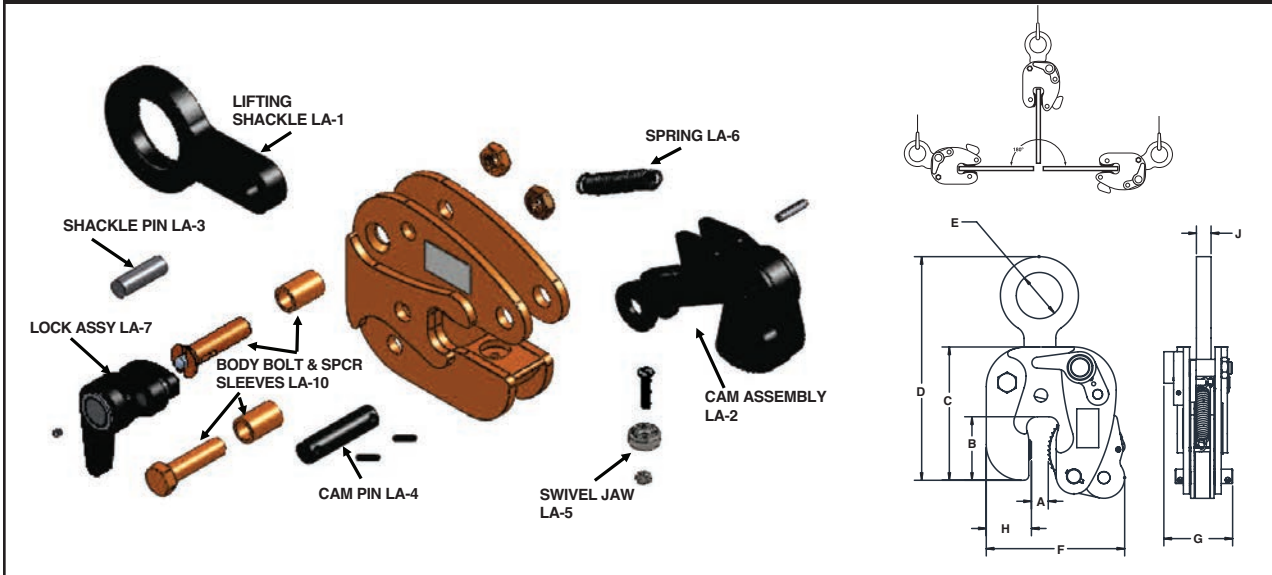

SPECIFICATIONS (in inches)

Rated Capacity Tons	Plate Thickness A	B	C	MAX. D	E	MAX. F	G	H	J	Weight (in pounds)
1/2	0-5/8	2	4 7/8	8	1 1/8	4 1/4	2 7/16	1 3/8	3/8	4 1/8
1	0-3/4	2	4 7/8	8	1 1/8	4 3/8	2 7/16	1 3/8	1/2	5 1/8
2	0-1	3 5/16	6 7/8	12 1/2	2 3/8	7 1/16	3 5/8	2 3/8	3/4	16 7/8
3	0-1	3 7/16	10	17	3 3/8	8 1/2	3 13/16	2 3/4	3/4	32

Consult factory for possible larger capacities. SPECIFICATIONS ARE SUBJECT TO CHANGE WITHOUT NOTICE

VERTICAL + 180



Model PCK-SL

Locking, Screw Type



The **PCK-SL** Locking Screw Clamp is a versatile multi-purpose lifting turning pulling clamp capable of lift and turn operations from the horizontal through 180 degrees arc. The clamp can also be used for the assembling of steel plates, structural members and welded sections. The clamp is generally used in pairs for the purpose of drawing two plates or members together or to a predetermined position adjacent to each other. The adjusting screw is used to accommodate various thicknesses of material and to facilitate the attachment of the clamp to the member being worked on.

MODEL PCK-SL EXPLODED VIEW

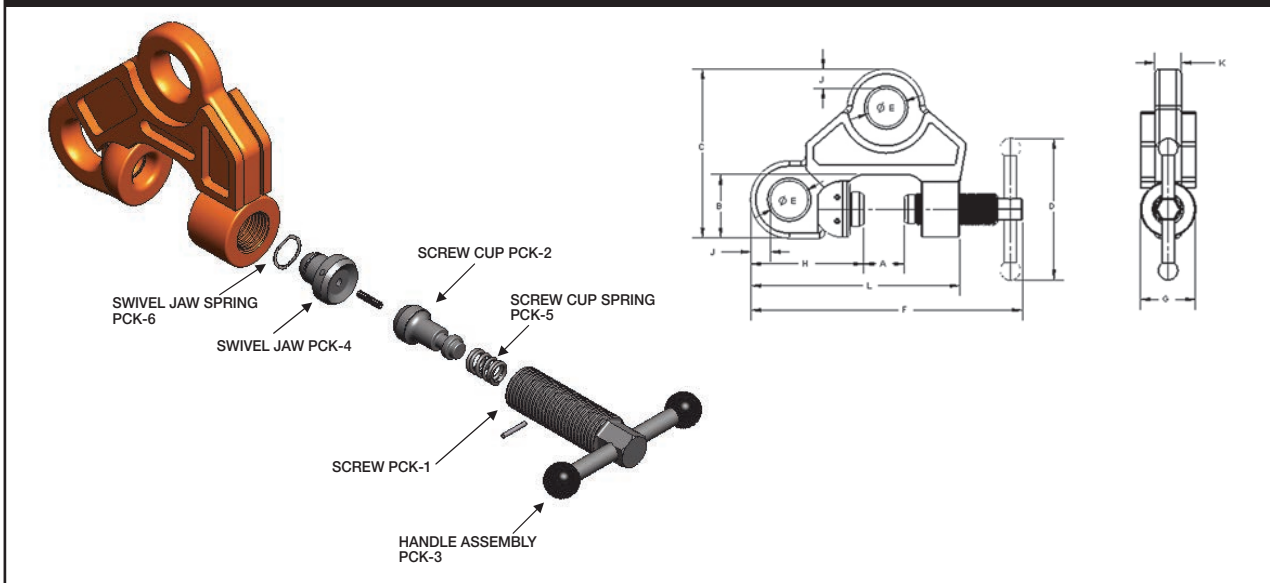

SPECIFICATIONS (in inches)

Capacity Tons	Plate Thickness A	B	C	D	E	F	G	H	J	K	L	Weight (in pounds)
1/2	0-1	2½	5½	5 ¹¹ / ₁₆	1	9½	1¾	3	1/2	5 ⁵ / ₁₆	6½	4.6
1	0-1½	3	6¾	5 ¹¹ / ₁₆	1¾	10½	2½	4 ¹ / ₃₂	1 ¹ / ₁₆	¾	7 ⁵ / ₈	9.6
2	0-1½	3 ³ / ₁₆	7½	7	1½	11½	2¾	4 ⁹ / ₁₆	¾	1	8½	14.5
3	¾-1¾	3½	8	6 ¹¹ / ₁₆	1¾	12½	2 ⁵ / ₈	5 ³ / ₈	7 ⁷ / ₈	1½	9½	17.9
5	0-1½	3 ¹³ / ₁₆	9 ⁵ / ₁₆	7¾	2	13¾	2 ⁷ / ₈	5 ⁷ / ₈	1	1¾	10	28.4

SPECIFICATIONS ARE SUBJECT TO CHANGE WITHOUT NOTICE.

Model RSC

Locking, Screw Type

The **Model RSC** is a lightweight screw clamp for bench work on steel plates of large thickness, and weighing less than 1,000 lbs.



MODEL RSC EXPLODED VIEW

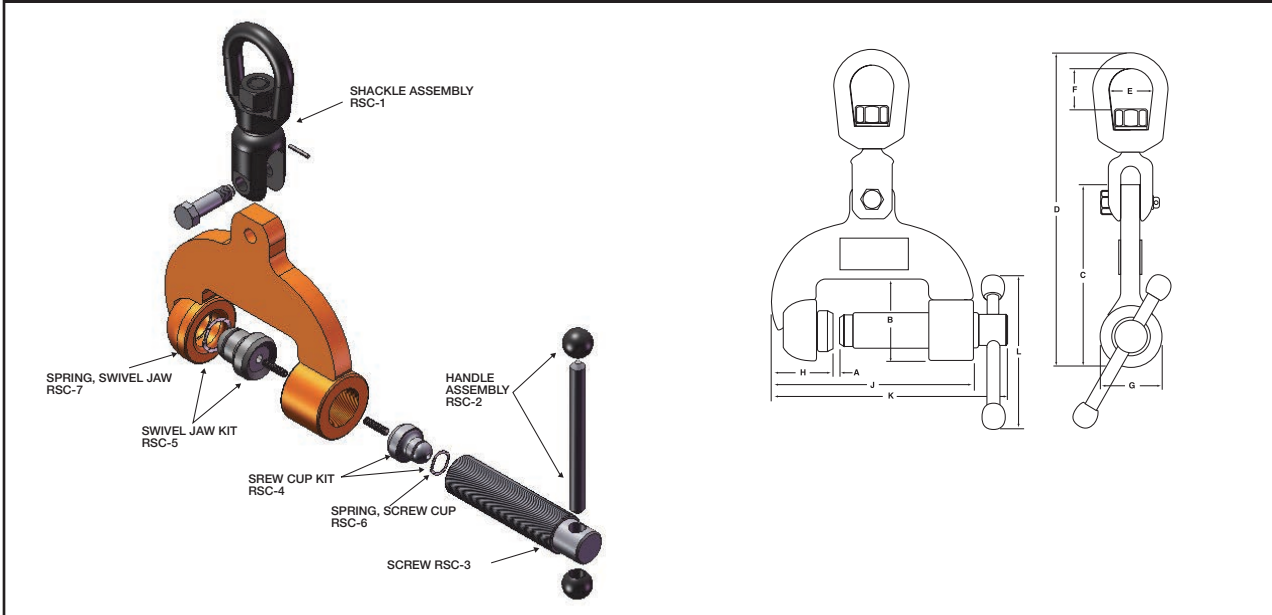

SPECIFICATIONS (in inches)

Rated Capacity Tons	Plate Thickness A	B	C	D	E	F	G	H	J	K	L	Weight (in pounds)
1/2	0-3	3 ³ / ₁₆	7	12 ³ / ₁₆	1 ³ / ₄	1 ⁹ / ₁₆	2 ³ / ₈	2 ³ / ₈	7 ⁷ / ₈	11 ⁷ / ₈	6 ³ / ₄	13 ¹ / ₂
1/2	1 ³ / ₈ -4 ¹ / ₄	3 ³ / ₁₆	7 ⁵ / ₁₆	12 ⁵ / ₁₆	1 ³ / ₄	1 ⁹ / ₁₆	2 ³ / ₈	2 ³ / ₈	9 ¹ / ₄	13 ¹ / ₈	6 ³ / ₄	16 ¹ / ₂

SPECIFICATIONS ARE SUBJECT TO CHANGE WITHOUT NOTICE.

VERTICAL + 180



Model SCP

Locking, Screw Type

The **Model SCP** clamp is capable of handling steel plate from horizontal to vertical to horizontal through a 180 degree arc and may be used for handling plate at rolling and forming machines. These clamps feature a spring loaded pivoting cam jaw that “cams in” when a load is applied to the lifting shackle. Clamp is capable of handling plate horizontally when used in pairs or sets of pairs, or in a tripod arrangement.

MODEL SCP EXPLODED VIEW

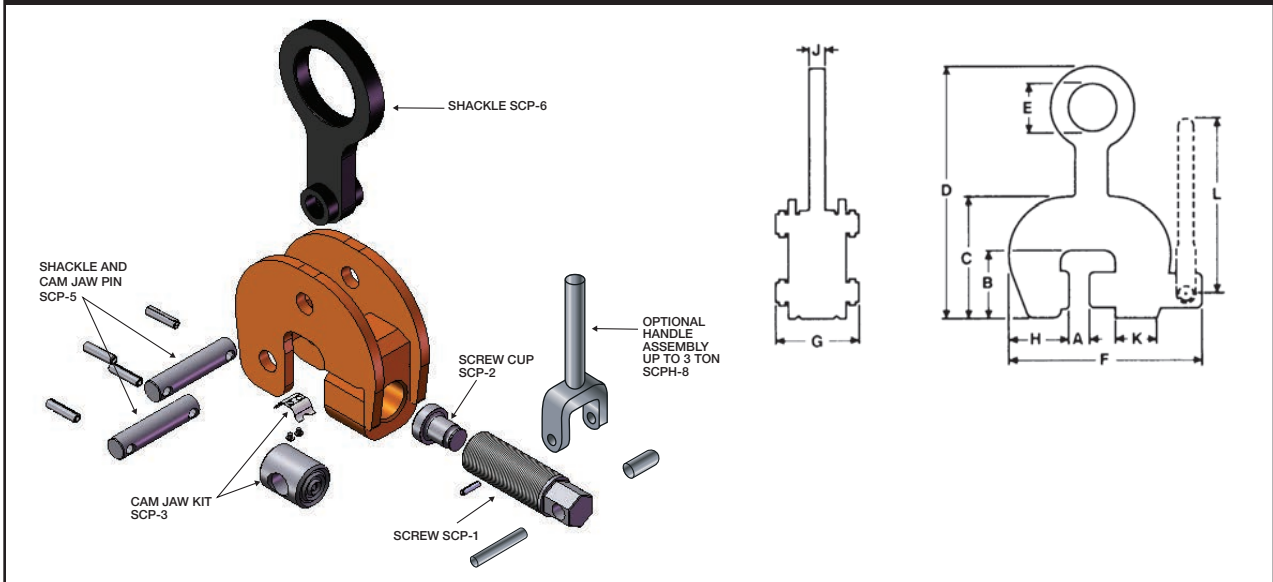

SPECIFICATIONS (in inches)

Rated Capacity Tons	Plate Thickness A	B	C	D	E	F	G	H	J	K	L	Weight (in pounds)
1/2	0-3/4	2 3/8	4 1/2	9	2 3/8	6 5/8	2 3/8	1 7/8	1/2	1 1/2	—	7
1 1/2	0-1 1/4	2 7/8	5 1/2	10 9/16	2 5/8	8 7/16	3 3/8	2 3/8	5/8	1 3/4	8 1/4	13
3	0-2	3 1/8	5 3/4	12	2 3/8	10 13/16	4 1/16	2 13/16	3/4	2	8 5/8	19
6	0-2 1/2	4 5/16	7 9/16	14 3/8	3	14 3/8	5 3/8	3 7/16	1	2 15/16	—	44
10	0-3	5 1/2	9 3/4	19 1/4	3 1/4	16 3/8	6 3/4	4 3/8	1	3 1/8	—	93
15	0-4	7 1/4	12 1/8	22 7/8	3 3/4	21 1/2	8 1/4	5 9/16	1 1/4	4	—	210

20, 30, 50, 100 and 150 Ton capacities available upon request. SPECIFICATIONS ARE SUBJECT TO CHANGE WITHOUT NOTICE.

Model SCSM

Locking, Screw Type

The **MODEL SCSM** is a locking screw clamp capable of handling a steel plate from horizontal to vertical to horizontal through a 180-degree arc. It is a lightweight clamp primarily used for bench work. It is capable of handling up to a 2,000-pound load.



MODEL SCSM EXPLODED VIEW

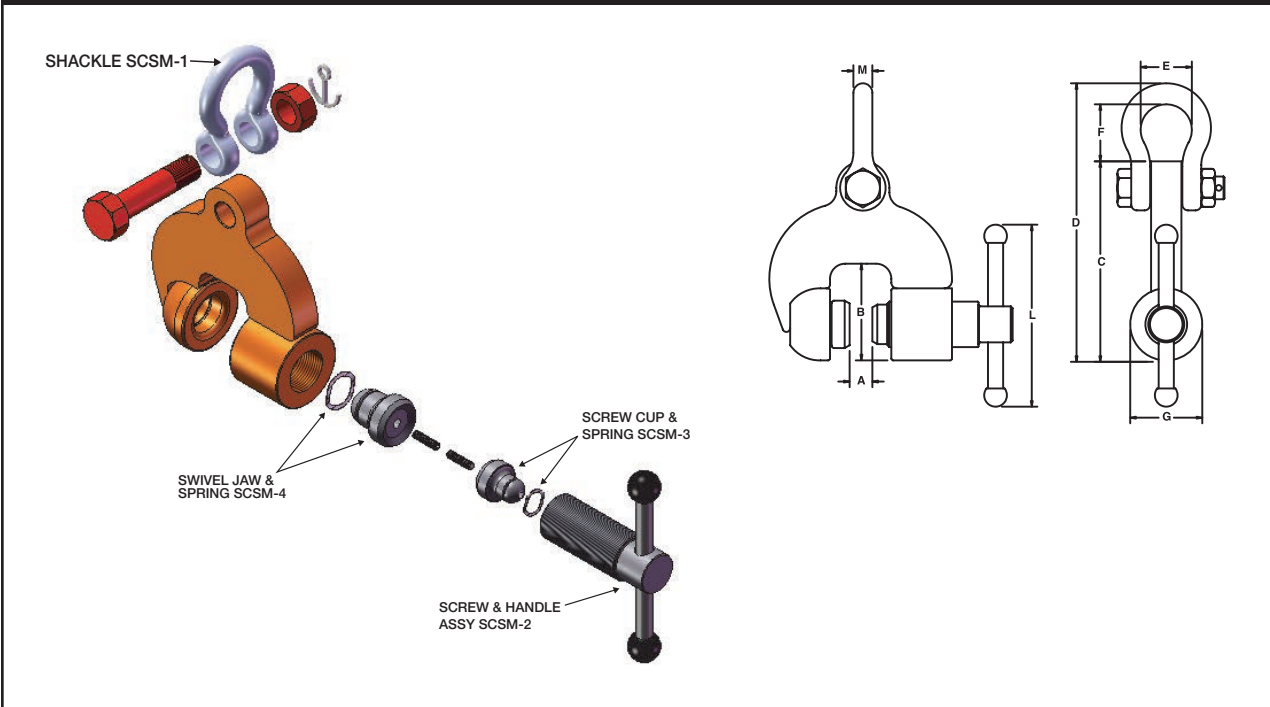

SPECIFICATIONS (in inches)

Rated Capacity Tons	Plate Thickness A	B	C	D	E	F	G	L	M	Weight (in pounds)
1	0-3/4	3/4	6 5/8	9 3/16	1 11/16	1 7/8	2 1/2	6	5/8	12

SPECIFICATIONS ARE SUBJECT TO CHANGE WITHOUT NOTICE.



Model TLA Locking Type

The **Model TLA** is a vertical lifting clamp incorporating a “Lock Open” and a “Lock Closed” feature and an auxiliary push button lock. The clamp is capable of turning a steel plate from horizontal to vertical to horizontal through a 180 degree arc. The “Lock Open,” “Lock Closed” feature facilitates attaching and removing the clamp from the plate.

MODEL TLA EXPLODED VIEW

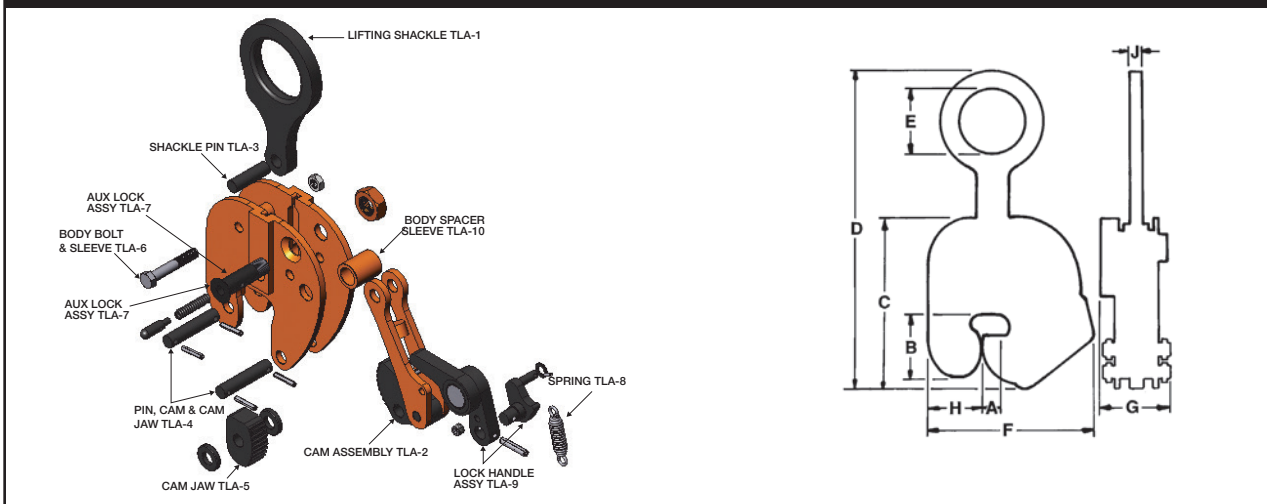

SPECIFICATIONS (in inches)

Rated Capacity Tons	Plate Thickness A	B	C	MAX. D	E	MAX. F	G	H	J	Weight (in pounds)
1/2	0-5/8	2 3/8	6 1/4	11 1/8	2 3/8	4 3/4	2 3/4	1 13/16	1/2	9
	1/2-1	2 3/8	6 1/4	11 1/8	2 3/8	5 1/8	2 3/4	1 13/16	1/2	10
	3/4-1 1/4	2 3/8	6 1/4	11 1/8	2 3/8	5 3/8	2 3/4	1 13/16	1/2	11
	1-1 1/4	2 3/8	6 1/4	11 1/8	2 3/8	5 3/8	2 3/4	1 13/16	1/2	13
1	0-3/4	3	7 1/2	13 1/8	2 7/16	6	2 13/16	2	5/8	14
	1/2-1	3	7 1/2	13 1/8	2 7/16	6 1/4	2 13/16	2	5/8	15
	3/4-1 1/4	3	7 1/2	13 1/8	2 7/16	6 1/2	2 13/16	2	5/8	16
	1-1 1/2	3	7 1/2	13 1/8	2 7/16	6 3/4	2 13/16	2	5/8	17
	1 1/2-2	3	7 1/2	13 1/8	2 7/16	7 1/4	2 13/16	2	5/8	18
2	0-1	3 1/2	9 3/8	16 1/4	3 5/8	8 7/8	3 3/4	2 7/8	3/4	32
	3/4-1 1/2	3 1/2	9 3/8	16 1/4	3 5/8	9 3/8	3 3/4	2 7/8	3/4	33
	1 1/4-2	3 1/2	9 3/8	16 1/4	3 5/8	9 3/4	3 3/4	2 7/8	3/4	35
	2-2 3/4	3 1/2	9 3/8	16 1/4	3 5/8	10 5/8	3 3/4	2 7/8	3/4	37
4	3/4-1 1/4	4	9 7/8	17 3/8	3 5/8	9	3 13/16	3	3/4	36
	1-2	4	9 7/8	17 3/8	3 5/8	9 3/4	3 13/16	3	3/4	37
	2-3	4	9 7/8	17 3/8	3 5/8	10 3/4	3 13/16	3	3/4	40
	3-4	4	9 7/8	17 3/8	3 5/8	11 1/4	3 13/16	3	3/4	43
6	1/2-1 3/8	4 3/8	11 1/8	20 1/8	3 1/2	10 1/4	3 3/8	3 3/8	3/4	49
	1-2 1/8	4 3/8	11 1/8	20 1/8	3 1/2	11	3 3/8	3 3/8	3/4	51
	2-3 3/8	4 3/8	11 1/8	20 1/8	3 1/2	12	3 3/8	3 3/8	3/4	54
	3-4 3/8	4 3/8	11 1/8	20 1/8	3 1/2	13	3 3/8	3 3/8	3/4	57
8	3/4-1 1/2	4 13/16	12 5/16	21 5/16	3 3/4	11 1/2	4 3/8	3 3/8	1	72
	1-2 1/8	4 13/16	12 5/16	21 5/16	3 3/4	12 1/8	4 3/8	3 3/8	1	74
	2-3 3/8	4 13/16	12 5/16	21 5/16	3 3/4	13 1/8	4 3/8	3 3/8	1	77
	3-4 3/8	4 13/16	12 5/16	21 5/16	3 3/4	14 1/8	4 3/8	3 3/8	1	80
12	1/2-2 1/2	6 1/4	15 1/8	26 3/16	3 7/8	14 1/2	6 3/4	4 3/8	1 3/4	142
	2-4	6 1/4	15 1/8	26 3/16	3 7/8	16	6 3/4	4 3/8	1 3/4	150
	3-5	6 1/4	15 1/8	26 3/16	3 7/8	17	6 3/4	4 3/8	1 3/4	154
	4-6	6 1/4	15 1/8	26 3/16	3 7/8	18	6 3/4	4 3/8	1 3/4	158
20	1/2-3	8 1/8	21 3/4	36 11/16	5	20 11/16	8 1/8	6 3/16	2 3/4	415
	2 1/2-4 1/2	8 1/8	21 3/4	36 11/16	5	22 3/16	8 1/8	6 3/16	2 3/4	426
	3-5	8 1/8	21 3/4	36 11/16	5	22 11/16	8 1/8	6 3/16	2 3/4	430
	5-7	8 1/8	21 3/4	36 11/16	5	24 11/16	8 1/8	6 3/16	2 3/4	445

Consult factory for possible larger capacities. SPECIFICATIONS ARE SUBJECT TO CHANGE WITHOUT NOTICE

VERTICAL + 180 + SIDE PULL





Model JPA

Locking Type

The **Model JPA** is a vertical lifting clamp capable of turning a single plate or member from horizontal to vertical through a 180 degree arc. Incorporates a push button auxiliary lock. Permits side loading of lifting shackle to 90 degrees by derating of clamp's rated capacity. Refer to FIGURE 1 for derated capacities.

MODEL JPA EXPLODED VIEW

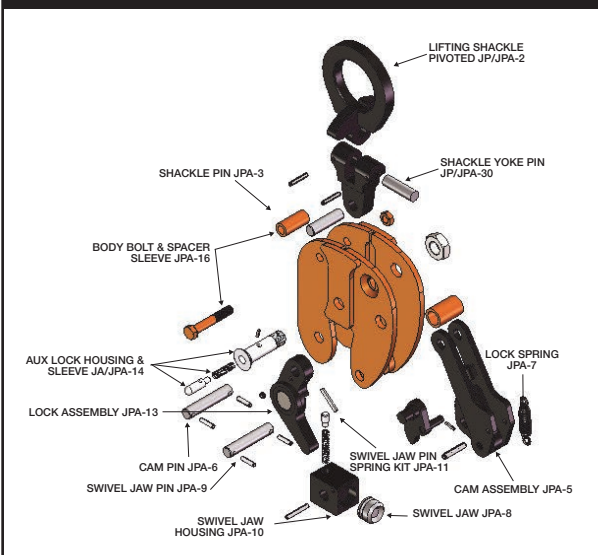

Model JPA incorporates a pivoting shackle that permits side loading of the lifting shackle at 100 percent of rated capacity from vertical to 30 degrees, 75 percent of rated capacity between 30 and 45 degrees and 50 percent of rated capacity between 45 and 90 degrees.

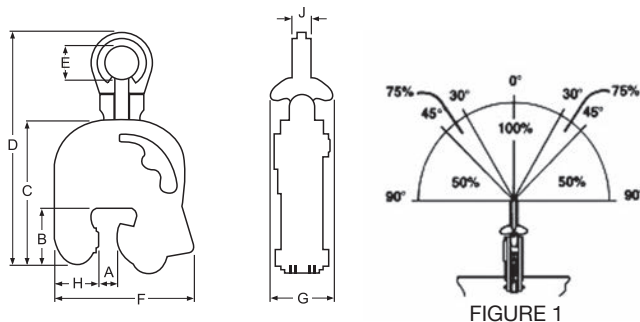

FIGURE 1

SPECIFICATIONS (in inches)

Rated Capacity Tons	Plate Thickness A	B	C	MAX. D	E	MAX. F	G	H	J	Weight (in pounds)
1/2	0-3/8	2 3/4	6 1/2	12	2 3/8	5 5/8	3 1/4	2 1/4	1 1/2	12
	3/8-1	2 3/4	6 1/2	12	2 3/8	6	3 1/4	2 1/4	1 1/2	
	1-1 1/4	2 3/4	6 1/2	12	2 3/8	6 1/4	3 1/4	2 1/4	1 1/2	
	1 1/4-1 3/4	2 3/4	6 1/2	12	2 3/8	6 3/4	3 1/4	2 1/4	1 1/2	
1	0-3/4	3 3/8	7 3/4	13 3/4	2 5/8	7	3 1/2	2 5/8	5/8	20
	3/4-1 1/4	3 3/8	7 3/4	13 3/4	2 5/8	7 1/4	3 1/2	2 5/8	5/8	
	1-1 1/2	3 3/8	7 3/4	13 3/4	2 5/8	8	3 1/2	2 5/8	5/8	
	1 1/2-2	3 3/8	7 3/4	13 3/4	2 5/8	8 1/4	3 1/2	2 5/8	5/8	
2	0-1	3 5/8	9 1/2	17 3/8	3 1/2	8 3/4	4 1/2	3	3/4	40
	1-1 1/2	3 5/8	9 1/2	17 3/8	3 1/2	9 1/4	4 1/2	3	3/4	
	1 1/2-2	3 5/8	9 1/2	17 3/8	3 1/2	9 3/4	4 1/2	3	3/4	
	2-2 3/4	3 5/8	9 1/2	17 3/8	3 1/2	10 1/2	4 1/2	3	3/4	
4	3/8-1 1/4	4 3/8	11 1/2	20 1/8	3 1/2	9 1/4	4 1/2	3 3/4	1 1/2	50
	1-2	4 3/8	11 1/2	20 1/8	3 1/2	10	4 1/2	3 3/4	1 1/2	
	2-3	4 3/8	11 1/2	20 1/8	3 1/2	11	4 1/2	3 3/4	1 1/2	
	3-4	4 3/8	11 1/2	20 1/8	3 1/2	12	4 1/2	3 3/4	1 1/2	
6	1/4-1 3/8	4 7/8	12 3/8	20 7/8	3 1/2	10 3/4	4 3/4	3 3/4	1 3/4	72
	1-2 1/8	4 7/8	12 3/8	20 7/8	3 1/2	11 1/2	4 3/4	3 3/4	1 3/4	
	2-3 1/8	4 7/8	12 3/8	20 7/8	3 1/2	12 1/2	4 3/4	3 3/4	1 3/4	
	3-4 1/8	4 7/8	12 3/8	20 7/8	3 1/2	13 1/2	4 3/4	3 3/4	1 3/4	
8	3/8-1 1/2	5 3/8	12 3/4	22 3/8	3 3/4	12 3/8	5 1/4	4 1/4	2	93
	1-2 1/4	5 3/8	12 3/4	22 3/8	3 3/4	13	5 1/4	4 1/4	2	
	2-3 1/4	5 3/8	12 3/4	22 3/8	3 3/4	14 3/8	5 1/4	4 1/4	2	
	3-4 1/4	5 3/8	12 3/4	22 3/8	3 3/4	15 3/8	5 1/4	4 1/4	2	
12	1/2-2 1/2	7 1/4	17 3/8	28 1/8	3 7/8	15 15/16	7 1/16	5 5/8	2	203
	2-4	7 1/4	17 3/8	28 1/8	3 7/8	17 7/16	7 1/16	5 5/8	2	212
	4-6	7 1/4	17 3/8	28 1/8	3 7/8	19 7/16	7 1/16	5 5/8	2	222
16	1/2-2 1/2	8	19 13/16	32 5/16	4 1/2	19 13/16	8 11/16	6 1/4	2 1/4	350
20	1/2-3	8 5/8	21 13/16	35 7/8	5	21	11 1/2	6 7/8	2 3/4	456
25	1/2-2 1/2	8 5/8	23 3/8	35 7/8	5	19 1/16	9 5/8	6 3/4	3	483
	3-5	8 5/8	23 3/8	35 7/8	5	21 3/16	9 5/8	6 3/4	3	495
	4-6	8 5/8	23 3/8	35 7/8	5	22 3/16	9 5/8	6 3/4	3	502
30	1/2-3	9 9/16	24 1/4	39 7/8	5	22 13/16	14 9/16	7 5/8	3	625
50	3-5	10 7/8	30 7/8	46 7/8	5	29 3/16	11 1/8	9 1/4	3 1/2	1306

Consult factory for possible larger capacities. SPECIFICATIONS ARE SUBJECT TO CHANGE WITHOUT NOTICE

VERTICAL + 180 + PULL

Model LPA

Locking Type



Model LPA is an ergonomic vertical lifting clamp capable of turning a single plate or member from horizontal to vertical to horizontal through a 180 degree arc. It incorporates an auxiliary push button lock. Permits side loading of lifting shackle to 90 degrees by de-rating of clamp's capacity. Refer to FIGURE 1 for de-rated capacities. The "Lock Open – Lock Closed" feature facilitates attaching and removing the clamp from the plate.

The **Model LPA** incorporates a pivoting shackle that permits side loading of the lifting shackle at 100 percent of rated capacity from vertical to 30 degrees, 75 percent of rated capacity between 30 and 45 degrees, and 50 percent of rated capacity between 45 and 90 degrees.

MODEL LPA EXPLODED VIEW

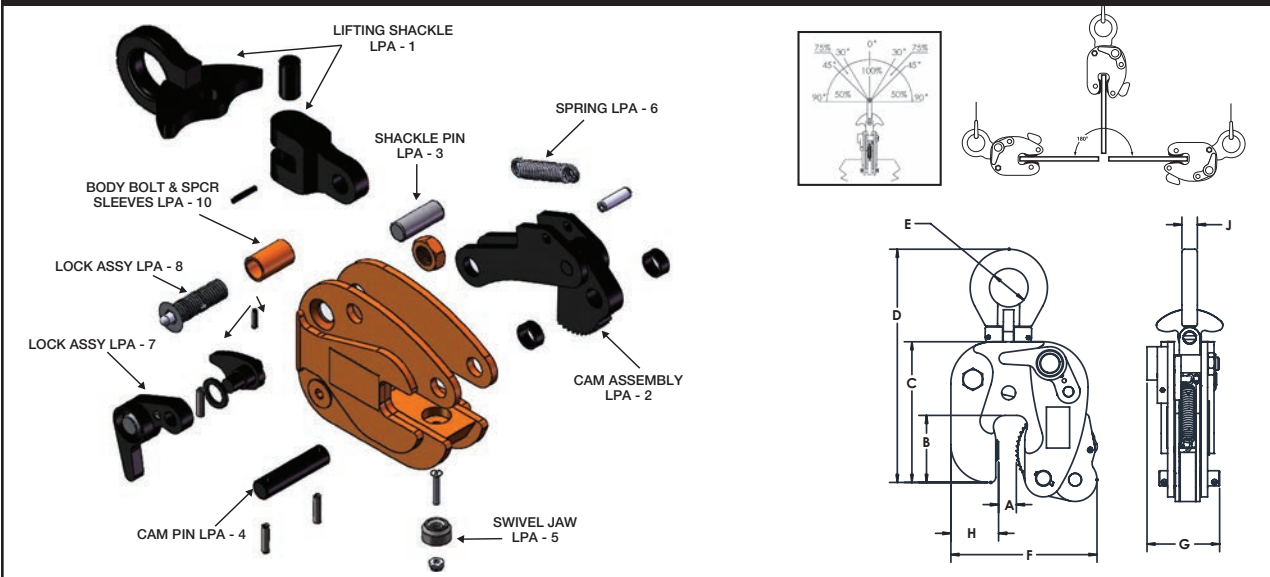

SPECIFICATIONS (in inches)

Rated Capacity Tons	Plate Thickness A	B	C	MAX. D	E	MAX. F	G	H	J	Weight (in pounds)
1/2	0-5/8	2	5 1/16	8 11/16	1 1/8	4 1/4	2 7/16	1 3/8	3/8	4 1/8
1	0-3/4	2	5 1/8	8 11/16	1 1/8	4 3/8	2 7/16	1 3/8	1/2	5 1/8
2	0-1	3 5/16	6 7/8	12 1/2	1 7/8	7 1/16	3 5/8	2 3/8	3/4	16 7/8
3	0-1	3 7/16	10	17	3 5/8	8 1/2	3 13/16	2 3/4	3/4	32

Consult factory for possible larger capacities. SPECIFICATIONS ARE SUBJECT TO CHANGE WITHOUT NOTICE





Model SCPA

Locking, Screw Type

The **SCPA** clamp is capable of handling steel plate from horizontal to vertical to horizontal through a 180 degree arc and may be used for handling plate at rolling and forming machines. These clamps feature a spring loaded pivoting cam jaw that “cams in” when a load is applied to the lifting shackle. Clamp is capable of handling plate horizontally when used in pairs or sets of pairs, or in a tripod arrangement.

*Pivoting shackle assembly, as shown, is available on capacities 3 tons and larger.

MODEL SCPA EXPLODED VIEW

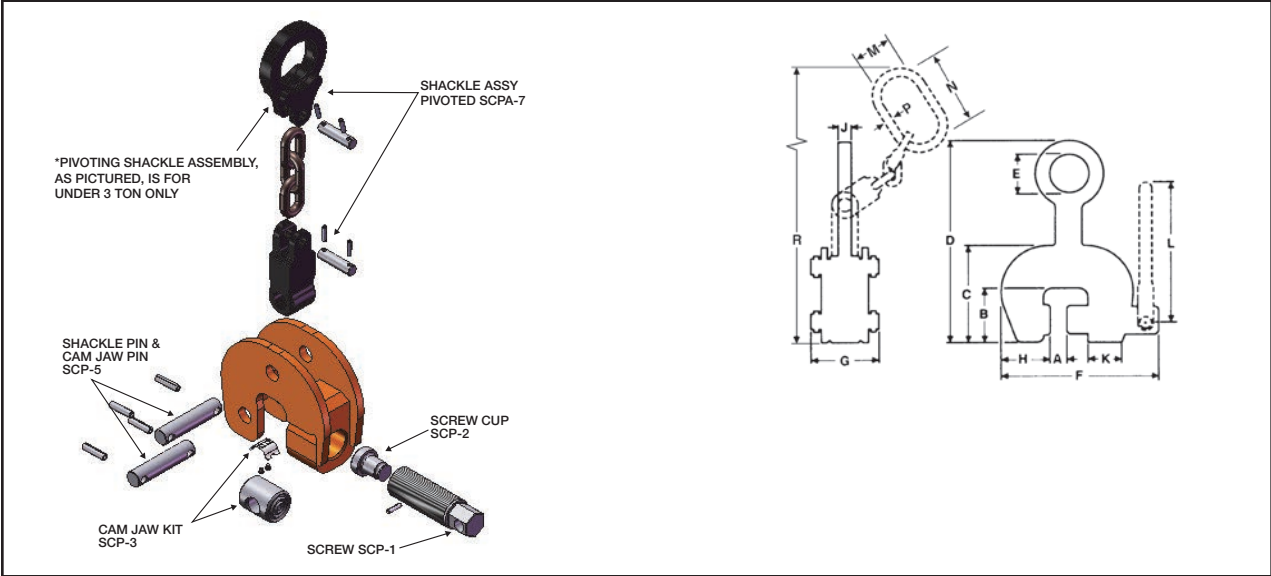

SPECIFICATIONS (in inches)

Rated Capacity Tons	Plate Thickness A	B	C	E	D	F	G	H	J	K	L	M	N	P	R	Weight (in pounds)
1/2	0-3/4	2 3/8	4 1/2	2 3/8	9	6 5/8	2 3/8	1 7/8	1/2	1 1/2	—	1 3/4	1 3/4	9/16	12 3/16	8
1 1/2	0-1 1/4	2 7/8	5 1/2	2 5/8	10 9/16	8 7/16	3 3/8	2 3/8	5/8	1 3/4	8 1/4	2	2	1 1/16	14 3/16	15
3	0-2	3 1/8	5 3/4	2 3/8	12	10 13/16	4 1/16	2 13/16	3/4	2	8 5/8	3	6	3/4	21 3/8	24
6	0-2 1/2	4 5/16	7 9/16	3	14 3/8	14 3/8	5 3/8	3 7/16	1	2 15/16	—	3 1/2	7	1	27 3/4	57
10	0-3	5 1/2	9 3/4	3 1/4	19 1/4	16 3/8	6 3/4	4 3/8	1	3 1/8	—	3 1/2	7	1	29 7/16	134
15	0-4	7 1/4	12 1/8	3 3/4	22 7/8	21 1/2	8 1/4	5 9/16	1 1/4	4	—	3 7/8	8	1 1/4	36 1/2	312

20, 30, 50, 100 and 150 Ton capacities available upon request. SPECIFICATIONS ARE SUBJECT TO CHANGE WITHOUT NOTICE.

VERTICAL + 180 + PULL

STRUCTURAL - SHAPES





Model AST

Non-Locking Type

Both the **Model AST** and **ASTL** were developed primarily for lifting, turning and stacking lightweight beams and structural shapes while a constant tension is applied to the lifting shackle. The horizontal shackle permits a beam to be lifted with the web in a near horizontal position by placing the clamp on the load with the shackle positioned over the web, and between the flanges. With a beam lying in a horizontal position, and the clamp placed with the shackle overhanging the flange, the beam can be lifted, turned 90 degrees, and raised in a vertical position.

MODEL AST EXPLODED VIEW

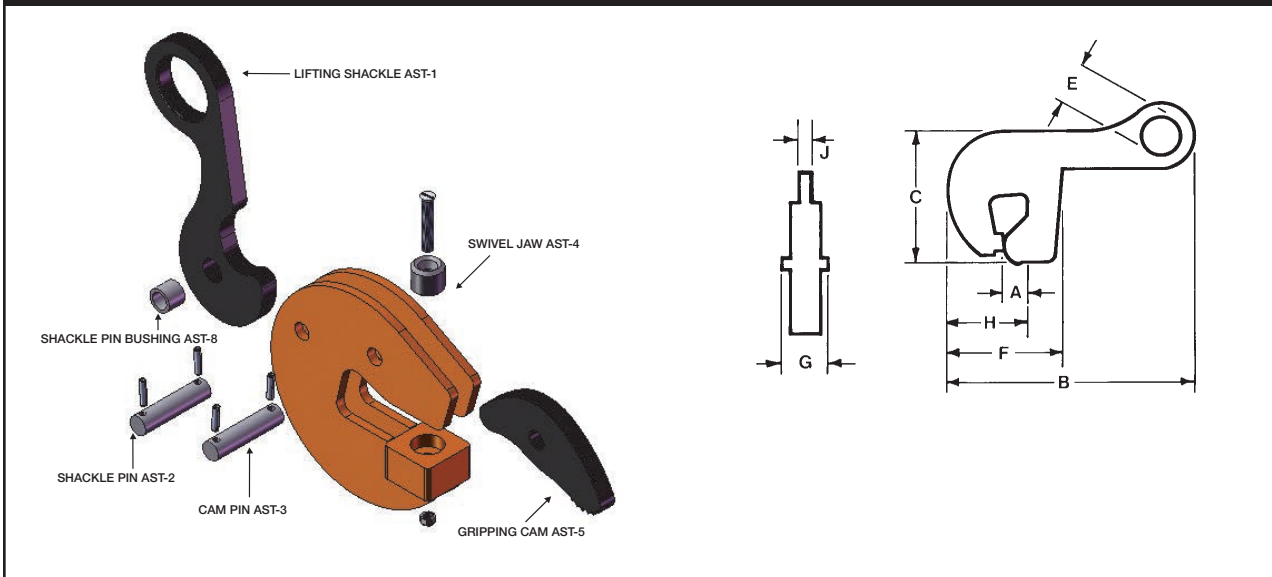

SPECIFICATIONS (in inches)

Rated Capacity Tons	Plate Thickness A	MAX. B	C	D	E	F	G	H	J	Weight (in pounds)
1/2	0- ³ / ₁₆	10 ³ / ₁₆	6 ¹ / ₁₆	-	1 ³ / ₄	6 ³ / ₁₆	1 ⁵ / ₁₆	2 ¹ / ₂	¹ / ₂	10
1¹/₂	0- ³ / ₁₆	13	8 ¹ / ₂	-	2 ¹ / ₂	7	2 ⁵ / ₁₆	3	⁵ / ₁₆	20
3	0-1 ¹ / ₂	19 ³ / ₁₆	12 ¹ / ₂	-	3 ³ / ₄	11	3	4 ⁵ / ₁₆	³ / ₄	50

SPECIFICATIONS ARE SUBJECT TO CHANGE WITHOUT NOTICE.

Model ASTL Non-Locking Type



Both the **Model AST** and **ASTL** were developed primarily for lifting, turning and stacking lightweight beams and structural shapes while a constant tension is applied to the lifting shackle. The horizontal shackle permits a beam to be lifted with the web in a near horizontal position by placing the clamp on the load with the shackle positioned over the web, and between the flanges. With a beam lying in a horizontal position, and the clamp placed with the shackle overhanging the flange, the beam can be lifted, turned 90 degrees, and raised in a vertical position.

The **Model ASTL** includes all of the feature of the **Model AST** plus a linkage which permits the tool to be removed remotely by setting the load down with the sling slack, then lifting the crane hook.

MODEL ASTL EXPLODED VIEW

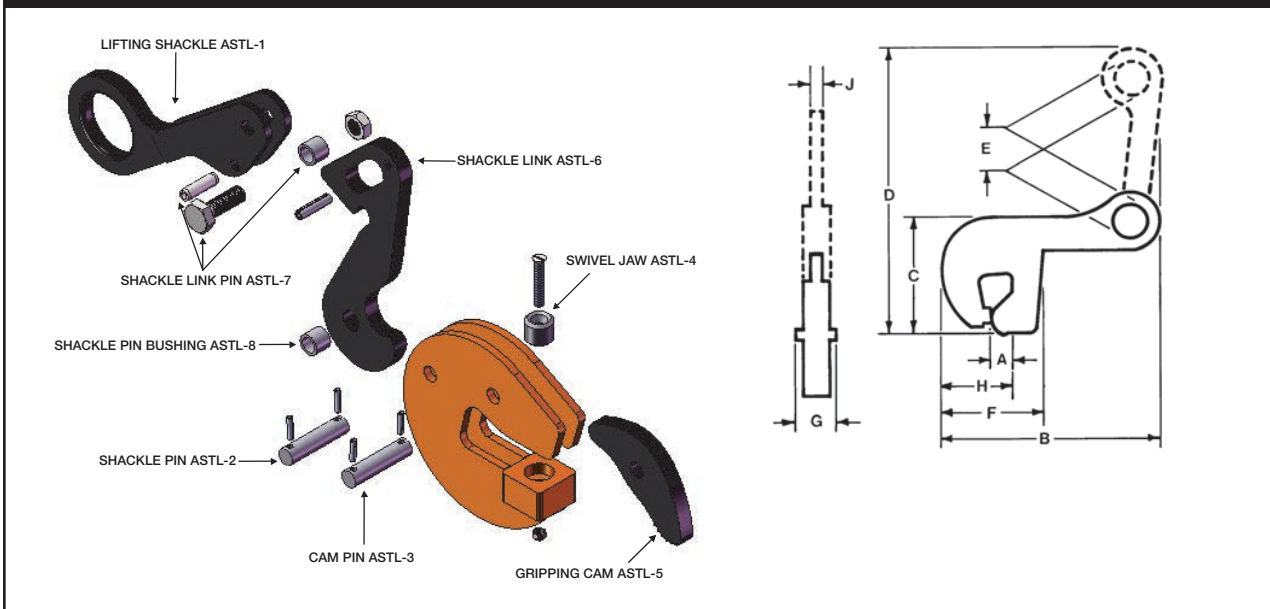

SPECIFICATIONS (in inches)

Rated Capacity Tons	Plate Thickness A	MAX. B	C	D	E	F	G	H	J	Weight (in pounds)
1/2	0-3/4	10 3/4	6 1/16	14	1 3/4	6 3/16	1 3/4	2 1/2	1/2	10
1 1/2	0-3/4	13	8 1/2	18 1/2	2 1/2	7	2 5/16	4 1/2	5/8	24
3	0-1 1/2	19 1/4	12 1/2	25	3 3/4	11 1/16	3 3/8	4 5/8	3/4	63

SPECIFICATIONS ARE SUBJECT TO CHANGE WITHOUT NOTICE.



Model DG

Locking Type

The **Model DG** rail clamp is used for lifting and transporting crane rails and railroad rails. Lightness of weight allows it to be hand applied and hand removed. The **Model DG** possesses all the features of the Model FR. All the repair parts are identical to same tonnage of the FR, except the swivel jaw has been eliminated.

MODEL DG EXPLODED VIEW

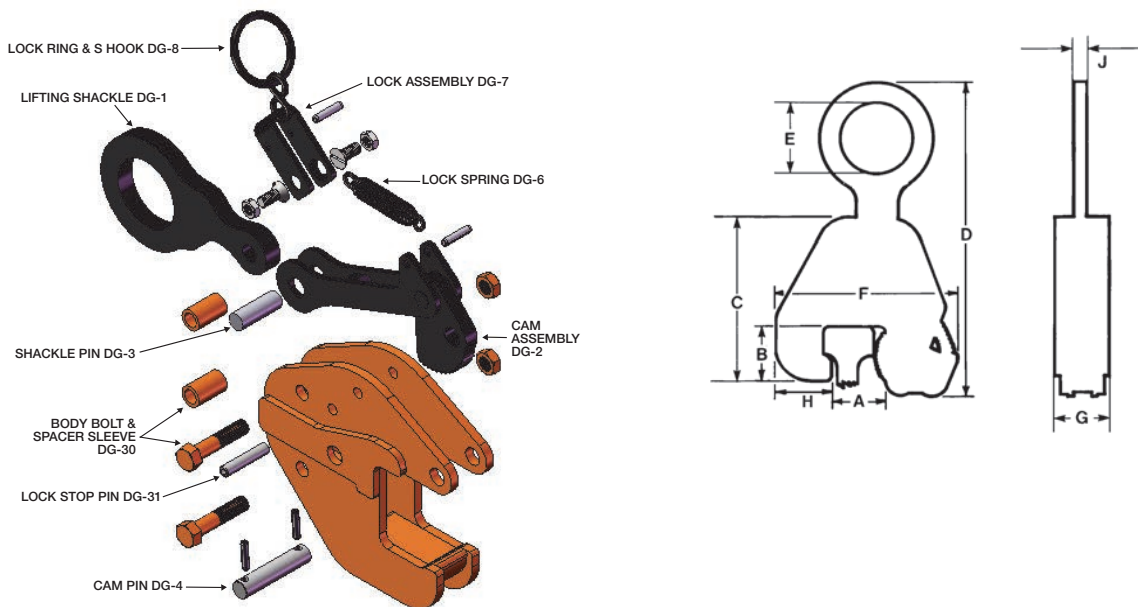

SPECIFICATIONS (in inches)

Rated Capacity Tons	Model	Capacity Std. Rail A	Capacity Crane Rail A	B	C	D	E	F	G	H	J	Weight (in pounds)
1/2	25	12-25 LB.	NONE	1 ⁵ / ₁₆	6 ¹¹ / ₁₆	11 ¹ / ₄	2 ³ / ₈	5 ³ / ₈	2 ¹ / ₂	1 ⁵ / ₈	1/2	10
1/2	50	30-50 LB.	NONE	1 ³ / ₈	6 ¹¹ / ₁₆	11 ¹ / ₄	2 ³ / ₈	6	2 ¹ / ₂	1 ⁵ / ₈	1/2	11
1	132	85-155 LB.	NONE	2 ¹ / ₂	8 ¹ / ₈	13 ¹ / ₂	2 ⁵ / ₈	8 ⁵ / ₈	3 ¹ / ₄	1 ⁷ / ₈	5/8	16
2	105	60-155 LB.	104 & 105 LB.	2 ⁵ / ₈	9	16	3 ⁵ / ₈	9 ¹ / ₈	3 ¹ / ₄	2 ¹ / ₂	3/4	26
2	175	NONE	135, 171, 175 LB.	2 ⁵ / ₈	9 ¹ / ₂	16	3 ⁵ / ₈	10 ³ / ₈	3 ¹ / ₄	2 ¹ / ₂	3/4	26

SPECIFICATIONS ARE SUBJECT TO CHANGE WITHOUT NOTICE. OTHER CAPACITIES AVAILABLE UPON REQUEST.

Model M

Locking Type



The **Model M** is a multipurpose clamp used for positioning, sorting, erection and handling of prefabricated sections. The split lower jaw enables the clamp to be particularly useful in handling structural shapes. The **Model M** incorporates a “Lock Closed” feature which facilitates attaching the clamp to the member being lifted. These clamps must be used in pairs, sets of pairs, or in a tripod arrangement for transporting plate horizontally. Handle is available on 8 ton clamp only.

MODEL M EXPLODED VIEW

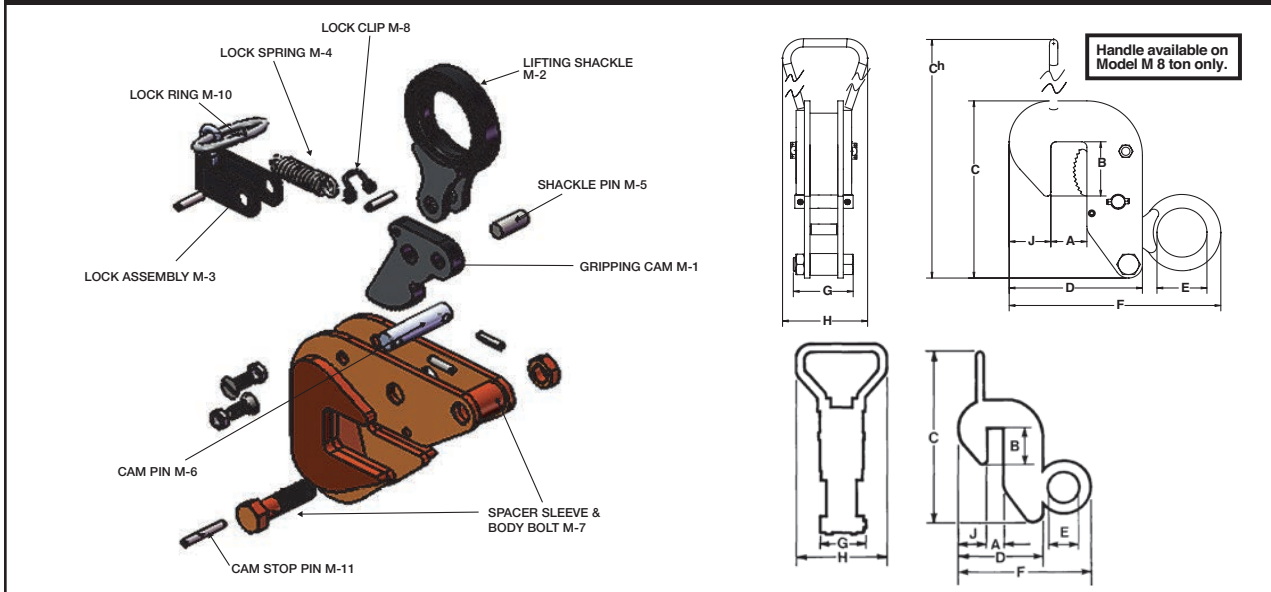

SPECIFICATIONS (in inches)

Rate Capacity Tons per Clamp	Plate Thickness A	B	C	Ch	D	MAX. E	F	G	H	J	Weight (in pounds)
1/2	0-1	2 ⁵ / ₁₆	7 ⁷ / ₁₆	—	4 ¹¹ / ₁₆	2 ¹ / ₄	8 ⁷ / ₈	2 ⁵ / ₈	—	1 ⁷ / ₁₆	7
	3/4-1 ¹ / ₂	2 ⁵ / ₁₆	7 ¹ / ₁₆	—	5 ³ / ₁₆	2 ¹ / ₄	9 ³ / ₈	2 ⁵ / ₈	—	1 ⁷ / ₁₆	8
	1 ¹ / ₄ -2	2 ⁵ / ₁₆	7 ¹ / ₁₆	—	5 ¹¹ / ₁₆	2 ¹ / ₄	9 ⁷ / ₈	2 ⁵ / ₈	—	1 ⁷ / ₁₆	9
1	0-1	2 ¹ / ₂	8 ¹ / ₈	—	5 ¹ / ₂	2 ¹ / ₄	9 ¹ / ₂	2 ³ / ₄	—	1 ⁷ / ₈	11
	3/4-1 ¹ / ₂	2 ¹ / ₂	8 ¹ / ₈	—	6	2 ¹ / ₄	10	2 ³ / ₄	—	1 ⁷ / ₈	12
	1 ¹ / ₄ -2	2 ¹ / ₂	8 ¹ / ₈	—	6 ¹ / ₂	2 ¹ / ₄	10 ¹ / ₂	2 ³ / ₄	—	1 ⁷ / ₈	13
2	0-1 ¹ / ₄	3 ³ / ₁₆	10 ³ / ₄	—	6 ⁹ / ₁₆	3 ¹ / ₁₆	12 ¹ / ₈	3 ⁷ / ₈	—	2	23
	1-2	3 ³ / ₁₆	10 ³ / ₄	—	7 ³ / ₁₆	3 ¹ / ₁₆	12 ⁷ / ₈	3 ⁷ / ₈	—	2	24
	1 ³ / ₄ -2 ³ / ₄	3 ³ / ₁₆	10 ³ / ₄	—	7 ¹⁵ / ₁₆	3 ¹ / ₁₆	13 ⁵ / ₈	3 ⁷ / ₈	—	2	27
4	0-1 ¹ / ₂	3 ¹³ / ₁₆	12	—	7 ³ / ₄	3 ⁵ / ₈	14 ¹ / ₂	4 ³ / ₈	—	2 ³ / ₄	36
	1 ¹ / ₄ -2 ¹ / ₂	3 ¹³ / ₁₆	12	—	8 ³ / ₄	3 ⁵ / ₈	16 ¹ / ₂	4 ³ / ₈	—	2 ³ / ₄	38
	2 ¹ / ₄ -3 ¹ / ₂	3 ¹⁵ / ₁₆	12	—	9 ³ / ₄	3 ⁵ / ₈	14 ¹ / ₂	4 ³ / ₈	—	2 ³ / ₄	41
8	0-2	4 ¹⁵ / ₁₆	—	19 ¹ / ₄	11 ⁷ / ₁₆	4	19 ¹ / ₂	5 ¹ / ₂	8	4	107
	1 ³ / ₄ -3 ¹ / ₂	4 ¹⁵ / ₁₆	—	19 ¹ / ₄	12 ¹⁵ / ₁₆	4	21	5 ¹ / ₂	8	4	110
	3 ¹ / ₄ -5	4 ¹⁵ / ₁₆	—	19 ¹ / ₄	14 ⁷ / ₁₆	4	22 ¹ / ₂	5 ¹ / ₂	8	4	125

SPECIFICATIONS ARE SUBJECT TO CHANGE WITHOUT NOTICE



Model SEA

Locking Type

The **Model SEA** is a clamp used primarily for erection of structural beams. Configuration of the lower hook assembly and the over center position of the shackle permits a clamp to grip closer to the beam web, stabilizing the load and holding it with the web near horizontal for easy alignment of bolt holes.

The clamp incorporates a “Lock Open” and “Lock Closed” feature which facilitates in attaching and removing the clamp from the beam.

MODEL SEA EXPLODED VIEW

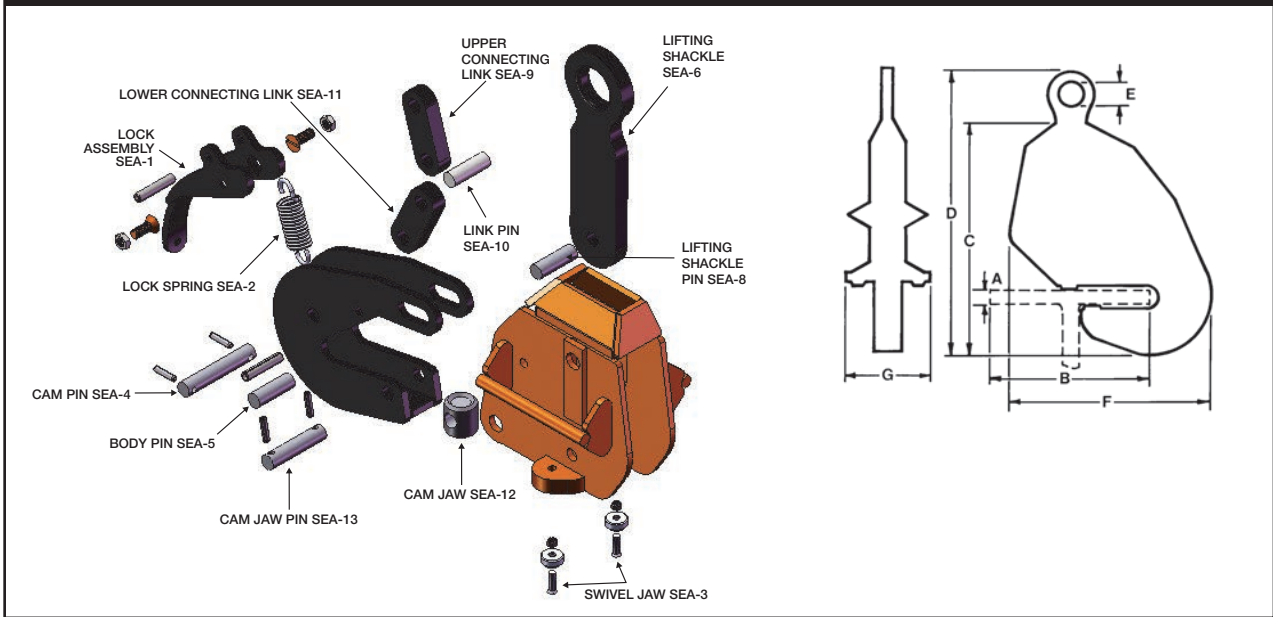

SPECIFICATIONS (in inches)

Rated Capacity Tons	Plate Thickness A	Flange Width B	C	Max. D	E	F	G	Weight (in pounds)
1	0- ³ / ₄	3-8	11 ⁵ / ₁₆	17 ¹ / ₈	1 ¹ / ₈	9 ¹ / ₄	5 ⁷ / ₈	22
2	0-1	5-12	17 ¹ / ₂	21 ¹ / ₂	1 ¹ / ₂	14 ¹ / ₈	6 ⁷ / ₈	73
4	0-1	7-14	19 ³ / ₄	27 ¹ / ₂	1 ³ / ₄	17 ⁷ / ₈	8 ¹ / ₁₆	116
	³ / ₄ -1 ³ / ₄	7-14	20 ¹ / ₂	28 ¹ / ₄	1 ³ / ₄	17 ⁷ / ₈	8 ¹ / ₁₆	120
8	0-1 ¹ / ₂	10-20	25 ¹ / ₂	31	2	21 ¹ / ₂	9 ³ / ₄	200
	1-2 ¹ / ₂	10-20	26 ¹ / ₂	32	2	21 ¹ / ₂	9 ³ / ₄	204
15	³ / ₄ -2 ¹ / ₄	10-20	31	41 ¹ / ₂	3 ³ / ₄	21 ¹ / ₂	10 ³ / ₄	343
	2-3 ¹ / ₂	10-20	32 ¹ / ₄	42 ³ / ₄	3 ³ / ₄	21 ¹ / ₂	10 ³ / ₄	

SPECIFICATIONS ARE SUBJECT TO CHANGE WITHOUT NOTICE.



HORIZONTAL



Model DWS

Locking Type



Model DWS is a horizontal lifting clamp utilizing Renfro's famous "lock-closed" feature. This clamp comes in four sizes:

- 1/4 Ton: 0 – 1/2" opening
- 1/2 Ton: 0 – 3/4" opening
- 1-1/2 Ton: 0 – 1" opening
- 3 Ton: 0 – 1-1/4" opening

Recommended for use in pairs.

MODEL DWS EXPLODED VIEW

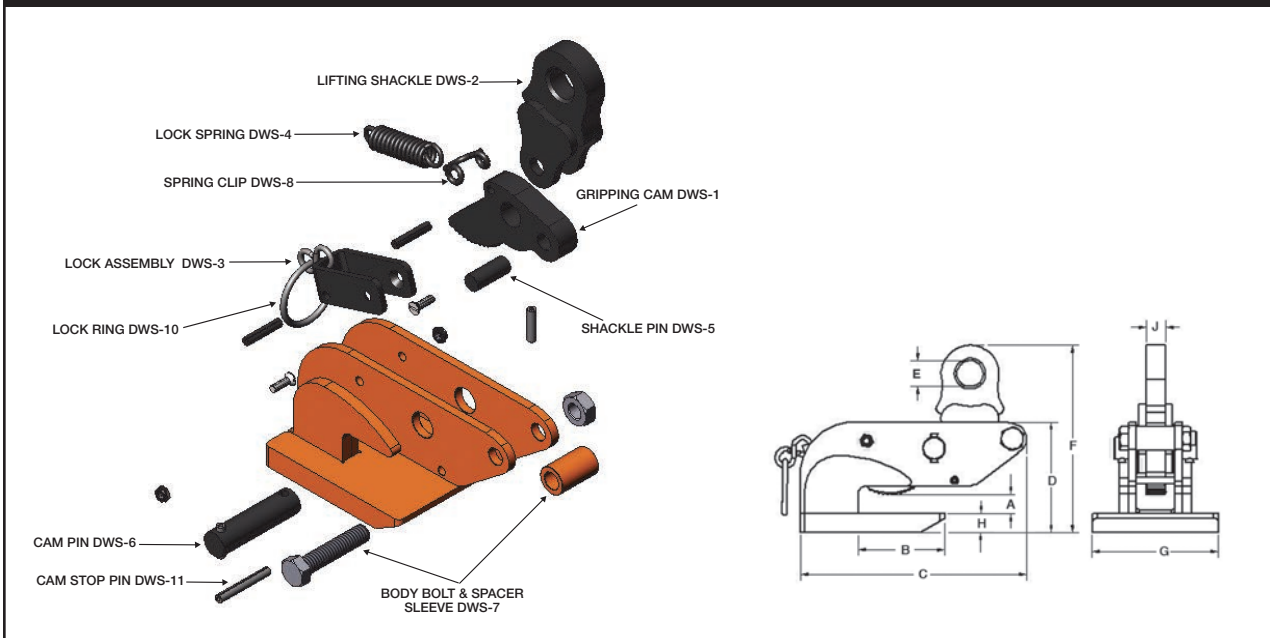

SPECIFICATIONS (in inches)

Rate Capacity Tons per Clamp	Plate Thickness A	B	C	D	Std. E	Option E	Max. F	G	H	J	Weight (in pounds)
1/4	0-1/2	2 7/8	6 5/8	3 3/16	3/4	2	5 3/4	3 1/2	3/8	1/2	5
1/2	0-3/4	3	7	3 9/16	1	2 1/4	7 3/8	4	1/2	5/8	9
1 1/2	0-1	3 1/2	8 1/4	4 1/4	1	2 1/4	8 1/8	5	5/8	5/8	14
3	0-1 1/4	4 1/2	11 3/4	5 13/16	1 1/8	3 1/2	11 3/4	6 1/2	1	1	37

SPECIFICATIONS ARE SUBJECT TO CHANGE WITHOUT NOTICE.

Model HRS Non-Locking Type



The **Model HRS** is a horizontal lifting clamp that has a spring loaded open and closed position. The spring closed position allows one-man operation of multiple clamps. The clamps stay in position where they're attached until spring open is actuated.

These clamps must be used in pairs, sets of pairs, or in a tripod arrangement for transporting plate horizontally.

MODEL HRS EXPLODED VIEW

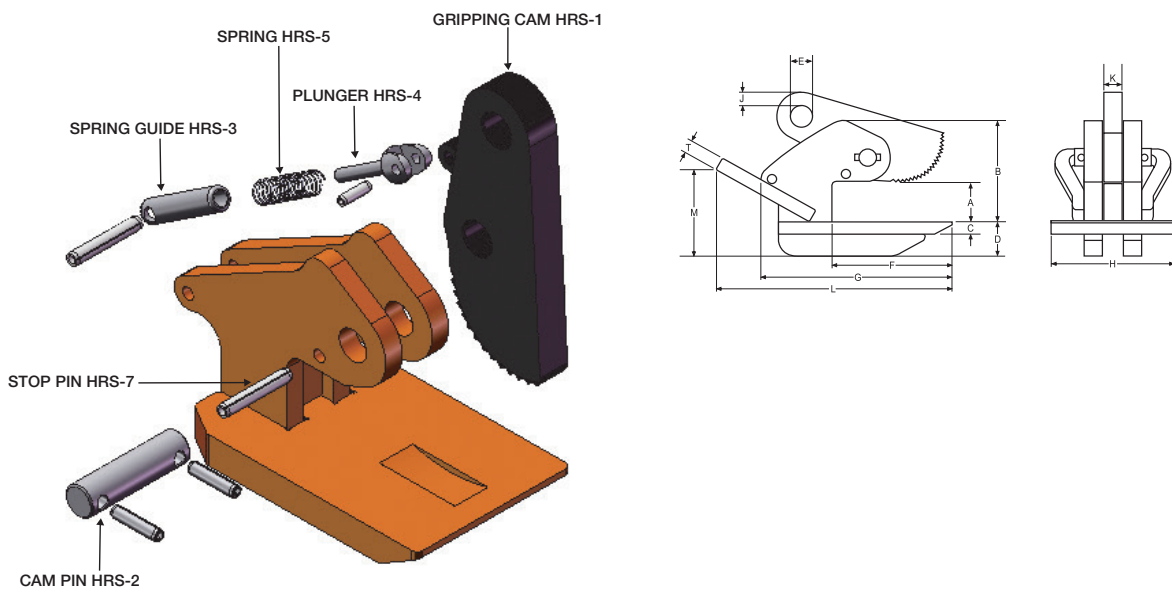

SPECIFICATIONS (in inches)

Rate Capacity Tons per Clamp	Plate Thickness A	B	C	D	E	F	G	H	J	K	L	M	T	Weight (in pounds)
1/4	1/16-3/4	2 ⁹ / ₁₆	3/8	-	1/2	3	4 ³ / ₄	3	1/4	1/2	-	-	-	4
1/2	1/16-1	3 ⁵ / ₁₆	1/2	-	1/2	3 ³ / ₄	5 ¹⁵ / ₁₆	3 ¹ / ₄	5/16	1/2	-	-	-	5
1	1/16-1 ¹ / ₄	3 ¹¹ / ₁₆	5/8	-	5/8	4	6 ⁵ / ₁₆	3 ¹ / ₂	7/16	5/8	-	-	-	7
2	1/16-1 ¹ / ₂	4 ¹ / ₂	3/4	-	1 ¹ / ₁₆	5 ³ / ₈	8 ⁵ / ₈	5	9/16	3/4	10 ¹⁵ / ₁₆	3 ¹ / ₄	5/8	20
3	1/16-1 ³ / ₄	5 ³ / ₄	1	-	1 ¹ / ₄	6 ³ / ₄	10 ³ / ₄	7	3/4	1	13	4	5/8	34
4	1/16-2	5 ³ / ₄	3/4	2	1 ¹ / ₄	6 ³ / ₄	10 ³ / ₄	7	3/4	1	13 ⁵ / ₁₆	5	3/4	44

SPECIFICATIONS ARE SUBJECT TO CHANGE WITHOUT NOTICE.

Backpad available only on 4 ton model. Handles are standard on 2, 3 and 4 ton models.



Model LHC Non-Locking Type

The **LHC Model** is a horizontal lifting clamp intended to be used in pairs, sets of pairs or in a tripod arrangement for transporting steel plates horizontally. The clamp is designed to lift individual sheets horizontally. Cam operations ensure a tight grip on the load. Serrated gripping cam bites into load for positive grip. Clamps rest in position on edge of plate until tension is applied to the load sling. Clamps must be used in single pairs (2), double pairs (4), or tripod (3) configuration with a lifting sling.

MODEL LHC EXPLODED VIEW

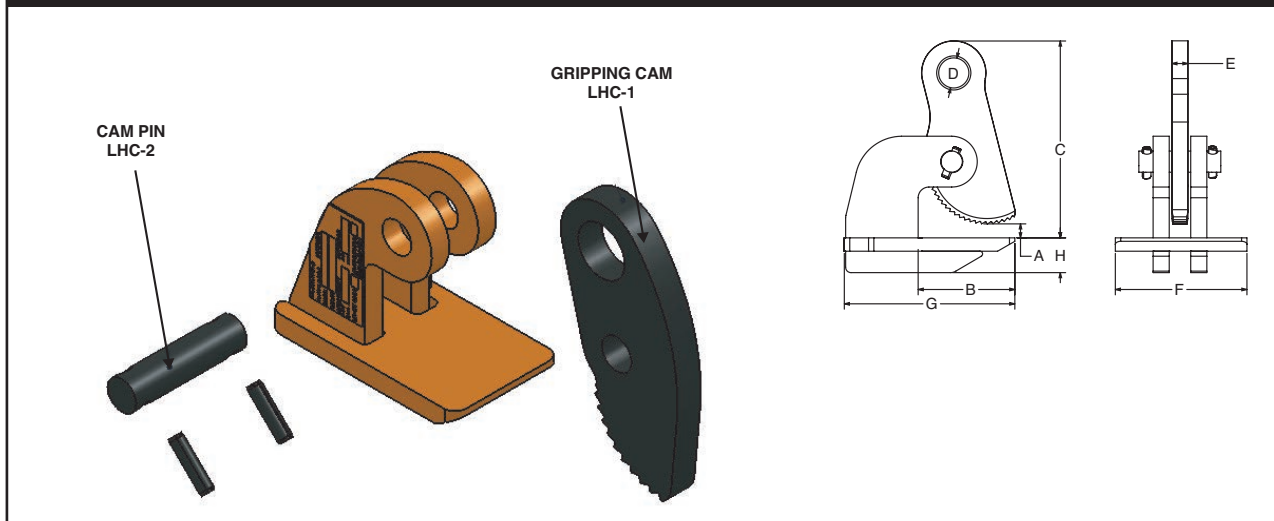

SPECIFICATIONS (in inches)

Rated Capacity Tons per Clamp	Plate Thickness A	B	C	D	E	F	G	H	Weight Each (in pounds)
1/4	0-1	2 3/8	5	1	1/2	2 1/4	4	3/8	3
1/2	0-2	4 3/8	9 1/4	1 3/8	1/2	4 7/8	7 3/4	5/8	14
3/4	0-2	4 3/8	9 1/4	1 13/32	3/4	5 3/8	7 3/4	3/4	19
1 1/2	0-2	4 9/16	9 1/4	1 13/32	3/4	6 1/8	7 15/16	1	26
3	0-2	4 1/2	9 1/4	1 13/32	3/4	6 1/8	7 15/16	1 5/8	24
4	0-3	7	12 5/16	1 13/32	1	6 1/2	10 3/8	2 3/16	48

Consult factory for possible larger capacities. SPECIFICATIONS ARE SUBJECT TO CHANGE WITHOUT NOTICE



Model LHD

Non-Locking Type



The **Model LHD** is a horizontal lifting clamp intended to be used in pairs, sets of pairs, or in a tripod arrangement for transporting steel plates horizontally. The **Model LHD** possesses dual cam assemblies which provides two gripping surfaces.

Equipped with serrated gripping cams as standard equipment, this model is available with smooth, bronze or stainless steel surfaces gripping cams to prevent marring when handling polished metals such as stainless steel, copper, aluminum, etc.

The **Model LHD** is a Non-Locking clamp and requires a constant tension applied to the lifting shackle throughout the entire operation.

MODEL LHD EXPLODED VIEW

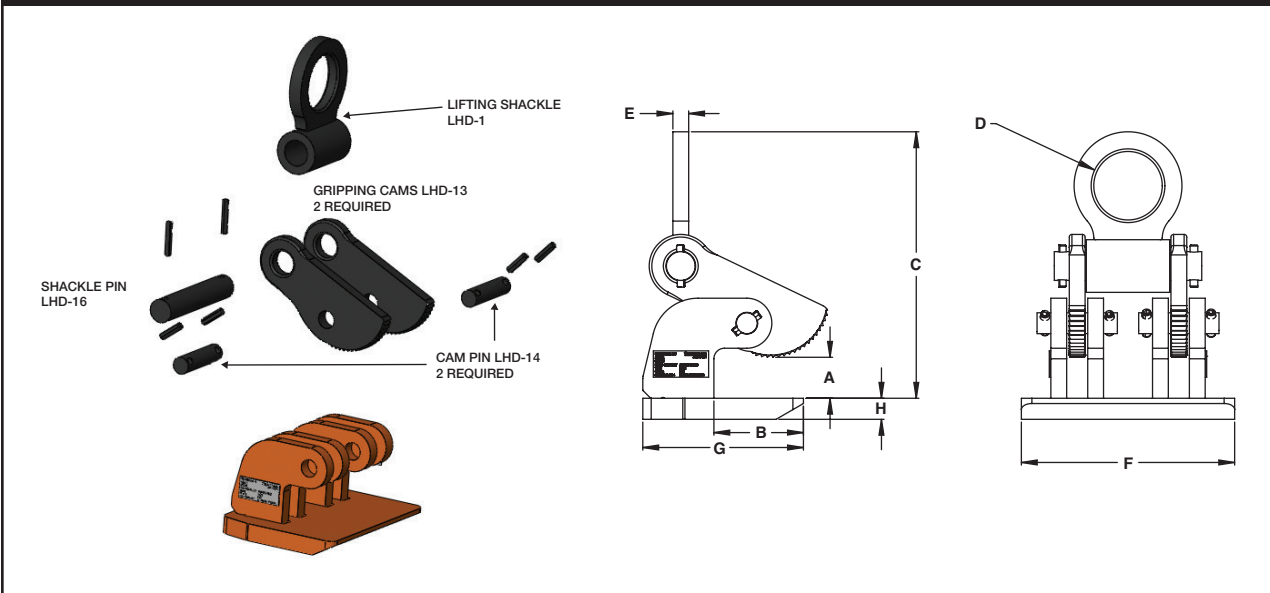

SPECIFICATIONS (in inches)

Rated Capacity Tons per Clamp	Plate Thickness A	B	C	D	E	F	G	H	Weight Each (in pounds)
1 1/2	0-2	4.25	14 13/16	3 1/4	3/4	10 1/4	7 5/8	3/4	46
3	0-2	4.25	15 1/8	3 1/4	3/4	10 1/4	7 5/8	1	56
6	0-2	4.5	16 3/16	3 1/4	1 5/8	10 1/4	7 7/8	1 5/8	59
8	0-3	6 5/8	17 1/4	3 1/4	1 5/8	11 1/4	10	2 3/16	110

Consult factory for possible larger capacities. SPECIFICATIONS ARE SUBJECT TO CHANGE WITHOUT NOTICE

HORIZONTAL

Model M Locking Type



The **Model M** is a multipurpose clamp used for positioning, sorting, erection and handling of prefabricated sections. The split lower jaw enables the clamp to be particularly useful in handling structural shapes. The **Model M** incorporates a “Lock Closed” feature which facilitates attaching the clamp to the member being lifted. These clamps must be used in pairs, sets of pairs, or in a tripod arrangement for transporting plate horizontally. Handle is available on 8 ton clamp only.

MODEL M EXPLODED VIEW

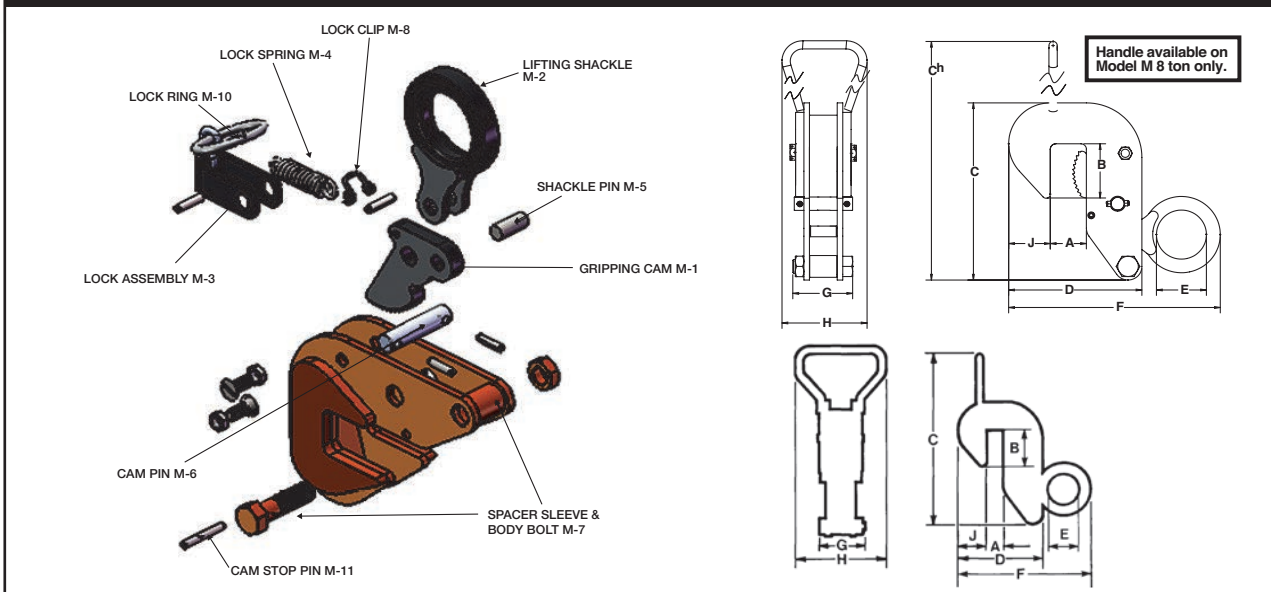

SPECIFICATIONS (in inches)

Rate Capacity Tons per Clamp	Plate Thickness A	B	C	Ch	D	MAX. E	F	G	H	J	Weight (in pounds)
1/2	0-1	2 ⁵ / ₁₆	7 ⁷ / ₁₆	—	4 ¹¹ / ₁₆	2 ¹ / ₄	8 ⁷ / ₈	2 ⁵ / ₈	—	1 ⁷ / ₁₆	7
	3/4-1 ¹ / ₂	2 ⁵ / ₁₆	7 ⁷ / ₁₆	—	5 ³ / ₁₆	2 ¹ / ₄	9 ³ / ₈	2 ⁵ / ₈	—	1 ⁷ / ₁₆	8
	1 ¹ / ₄ -2	2 ⁵ / ₁₆	7 ⁷ / ₁₆	—	5 ¹¹ / ₁₆	2 ¹ / ₄	9 ⁷ / ₈	2 ⁵ / ₈	—	1 ⁷ / ₁₆	9
1	0-1	2 ¹ / ₂	8 ¹ / ₈	—	5 ¹ / ₂	2 ¹ / ₄	9 ¹ / ₂	2 ³ / ₄	—	1 ⁷ / ₈	11
	3/4-1 ¹ / ₂	2 ¹ / ₂	8 ¹ / ₈	—	6	2 ¹ / ₄	10	2 ³ / ₄	—	1 ⁷ / ₈	12
	1 ¹ / ₄ -2	2 ¹ / ₂	8 ¹ / ₈	—	6 ¹ / ₂	2 ¹ / ₄	10 ¹ / ₂	2 ³ / ₄	—	1 ⁷ / ₈	13
2	0-1 ¹ / ₄	3 ³ / ₁₆	10 ³ / ₄	—	6 ⁹ / ₁₆	3 ¹ / ₁₆	12 ¹ / ₈	3 ⁷ / ₈	—	2	23
	1-2	3 ³ / ₁₆	10 ³ / ₄	—	7 ³ / ₁₆	3 ¹ / ₁₆	12 ⁷ / ₈	3 ⁷ / ₈	—	2	24
	1 ³ / ₄ -2 ³ / ₄	3 ³ / ₁₆	10 ³ / ₄	—	7 ¹⁵ / ₁₆	3 ¹ / ₁₆	13 ⁵ / ₈	3 ⁷ / ₈	—	2	27
4	0-1 ¹ / ₂	3 ¹³ / ₁₆	12	—	7 ³ / ₄	3 ⁵ / ₈	14 ¹ / ₂	4 ³ / ₈	—	2 ³ / ₄	36
	1 ¹ / ₄ -2 ¹ / ₂	3 ¹³ / ₁₆	12	—	8 ³ / ₄	3 ⁵ / ₈	16 ¹ / ₂	4 ³ / ₈	—	2 ³ / ₄	38
	2 ¹ / ₄ -3 ¹ / ₂	3 ¹⁵ / ₁₆	12	—	9 ³ / ₄	3 ⁵ / ₈	14 ¹ / ₂	4 ³ / ₈	—	2 ³ / ₄	41
8	0-2	4 ¹⁵ / ₁₆	—	19 ¹ / ₄	11 ⁷ / ₁₆	4	19 ¹ / ₂	5 ¹ / ₂	8	4	107
	1 ³ / ₄ -3 ¹ / ₂	4 ¹⁵ / ₁₆	—	19 ¹ / ₄	12 ¹⁵ / ₁₆	4	21	5 ¹ / ₂	8	4	110
	3 ¹ / ₄ -5	4 ¹⁵ / ₁₆	—	19 ¹ / ₄	14 ⁷ / ₁₆	4	22 ¹ / ₂	5 ¹ / ₂	8	4	125

SPECIFICATIONS ARE SUBJECT TO CHANGE WITHOUT NOTICE

Model WHSR

Non-Locking Type



The **Model WHSR** is an adjustable, horizontal clamp intended to be used in pairs, sets of pairs, or in a tripod arrangement for transporting steel plates horizontally. In addition to incorporating two gripping cams, the jaw opening may be adjusted by the positioning of a pin in the body of the clamp. The gripping cams are spring loaded to remain in the “open” position until the load is applied. This feature permits the clamp to be easily applied and removed from the load. Normally furnished with serrated gripping surfaces, it is available with smooth faced bronze or stainless steel surfaces to prevent marring when handling polished plates.

MODEL WHSR EXPLODED VIEW

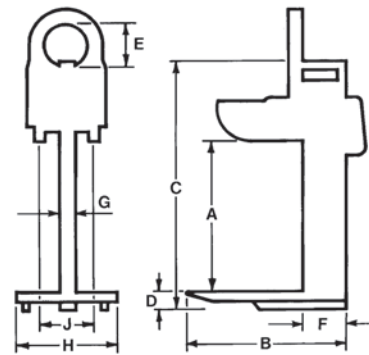
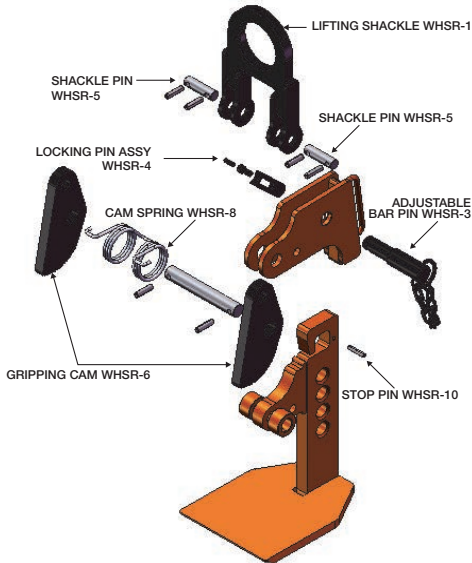

SPECIFICATIONS (in inches)

Rate Capacity Tons per Clamp	Plate Thickness A	B	C	D	E	F	G	H	J	Weight (in pounds)
1/2	0-6	10 ³ / ₄	14 ³ / ₁₆	⁵ / ₈	3 ¹ / ₂	3	¹ / ₂	8 ³ / ₈	4 ¹ / ₂	46
	0-12	13	23 ¹ / ₈	⁵ / ₈	3 ¹ / ₂	5	¹ / ₂	8 ¹ / ₄	4 ¹ / ₂	60
	0-16	13	27 ³ / ₁₆	⁵ / ₈	3 ¹ / ₂	5	¹ / ₂	8 ¹ / ₄	4 ¹ / ₂	80
1 1/2	0-6	10 ³ / ₄	14 ⁵ / ₁₆	³ / ₄	3 ¹ / ₂	3	³ / ₄	8 ³ / ₈	4 ⁵ / ₈	66
	0-12	13	23 ¹ / ₄	³ / ₄	3 ¹ / ₂	5	³ / ₄	8 ¹ / ₄	4 ⁵ / ₈	90
	0-16	13	27 ⁹ / ₁₆	³ / ₄	3 ¹ / ₂	5	³ / ₄	8 ¹ / ₄	4 ⁵ / ₈	104
3	0-6	10 ³ / ₄	15 ¹ / ₄	1 ⁵ / ₈	3 ¹ / ₂	3	1	8 ³ / ₈	4 ⁵ / ₈	70
	0-12	13	23 ⁵ / ₁₆	1 ⁵ / ₈	3 ¹ / ₂	5	1	8 ¹ / ₄	4 ⁵ / ₈	94
	0-16	13	27 ¹³ / ₁₆	1 ⁵ / ₈	3 ¹ / ₂	5	1	8 ¹ / ₄	4 ⁵ / ₈	112
6	0-6	13	18 ¹ / ₁₆	2 ¹ / ₄	3 ¹ / ₂	5	1	8 ¹ / ₄	4 ⁵ / ₈	108
	0-12	13	24 ¹³ / ₁₆	2 ¹ / ₄	3 ¹ / ₂	5	1	8 ¹ / ₄	4 ⁵ / ₈	114
	0-16	13	28 ¹³ / ₁₆	2 ¹ / ₄	3 ¹ / ₂	5	1	8 ¹ / ₄	4 ⁵ / ₈	154
8	0-6	13	18 ¹ / ₂	3	3 ¹ / ₂	6	1	8 ¹ / ₄	5 ¹ / ₄	130
	0-12	13	24 ⁷ / ₈	3	3 ¹ / ₂	6	1	8 ¹ / ₄	5 ¹ / ₄	141
	0-16	13	28 ⁷ / ₈	3	3 ¹ / ₂	6	1	8 ¹ / ₄	5 ¹ / ₄	220

SPECIFICATIONS ARE SUBJECT TO CHANGE WITHOUT NOTICE

BEAM



Model A-1

Locking Type

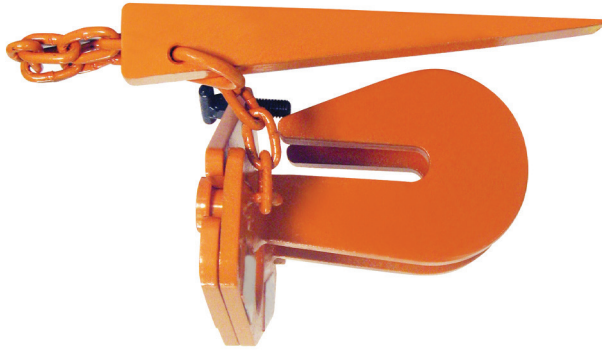

The **Model A-1** is a portable beam clamp that provides easy suspension of hoists, from channels or angles thereby eliminating the need for nuts, bolts, shackles and so on.

The **Model A-1** is designed for use on channel or angle shapes only. This model is furnished with a fluted tool steel locking wedge which holds the clamp in place on channels or angles.

MODEL A-1 EXPLODED VIEW

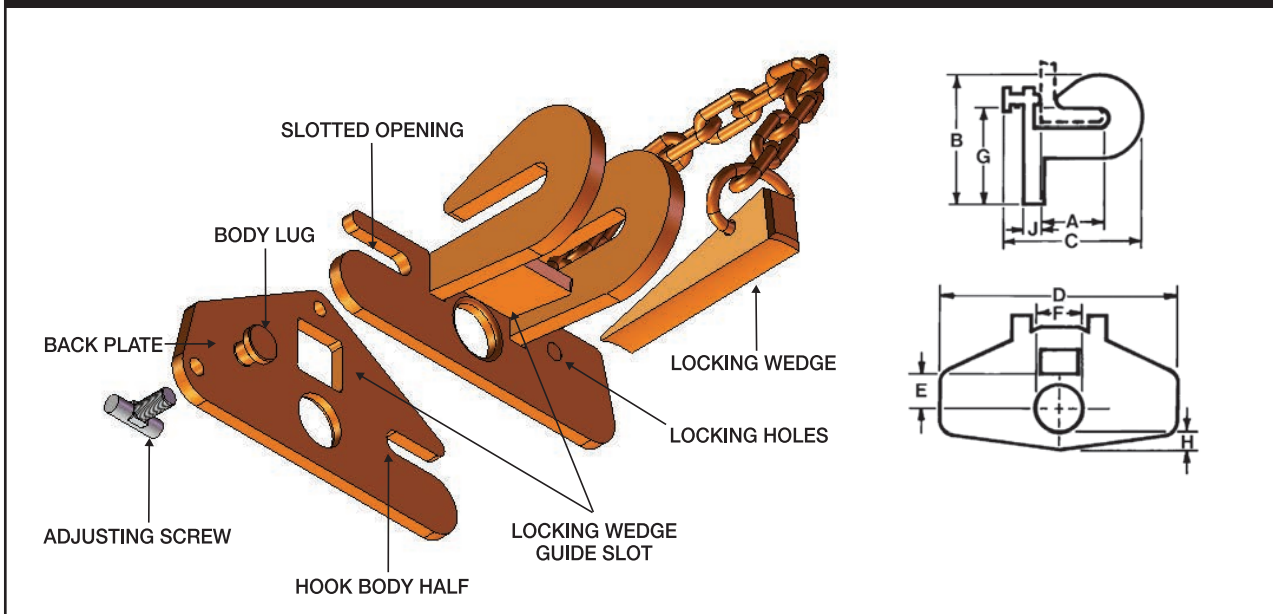

SPECIFICATIONS (in inches)

Rated Capacity Tons	Flange Width A	B	MAX. C	D	E	F	G	H	J	Weight (in pounds)
1	1½-4	5 ⁵ / ₁₆	7 ⁷ / ₈	8 ³ / ₄	1 ³ / ₁₆	1½	4 ³ / ₁₆	5 ⁵ / ₈	¾	14
	4-8	6¼	12¼	8¾	1 ³ / ₁₆	1½	4 ¹¹ / ₁₆	5 ⁵ / ₈	¾	15
3	2-4	6 ¹¹ / ₁₆	8 ⁹ / ₁₆	11¼	1 ¹¹ / ₁₆	2¼	5 ³ / ₈	7 ⁷ / ₈	¾	22
	4-8	8¼	13½	11¼	1 ¹¹ / ₁₆	2¼	6½	7 ⁷ / ₈	¾	27
5	2-4	8 ⁵ / ₈	8 ⁷ / ₈	13¼	2 ³ / ₄	3½	6 ³ / ₈	1	1	35
	4-8	10 ⁹ / ₁₆	13 ¹³ / ₁₆	13¼	2 ³ / ₄	3½	6 ⁷ / ₈	1	1	45

SPECIFICATIONS ARE SUBJECT TO CHANGE WITHOUT NOTICE.



Model AC

Locking, Screw Type

These clamps may be used for Drifting Loads when used in pairs or multiples.

The **Models AC** and **ACP** are light weight, portable clamps that provide quick easy attachment to structural members for the use of chain falls, hoists and wire rope pullers. These clamps are of single unit construction with a quick acting hand screw to secure the clamp.

The **Model AC** has a fixed Shackle Eye. These clamps are especially useful in the construction and maintenance for shipbuilding and other industries.

MODEL AC EXPLODED VIEW

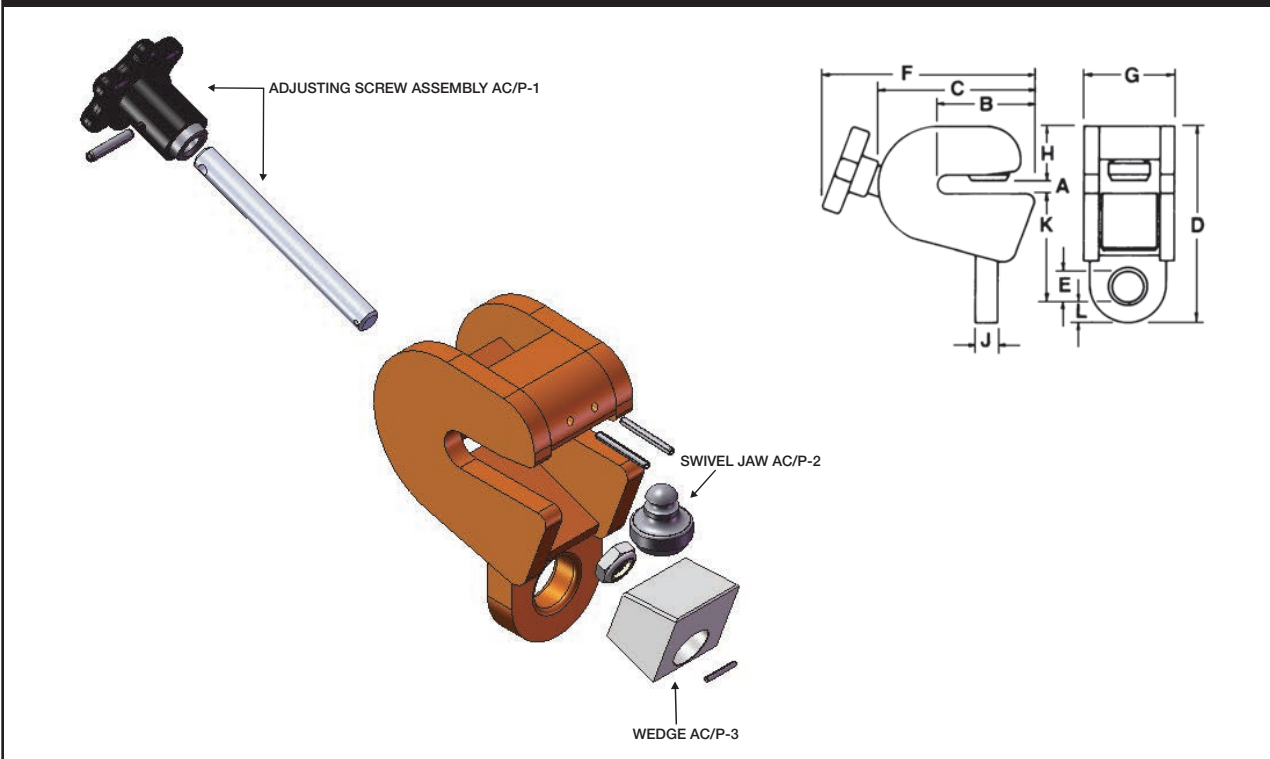

SPECIFICATIONS (in inches)

Rated Capacity Tons	Flange Width A	B	C	D	E	F	G	H	J	K	L	Weight (in pounds)
2	1/4-5/8	3/4	5/4	7	1 1/4	6 3/4	3	1 13/16	3/4	3 9/16	3/4	11 1/2

SPECIFICATIONS ARE SUBJECT TO CHANGE WITHOUT NOTICE. OTHER CAPACITIES AVAILABLE UPON REQUEST.



Model ACP

Locking, Screw Type

These clamps may be used for Drifting Loads when used in pairs or multiples.

The **Models AC** and **ACP** are light weight, portable clamps that provide quick easy attachment to structural members for the use of chain falls, hoists and wire rope pullers. These clamps are of single unit construction with a quick acting hand screw to secure the clamp.

The **Model ACP** has a Pivoting Shackle Eye. These clamps are especially useful in the construction and maintenance for shipbuilding and other industries.

MODEL ACP EXPLODED VIEW

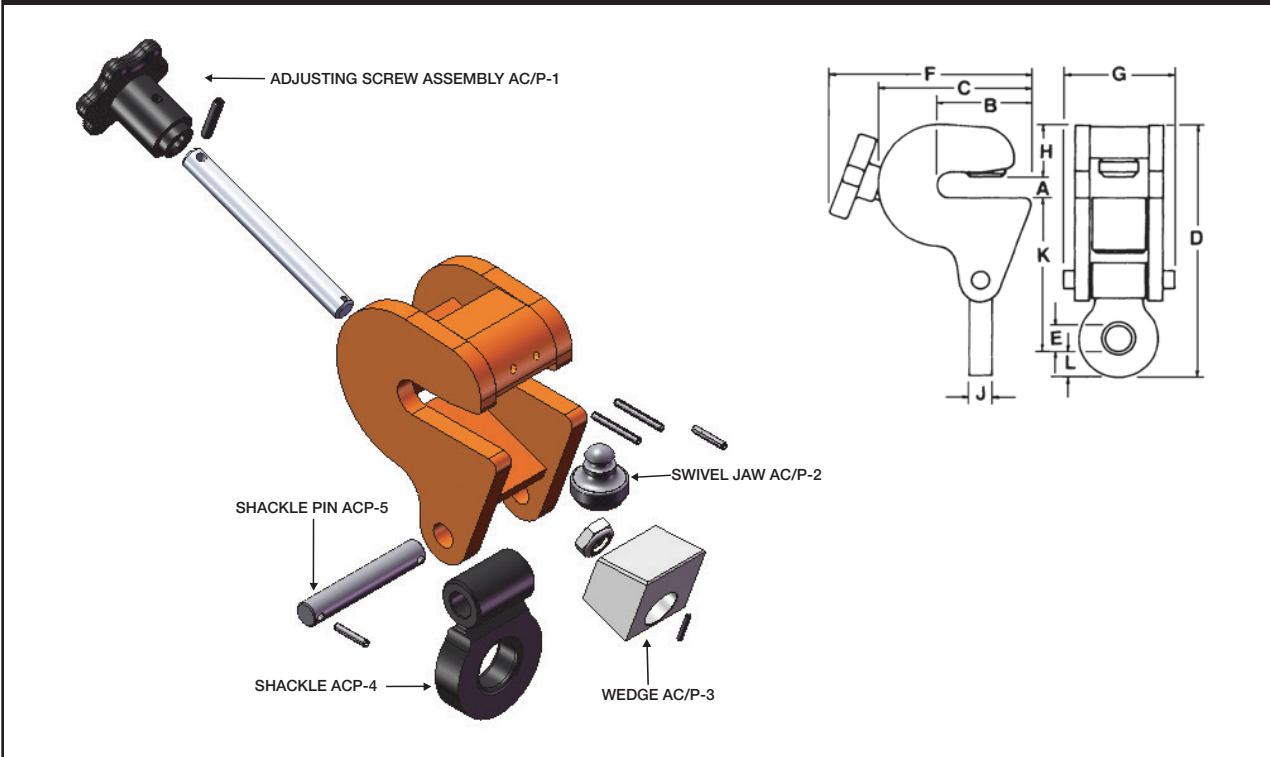

SPECIFICATIONS (in inches)

Rated Capacity Tons	Flange Width A	B	C	D	E	F	G	H	J	K	L	Weight (in pounds)
2	1/4-5/8	3/4	5/4	8 ⁵ / ₁₆	1 1/4	6 3/4	3 3/4	1 13/16	3/4	5 1/2	3/4	12 1/2

SPECIFICATIONS ARE SUBJECT TO CHANGE WITHOUT NOTICE. OTHER CAPACITIES AVAILABLE UPON REQUEST.

Model B-1

Locking Type



The **Model B-1** is a portable beam clamp that provides easy suspension of hoists from beams or girders thereby eliminating the need for nuts, bolts, shackles and so on.

The **Model B-1** is intended for use on the American standard or wide flange beams. This model is furnished with a fluted tool steel locking wedge which holds the clamp in place on a beam. The Model B-1 can be used for lifting as well.

MODEL B-1 EXPLODED VIEW

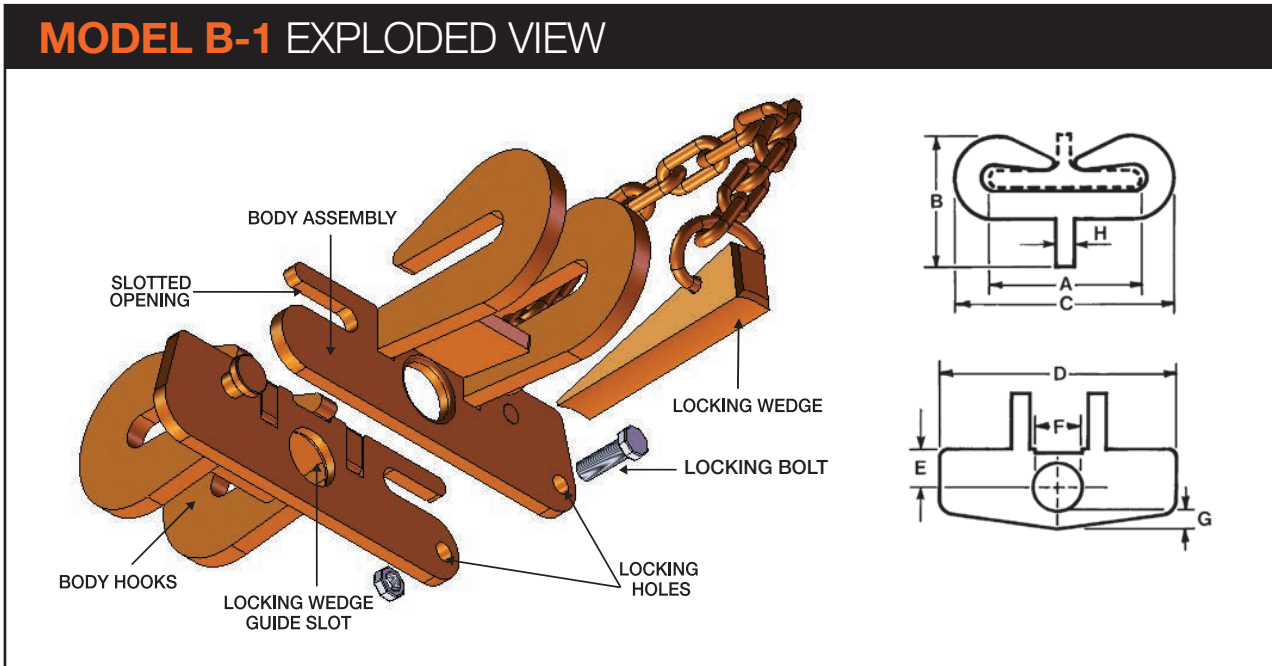

SPECIFICATIONS (in inches)

Rated Capacity Tons	Flange Width A	B	C	D	E	F	G	H	Weight (in pounds)
1	1½-4	4 ²¹ / ₃₂	6 ³ / ₄	8 ³ / ₄	1 ⁹ / ₁₆	1½	5 ⁵ / ₈	¾	12
	2-6	5¼	9½	8¾	1 ⁹ / ₁₆	1½	5 ⁵ / ₈	¾	13
	4-12	6 ³ / ₁₆	18 ⁷ / ₈	8¾	1 ⁹ / ₁₆	1½	5 ⁵ / ₈	¾	22
3	4-6	6 ¹¹ / ₁₆	10 ⁵ / ₈	11¼	2	2¼	7 ⁷ / ₈	¾	20
	4-12	7 ¹¹ / ₁₆	18 ⁵ / ₈	11¼	2	2¼	7 ⁷ / ₈	¾	38
5	4-8	9 ⁷ / ₁₆	15	14¼	3	3 ¹ / ₈	1	1	45
	4-14	9 ¹³ / ₁₆	21 ³ / ₈	14¼	3	3 ¹ / ₈	1	1	62
8	6-12	11 ⁷ / ₁₆	18 ³ / ₈	18 ⁵ / ₈	4	3½ x 4 ⁵ / ₈	1 ⁷ / ₁₆	1	96
	6-17	15 ¹ / ₈	26¼	18 ⁵ / ₈	4	3½ x 4 ⁵ / ₈	1 ⁷ / ₁₆	1	151
	6-24	15 ⁵ / ₁₆	34 ³ / ₈	18 ⁵ / ₈	4	3½ x 4 ⁵ / ₈	1 ⁷ / ₁₆	1	207
12	6-12	11 ¹⁵ / ₁₆	19 ³ / ₈	18 ⁵ / ₈	4	3½ x 4 ⁵ / ₈	1 ⁷ / ₁₆	1¼	98
	6-17	15 ⁵ / ₁₆	26 ⁷ / ₈	18 ⁵ / ₈	4	3½ x 4 ⁵ / ₈	1 ⁷ / ₁₆	1¼	153
	6-24	15 ¹³ / ₁₆	34 ⁷ / ₈	18 ⁵ / ₈	4	3½ x 4 ⁵ / ₈	1 ⁷ / ₁₆	1¼	209

SPECIFICATIONS ARE SUBJECT TO CHANGE WITHOUT NOTICE.

Model B-2 Trolley Clamp



The **Model B-2** is a beam trolley clamp that provides connection of a hoist or chain fall to an overhead beam and enables it to be moved along the beam as the necessity arises. Equipped with four heavy duty rollers, the **Model B-2**, with load attached, can be moved along any length of American Standard or wide flange beams. The fluted tool steel locking wedge permits the clamp to be temporarily or permanently locked at a particular position along the beam.

MODEL B-2 EXPLODED VIEW

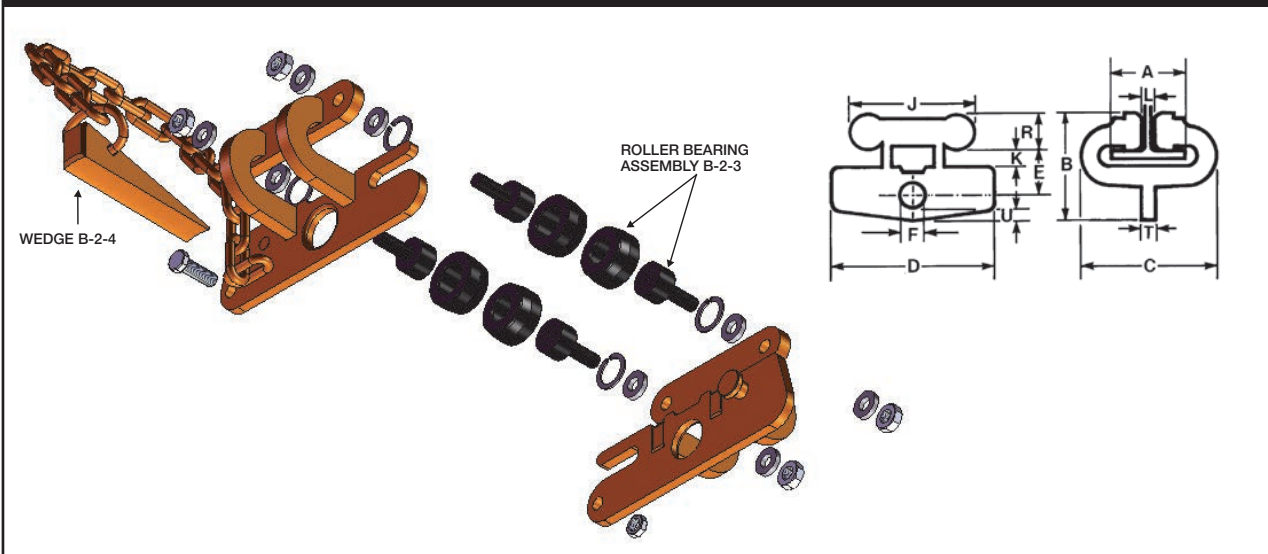

SPECIFICATIONS (in inches)

Rated Capacity Tons	Flange Width A	B	C	D	E	F	J	K	L	R	T	U	Weight (in pounds)
1	1½-4	5¾	7¼	8¾	2⅞	1½	6¾	7⁄8	5⁄8	2	¾	¾	18
	2-6	7⅝	10½	8¾	3⅜	1½	8¾	1¼	1⅞	3½	¾	¾	28
	4-12	8⅞	18	8¾	3⅝	1½	8¾	1⅜	1⅞	3½	¾	¾	38
3	4-6	10¼	12¼	11¼	4	2¼	12¼	1¼	1½	5⅞	¾	7⁄8	65
	4-12	10⅞	19	11¼	4⅝	2¼	12¼	1⅞	1½	5⅞	¾	7⁄8	78
5	4-8	13⅞	16½	16½	5	3⅞	15½	1⅞	1½	6	1	1	92
	4-14	13⅞	22½	16½	5	3⅞	15½	1⅞	1½	6	1	1	130
8	6-12	18⅞	21⅞	18⅝	6½	3½ x 4⅝	21	2½	1½	8	1	1⅞	256
	6-17	18⅞	27	18⅝	6½	3½ x 4⅝	21	2½	1½	8	1	1⅞	332
	6-24	18⅞	35	18⅝	6½	3½ x 4⅝	21	2½	1½	8	1	1⅞	355
12	6-12	18⅞	22½	18⅝	6½	3½ x 4⅝	21	2½	1½	8	1¼	1⅞	275
	6-17	18⅞	28½	18⅝	6½	3½ x 4⅝	21	2½	1½	8	1¼	1⅞	295
	6-24	18⅞	36½	18⅝	6½	3½ x 4⅝	21	2½	1½	8	1¼	1⅞	345

SPECIFICATIONS ARE SUBJECT TO CHANGE WITHOUT NOTICE.



Model BC

Locking Type

The **Model BC** is a multi-purpose beam clamp suitable for both lifting beams or providing suspension of hoists from beams or girders, thereby eliminating the need for nuts, bolts and shackles. It is intended for use on the American standard or wide flange beams.



OPTION: Now available with soft jaw inserts. Factory installed at time of order or as a Retrofit Kit for customer installation

MODEL BC EXPLODED VIEW

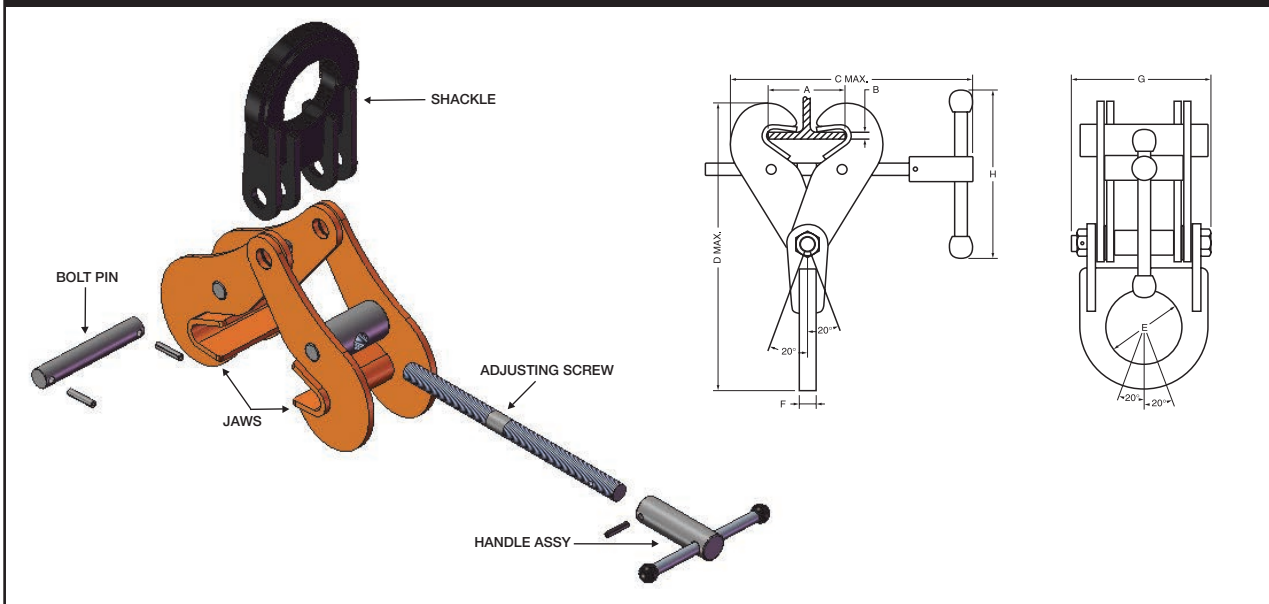

SPECIFICATIONS (in inches)

Working Load Limit at 0°- 20° Vertical Tons	Flange Width A	Flange Thickness B	C	D	E	F	G	H	Weight (in pounds)
1½	3-7¼	¼-½	117/8	11¾	3	½	5	5¾	9½
3	3-7¼	¼-½	117/8	12	3	5/8	5¾/16	6¾	13½
5	6-9½	½-¾	17	147/8	3¼	¾	65/16	6¾	22½
10	6-11⅞	½- 1¼	21¼	19⅞	4	1½	7⅞	9	53
15	8-16¾	7/8-2	32	26 ½	4 ½	1¾	8¾/8	12	120
25	18-38	2-3	61	40 ½	5	2	15	15	450

SPECIFICATIONS ARE SUBJECT TO CHANGE WITHOUT NOTICE.

PULL





Model PCK-SL

Locking, Screw Type

The **PCK** Locking Screw Clamp is a versatile multi-purpose lifting turning pulling clamp capable of lift and turn operations from the horizontal through 180 degrees arc. The clamp can also be used for the assembling of steel plates, structural members and welded sections. The clamp is generally used in pairs for the purpose of drawing two plates or members together or to a predetermined position adjacent to each other. The adjusting screw is used to accommodate various thicknesses of material and to facilitate the attachment of the clamp to the member being worked on.

MODEL PCK-SL EXPLODED VIEW

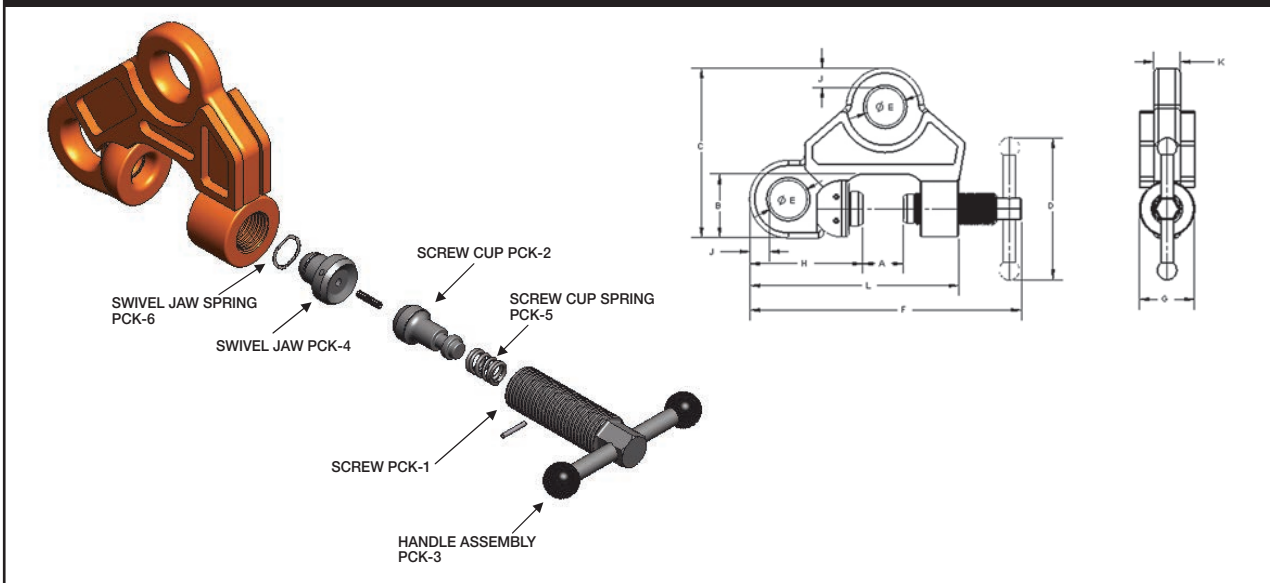

SPECIFICATIONS (in inches)

Capacity Tons	Plate Thickness A	B	C	D	E	F	G	H	J	K	L	Weight (in pounds)
1/2	0-1	2½	5½	5 ¹¹ / ₁₆	1	9½	1¾	3	1/2	5 ⁵ / ₁₆	6½	4.6
1	0-1½	3	6¾	5 ¹¹ / ₁₆	1¾	10½	2½	4 ¹ / ₃₂	1 ¹¹ / ₁₆	¾	7 ⁵ / ₈	9.6
2	0-1½	3 ³ / ₁₆	7½	7	1½	11½	2 ³ / ₈	4 ⁹ / ₁₆	¾	1	8½	14.5
3	¾-1¾	3½	8	6 ¹¹ / ₁₆	1¾	12½	2 ⁵ / ₈	5 ³ / ₈	7 ⁷ / ₈	1½	9½	17.9
5	0-1½	3 ¹³ / ₁₆	9 ⁵ / ₁₆	7 ³ / ₈	2	13 ³ / ₈	2 ⁷ / ₈	5 ⁷ / ₈	1	1 ³ / ₈	10	28.4

SPECIFICATIONS ARE SUBJECT TO CHANGE WITHOUT NOTICE.

NON-MARRING





Model NM

Locking, Screw Type

The **Model NM** clamp (non-marring) is manufactured with smooth gripping surfaces to prevent marring when gripping stainless steel, copper, aluminum and other polished metal plates. Due to the variety of conditions that may exist in handling these plates, it is recommended that these clamps be used in pairs and attached to a chain or wire rope sling, supported by a spreader beam. The **Model NM** is supplied with stainless steel gripping surfaces and is available with steel or bronze upon request. The **Model NM** is not intended for use in transportation of plates using mobile equipment where shocking of the load may occur.

MODEL NM EXPLODED VIEW

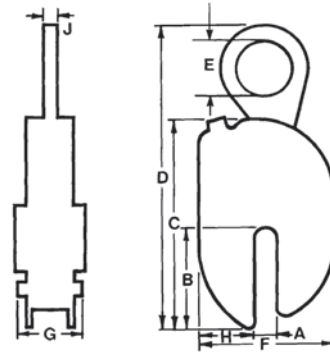
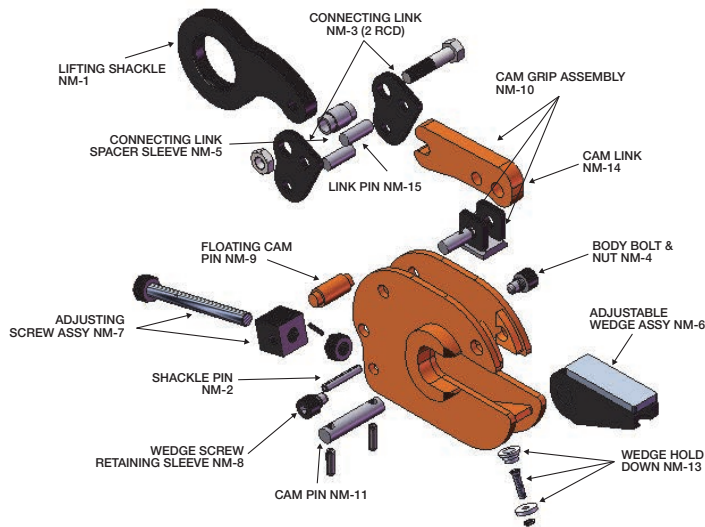

SPECIFICATIONS (in inches)

Rate Capacity Tons per Clamp	Plate Thickness A	B	C	MAX. D	E	F	G	H	J	Weight (in pounds)
1	0- $\frac{3}{4}$	4 $\frac{1}{2}$	9 $\frac{3}{8}$	15 $\frac{3}{8}$	2 $\frac{1}{8}$	5 $\frac{1}{8}$	3 $\frac{1}{8}$	2 $\frac{3}{8}$	$\frac{5}{8}$	17
	$\frac{3}{4}$ -1 $\frac{1}{4}$	4 $\frac{1}{2}$	9 $\frac{3}{8}$	15 $\frac{3}{8}$	2 $\frac{1}{8}$	6 $\frac{1}{8}$	3 $\frac{1}{8}$	2 $\frac{3}{8}$	$\frac{5}{8}$	19
	1 $\frac{1}{4}$ -1 $\frac{3}{4}$	4 $\frac{1}{2}$	9 $\frac{3}{8}$	15 $\frac{3}{8}$	2 $\frac{1}{8}$	6 $\frac{3}{8}$	3 $\frac{1}{8}$	2 $\frac{3}{8}$	$\frac{5}{8}$	21
	1 $\frac{3}{4}$ -2 $\frac{1}{4}$	4 $\frac{1}{2}$	9 $\frac{3}{8}$	15 $\frac{3}{8}$	2 $\frac{1}{8}$	7 $\frac{1}{8}$	3 $\frac{1}{8}$	2 $\frac{3}{8}$	$\frac{5}{8}$	23
2	0-15	5 $\frac{1}{8}$	10 $\frac{1}{16}$	16	2 $\frac{5}{8}$	6 $\frac{3}{4}$	3 $\frac{3}{8}$	2 $\frac{7}{8}$	$\frac{5}{8}$	23
	$\frac{3}{4}$ -1 $\frac{1}{2}$	5 $\frac{1}{8}$	10 $\frac{1}{16}$	16	2 $\frac{5}{8}$	7 $\frac{1}{4}$	3 $\frac{3}{8}$	2 $\frac{7}{8}$	$\frac{5}{8}$	27
	1 $\frac{1}{4}$ -2	5 $\frac{1}{8}$	10 $\frac{1}{16}$	16	2 $\frac{5}{8}$	7 $\frac{3}{4}$	3 $\frac{3}{8}$	2 $\frac{7}{8}$	$\frac{5}{8}$	28
	1 $\frac{3}{4}$ -2 $\frac{1}{2}$	5 $\frac{1}{8}$	10 $\frac{1}{16}$	16	2 $\frac{5}{8}$	8 $\frac{1}{4}$	3 $\frac{3}{8}$	2 $\frac{7}{8}$	$\frac{5}{8}$	30
	2 $\frac{1}{4}$ -3	5 $\frac{1}{8}$	10 $\frac{1}{16}$	16	2 $\frac{5}{8}$	8 $\frac{3}{4}$	3 $\frac{3}{8}$	2 $\frac{7}{8}$	$\frac{5}{8}$	33
4	$\frac{1}{4}$ -1 $\frac{1}{2}$	5 $\frac{3}{8}$	12 $\frac{1}{8}$	18 $\frac{9}{16}$	2 $\frac{15}{16}$	7 $\frac{3}{4}$	4 $\frac{1}{2}$	2 $\frac{15}{16}$	1	45
	1 $\frac{1}{4}$ -2 $\frac{1}{2}$	5 $\frac{3}{8}$	12 $\frac{1}{8}$	18 $\frac{9}{16}$	2 $\frac{15}{16}$	8 $\frac{1}{4}$	4 $\frac{1}{2}$	2 $\frac{15}{16}$	1	48
	1 $\frac{3}{4}$ -3	5 $\frac{3}{8}$	12 $\frac{1}{8}$	18 $\frac{9}{16}$	2 $\frac{15}{16}$	9 $\frac{1}{4}$	4 $\frac{1}{2}$	2 $\frac{15}{16}$	1	50
	3-4 $\frac{1}{4}$	5 $\frac{3}{8}$	12 $\frac{1}{8}$	18 $\frac{9}{16}$	2 $\frac{15}{16}$	11	4 $\frac{1}{2}$	2 $\frac{15}{16}$	1	55
8	1 $\frac{1}{2}$ -3 $\frac{1}{4}$	11	20 $\frac{1}{4}$	27 $\frac{3}{4}$	3 $\frac{3}{8}$	15 $\frac{3}{8}$	6 $\frac{3}{8}$	5 $\frac{7}{8}$	2	193
	1 $\frac{3}{4}$ -3 $\frac{1}{2}$	11	20 $\frac{1}{4}$	27 $\frac{3}{4}$	3 $\frac{3}{8}$	15 $\frac{3}{8}$	6 $\frac{3}{8}$	5 $\frac{7}{8}$	2	195
	3-4 $\frac{1}{2}$	11	20 $\frac{1}{4}$	27 $\frac{3}{4}$	3 $\frac{3}{8}$	16 $\frac{1}{8}$	6 $\frac{3}{8}$	5 $\frac{7}{8}$	2	210
	4-5 $\frac{1}{2}$	11	20 $\frac{1}{4}$	27 $\frac{3}{4}$	3 $\frac{3}{8}$	17 $\frac{1}{8}$	6 $\frac{3}{8}$	5 $\frac{7}{8}$	2	225
12	2-4	11	20 $\frac{1}{4}$	27 $\frac{3}{4}$	3 $\frac{3}{8}$	16 $\frac{1}{8}$	7 $\frac{1}{8}$	5 $\frac{7}{8}$	2	200
	3 $\frac{3}{4}$ -5 $\frac{1}{2}$	11	20 $\frac{1}{4}$	27 $\frac{3}{4}$	3 $\frac{3}{8}$	17 $\frac{1}{8}$	7 $\frac{1}{8}$	5 $\frac{7}{8}$	2	220
	4 $\frac{1}{2}$ -6	11	20 $\frac{1}{4}$	27 $\frac{3}{4}$	3 $\frac{3}{8}$	18 $\frac{1}{8}$	7 $\frac{1}{8}$	5 $\frac{7}{8}$	2	240

SPECIFICATIONS ARE SUBJECT TO CHANGE WITHOUT NOTICE

Model NMA

Locking Type



The **Model NMA** is a non-marring clamp with smooth gripping pads that can lift hard surface materials. Materials with sensitive finishes such as stainless steel, copper, aluminum and polished metal plates can also be lifted. The clamp incorporates a locking feature which enables the clamp gripping jaws to be “Locked Open” for attaching and removing the clamp from the material being lifted and to be “Locked Closed” for turning material through 180 degrees. It is recommended these clamps be used in pairs.

MODEL NMA EXPLODED VIEW

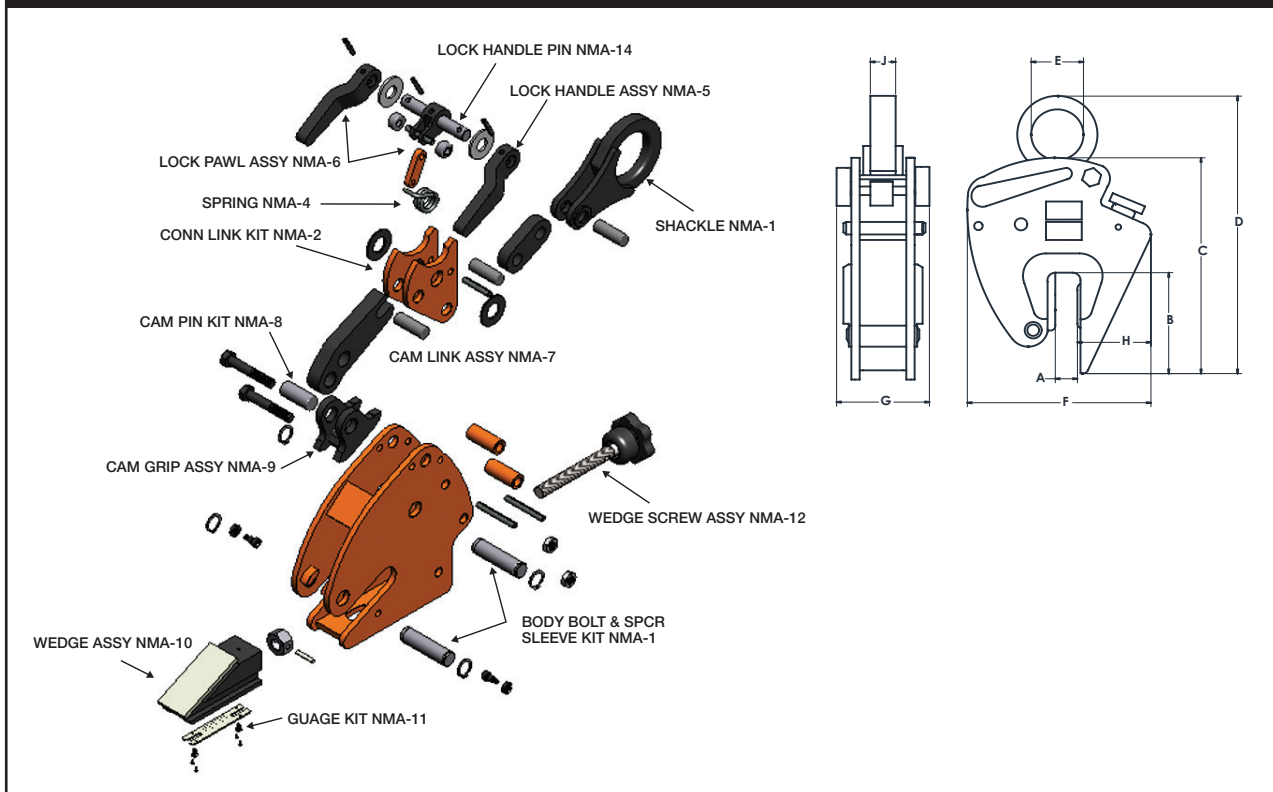

SPECIFICATIONS (in inches)

Rate Capacity Tons per Clamp	Plate Thickness A	B	C	D	E	MAX. F	G	H	J	Weight (in pounds)
1/2	0 - 1/2	3 7/16	7 26/32	12 1/16	2	7 1/4	4 1/4	2 15/16	1/2	16
1	0 - 3/4	4 3/4	11 3/8	16 13/16	2 5/8	9 5/8	5 1/16	4 5/8	5/8	27
2	0 - 1	5 1/2	12 7/8	20 1/8	3	11 1/2	6	4 15/32	3/4	53
4	1/4 - 1 1/4	6 31/32	14 7/16	22 1/4	3 5/8	11 11/16	6	4 7/8	1	63 1/2
4	1 - 2	6 31/32	14 7/16	22 1/4	3 5/8	12 13/16	6	4 7/8	1	65 1/2

Larger capacities available on request. SPECIFICATIONS ARE SUBJECT TO CHANGE WITHOUT NOTICE.

NON-MARRING



Model NMBL

Locking Type

The **NMBL** model is used to turn plates from the horizontal through a 180 degree arc. It is manufactured with smooth gripping surfaces to prevent marring when gripping stainless steel, copper, aluminum and other polished metal plates. The NMBL incorporates a lock open – lock closed feature to facilitate attaching and removing the clamp from the plate.

Recommended for use in pairs.

MODEL NMBL EXPLODED VIEW

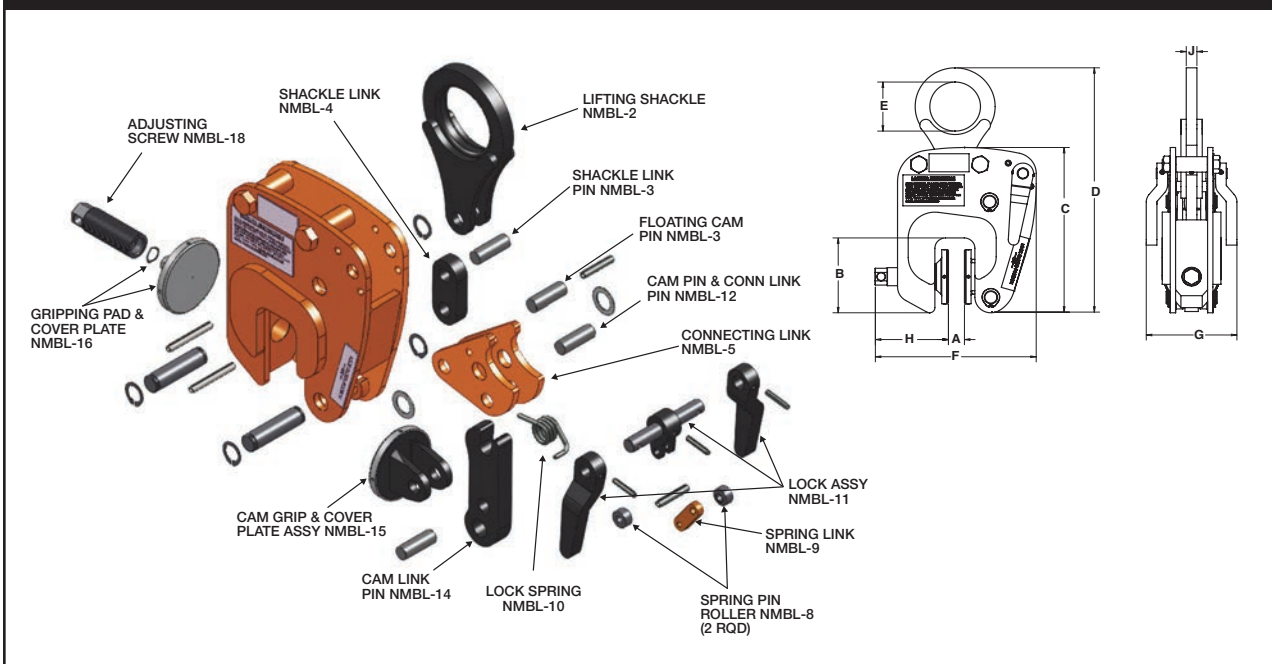

NON-MARRING

SPECIFICATIONS (in inches)

Rated Capacity Tons per Clamp	Plate Thickness A	B	C	D	E	MAX. F	G	H	J	Weight (in pounds)
1/2	0-5/8	3 5/8	8	12 5/16	2 3/8	7 5/8	4 1/4	3 7/16	1/2	15 5/8
1	0-3/4	3 5/8	8	11 7/8	2 3/8	7 9/16	4 1/4	3 7/16	1/2	17 1/4
2	0-2	4 7/8	10 7/8	17 9/16	3	12 1/32	5 1/2	5 7/16	3/4	31
4	1/4-1 1/2	7 11/64	16 3/16	23 25/32	3	6 1/4	8 1/2	8 9/64	1 1/4	126

SPECIFICATIONS ARE SUBJECT TO CHANGE WITHOUT NOTICE

Model NMRSC

Locking, Screw Type



The **Model NMRSC** is a lightweight screw clamp for bench work on steel plates of large thickness, and weighing less than 1000 lbs. Supplied with smooth gripping surfaces to prevent marring when gripping stainless steel, copper, aluminum and other polished metal plates.

Recommended for use in pairs.

MODEL NMRSC EXPLODED VIEW

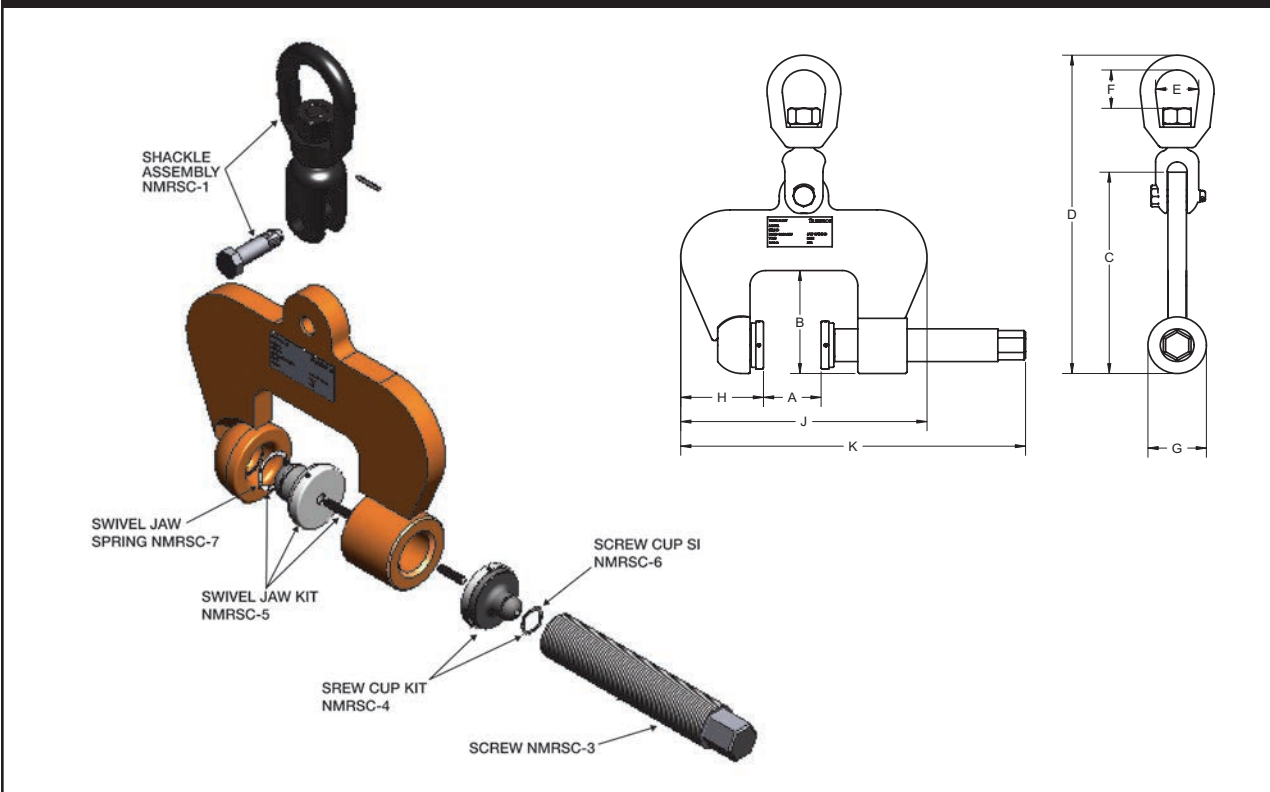

SPECIFICATIONS (in inches)

Rated Capacity Tons per Clamp	Plate Thickness A	B	C	D	E	F	G	H	J	K	Weight (in pounds)
1/2	0-3	4 ⁵ / ₁₆	8 ¹ / ₁₆	13 ³ / ₈	1 ³ / ₄	1 ⁹ / ₁₆	2 ³ / ₈	3 ³ / ₈	10	14	13 ⁷ / ₈
1/2	1 ³ / ₈ -4 ¹ / ₄	4 ⁵ / ₁₆	8 ¹ / ₁₆	13 ³ / ₈	1 ³ / ₄	1 ⁹ / ₁₆	2 ³ / ₈	3 ³ / ₈	11 ³ / ₁₆	15 ¹⁵ / ₁₆	14 ¹ / ₂

SPECIFICATIONS ARE SUBJECT TO CHANGE WITHOUT NOTICE.