

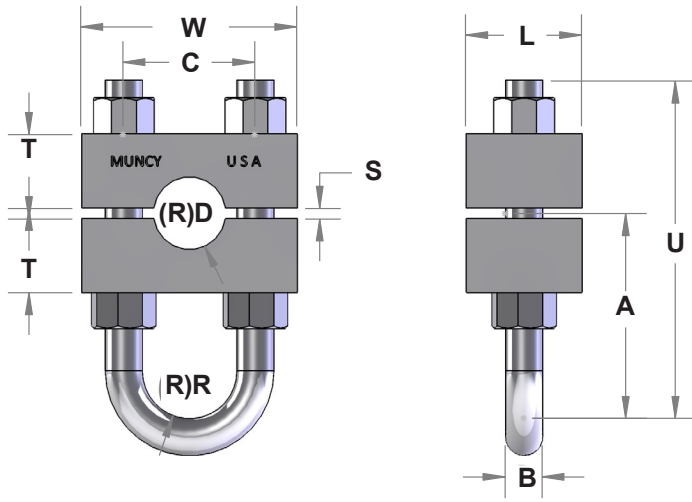

Cable Clamps



- ✓ Manufactured for wire rope and strand .
- ✓ Clamps made from high quality domestic steel .
- ✓ Call for availability . Cable clamps are primarily made to order .

Cable Dia	Part Number	Dimensions										Est. Wt
		A	B	C	D	R	S	T	U	W	L	
1/2	CC-16	2.38	0.50	1.50	0.59	0.50	0.19	0.63	4.00	2.63	1.75	2
5/8	CC-20	2.75	0.50	1.63	0.72	0.56	0.19	0.75	4.63	3.00	1.88	3
3/4	CC-24	3.50	0.63	2.00	0.84	0.69	0.19	1.00	5.50	3.50	2.00	4.5
7/8	CC-28	3.50	0.63	2.00	0.97	0.69	0.19	1.00	5.50	3.50	2.00	4.5
1	CC-32	3.63	0.75	2.25	1.09	0.75	0.19	1.25	6.00	4.00	2.25	7.5
1-1/8	CC-36	3.63	0.75	2.25	1.22	0.75	0.19	1.25	6.00	4.00	2.25	7.5
1-1/4	CC-40	4.00	0.75	2.63	1.34	0.94	0.25	1.50	6.75	4.38	2.50	10
1-3/8	CC-44	4.00	0.75	2.63	1.47	0.94	0.25	1.50	6.75	4.38	2.50	10
1-1/2	CC-48	4.75	0.88	3.13	1.59	1.13	0.25	1.75	8.00	5.13	2.75	15
1-5/8	CC-52	4.75	0.88	3.13	1.72	1.13	0.25	1.75	8.00	5.13	2.75	15
1-3/4	CC-56	5.25	1.00	3.50	1.84	1.25	0.25	2.00	8.88	6.00	3.00	25
1-7/8	CC-60	5.25	1.00	3.50	1.97	1.25	0.25	2.00	8.88	6.00	3.00	25
2	CC-64	5.88	1.13	4.00	2.09	1.44	0.31	2.25	10.00	6.50	3.25	30
2-1/8	CC-68	5.88	1.13	4.00	2.22	1.44	0.31	2.25	10.00	6.50	3.25	30
2-1/4	CC-72	6.50	1.25	4.50	2.34	1.63	0.38	2.50	11.13	7.25	3.50	43
2-3/8	CC-76	6.50	1.25	4.50	2.47	1.63	0.38	2.50	11.13	7.25	3.50	43
2-1/2	CC-80	7.25	1.25	5.00	2.59	1.88	0.38	2.75	12.25	7.75	4.00	53
2-5/8	CC-84	7.25	1.25	5.00	2.72	1.88	0.38	2.75	12.25	7.75	4.00	53
2-3/4	CC-88	8.00	1.38	5.25	2.84	1.94	0.38	3.00	13.25	8.50	4.50	72
2-7/8	CC-92	8.00	1.38	5.25	2.97	1.94	0.38	3.00	13.25	8.50	4.50	72
3	CC-96	8.50	1.50	5.50	3.09	2.00	0.38	3.25	14.25	9.00	5.00	92

CAUTION

Use designated wire rope size. Do not overload or three-way load.

